

Inductive Sensors



Housing Style	Part Number	ID Number	Features	Sensing Range (mm)	Output
18 mm - Nonembeddable, Partial Threading, Potted-In Cable 	Ni 8-M18-AD4X	T4411200		8	2-Wire DC
	Ni14-M18-AD4X	T4417235	<i>Extended Range</i>	14	
	Ni12U-M18-AN6X	M1645120	<i>Uprox</i>	12	3-Wire DC NPN
	Ni12U-EM18-AN6X	M1645320	<i>Uprox</i>	12	
	Ni14-M18-AN6X	T4611411	<i>Extended Range</i>	14	
	Ni 8-M18-AN6X	T4614889		8	
	Ni 8-M18-AP6X/S100	M4611201	<i>High Temp. 100°C</i>	8	3-Wire DC PNP
	Ni12U-EM18-AP6X	M1645300	<i>Uprox</i>	12	
	Ni12U-M18-AP6X	M1645100	<i>Uprox</i>	12	
	Ni14-M18-AP6X	T4611401	<i>Extended Range</i>	14	
	Ni 8-M18-AP6X	T4614395		8	
	Ni 8-M18-VN4X	T1571200	<i>Comp. Output</i>	8	4-Wire DC NPN
	Ni14-M18-VN4X	T4590600	<i>Extended Range</i>	14	
	Ni 8-M18-VP4X	T1561200	<i>Comp. Output</i>	8	4-Wire DC PNP
Ni14-M18-VP4X	T4590601	<i>Extended Range</i>	14		
	Ni12U-M18-ADZ30X2	M4282410	<i>Uprox</i>	12	2-Wire AC/DC Short-Circuit Protected
18 mm - Nonembeddable, Partial Threading, Potted-In Cable, Teflon Coated 	Ni12U-MT18-ADZ30X2	M4209420	<i>Uprox</i>	12	2-Wire AC/DC Short-Circuit Protected

Output	Switching Freq. (Hz)	Operating Current (mA)	Operating Temp. (°C)	Protection	Housing	Face	End Cap	Power LED	Output LED	Cable Length/ Cable Mat.	Wiring Diagram #	Wiring Diagrams
10-65 VDC	500	≤100	-25 to +70	IP 67	CPB	PA 12	EPTR	N/A	YE	2M/PVC	1	Diagram 1
	500	≤100	-25 to +70	IP 67	CPB	PA 12	EPTR	N/A	YE	2M/PVC	1	
10-30 VDC	2000	≤200	-30 to +85	IP 67	CPB	PA 12	EPTR	N/A	YE	2M/PVC	2	Diagram 2
	2000	≤200	-30 to +85	IP 68	SS	PA 12	EPTR	N/A	YE	2M/PVC	2	
	500	≤200	-25 to +70	IP 67	CPB	PA 12	EPTR	N/A	YE	2M/PVC	2	
	1000	≤200	-25 to +70	IP 67	CPB	PA 12	EPTR	N/A	YE	2M/PVC	2	
10-30 VDC	1000	≤200	-25 to +100	IP 67	CPB	IRPA	EPTR	N/A	YE	2M/PVC	3	Diagram 3
	2000	≤200	-30 to +85	IP 67	SS	PA 12	EPTR	N/A	YE	2M/PVC	3	
	2000	≤200	-30 to +85	IP 67	CPB	PA 12	EPTR	N/A	YE	2M/PVC	3	
	500	≤200	-25 to +70	IP 67	CPB	PA 12	EPTR	N/A	YE	2M/PVC	3	
	1000	≤200	-25 to +70	IP 67	CPB	PA 12	EPTR	N/A	YE	2M/PVC	3	
10-65 VDC	1000	≤200	-25 to +70	IP 67	CPB	PA 12	EPTR	N/A	YE	2M/PVC	4	Diagram 4
	1000	≤200	-25 to +70	IP 67	CPB	PA 12	EPTR	N/A	YE	2M/PVC	4	
10-65 VDC	1000	≤200	-25 to +70	IP 67	CPB	PA 12	EPTR	N/A	YE	2M/PVC	5	Diagram 5
	1000	≤200	-25 to +70	IP 67	CPB	PA 12	EPTR	N/A	YE	2M/PVC	5	
20-250 VAC 10-300 VDC	20	≤400/300	-30 to +85	IP 67	CPB	PA 12	EPTR	YE	RD	2M/PVC	6	Diagram 6
20-250 VAC 10-300 VDC	20	≤400/300	-30 to +85	IP 67	TC	TC	EPTR	YE	RD	2M/PVC	6	

WIRING DIAGRAM

LOCKNUT LN-M18

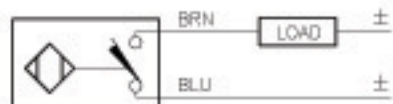

OUTPUT: AD4X

SHORT-CIRCUIT AND OVERLOAD PROTECTED

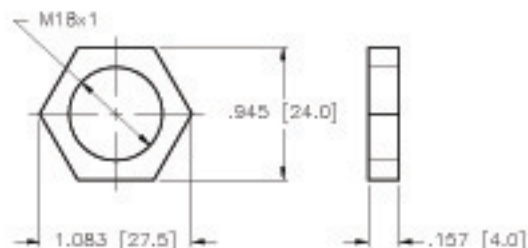

SPECIFICATIONS

OPERATING VOLTAGE	10-65 VDC
RIPPLE	≤10%
DIFFERENTIAL TRAVEL (HYSTERESIS)	3-10% (5% TYPICAL)
VOLTAGE DROP ACROSS CONDUCTING SENSOR	≤5.0 V at 100 mA
OUTPUT FUNCTION	NORMALLY OPEN 2-WIRE DC SELF-CONTAINED
TTL COMPATIBLE	NO
SHORT-CIRCUIT PROTECTED	YES
TRIGGER CURRENT FOR OVERLOAD PROTECTION	≥120 mA
MAXIMUM LOAD CURRENT	≤100 mA
MINIMUM LOAD CURRENT	≥3.0 mA
OFF-STATE (LEAKAGE) CURRENT	≤0.8 mA
TIME DELAY BEFORE AVAILABILITY	≤10 ms
POWER-ON EFFECT PROTECTION	INCORPORATED
PROTECTION AGAINST TRANSIENTS	INCORPORATED
OPERATING TEMPERATURE	-25°C to +70°C (-13°F to +158°F)
ENCLOSURE	MEETS NEMA 1, 3, 4, 6, 13 AND IEC IP67
SHOCK	30 g, 11 ms
VIBRATION	55 Hz, 1 mm AMPLITUDE (IN ALL 3 PLANES)
LED FUNCTION	YELLOW: OUTPUT ENERGIZED
SENSING RANGE	8 mm = .315" (NOMINAL)
SWITCHING FREQUENCY	500 Hz
REPEATABILITY	≤2% of RATED OPERATING DISTANCE
SHIELDED	NO

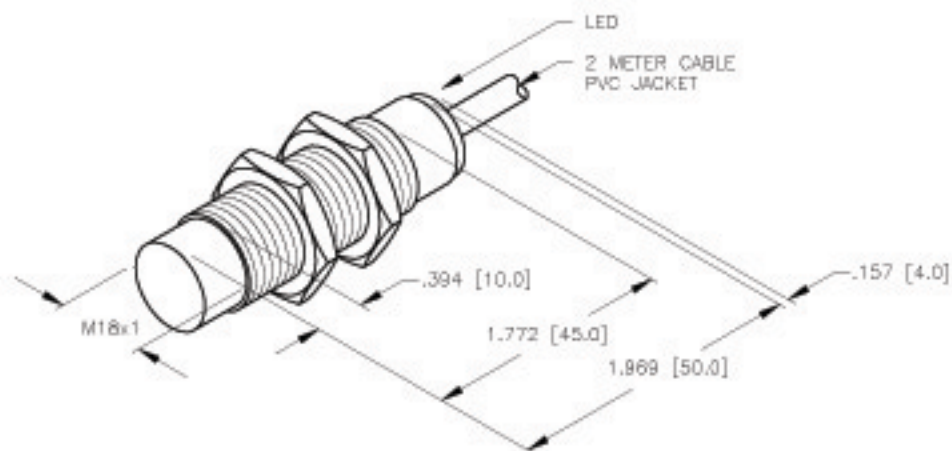

SOURCE DRAWING - FOR REFERENCE ONLY

NOTE: ALL DIMENSIONAL TOLERANCES: ±1.0mm.

RELATED DOCUMENTS 1. 2. 3. 4.	3RD ANGLE PROJECTION 	THIS DRAWING IS PROPERTY OF TURCK INC. USE OF THIS DOCUMENT WITHOUT WRITTEN PERMISSION IS PROHIBITED.		TURCK INC High Technology Sensors and Automation Controls	
	MATERIAL BRASS BARREL	TOLERANCES UNLESS OTHERWISE SPECIFIED	DRFT SNW		
FINISH COPPER NICKEL CHROME PLATING	±0.0394 in [±1.00 mm]	USDR	SCALE NONE	UNIT OF MEASUREMENT INCH [MILLIMETER]	IDENTIFICATION NO. T4411200
DO NOT SCALE THIS DRAWING					REV D
FILE: T4411200					SHEET 1 OF 1

0	CHANGE DIM 40.0MM TO 45.0MM	IK	08/29/00	T3745
REV	DESCRIPTION	BY	DATE	EDD NO.