

# Inductive Sensors



Housing Style	Part Number	ID Number	Features	Sensing Range (mm)	Output
<b>18 mm - Nonembeddable, Partial Threading, Potted-In Cable</b> 	Ni 8-M18-AD4X	T4411200		8	2-Wire DC
	Ni14-M18-AD4X	T4417235	Extended Range	14	
	Ni12U-M18-AN6X	M1645120	Uprox	12	3-Wire DC NPN
	Ni12U-EM18-AN6X	M1645320	Uprox	12	
	Ni14-M18-AN6X	T4611411	Extended Range	14	
	Ni 8-M18-AN6X	T4614889		8	
	Ni 8-M18-AP6X/S100	M4611201	High Temp. 100°C	8	3-Wire DC PNP
	Ni12U-EM18-AP6X	M1645300	Uprox	12	
	Ni12U-M18-AP6X	M1645100	Uprox	12	
	Ni14-M18-AP6X	T4611401	Extended Range	14	
	Ni 8-M18-AP6X	T4614395		8	
	Ni 8-M18-VN4X	T1571200	Comp. Output	8	4-Wire DC NPN
	Ni14-M18-VN4X	T4590600	Extended Range	14	
	Ni 8-M18-VP4X	T1561200	Comp. Output	8	4-Wire DC PNP
Ni14-M18-VP4X	T4590601	Extended Range	14		
	Ni12U-M18-ADZ30X2	M4282410	Uprox	12	2-Wire AC/DC Short-Circuit Protected
<b>18 mm - Nonembeddable, Partial Threading, Potted-In Cable, Teflon Coated</b> 	Ni12U-MT18-ADZ30X2	M4209420	Uprox	12	2-Wire AC/DC Short-Circuit Protected

Output	Switching Freq. (Hz)	Operating Current (mA)	Operating Temp. (°C)	Protection	Housing	Face	End Cap	Power LED	Output LED	Cable Length/ Cable Mat.	Wiring Diagram #	Wiring Diagrams
10-65 VDC	500	≤100	-25 to +70	IP 67	CPB	PA 12	EPTR	N/A	YE	2M/PVC	1	<b>Diagram 1</b> 
	500	≤100	-25 to +70	IP 67	CPB	PA 12	EPTR	N/A	YE	2M/PVC	1	
10-30 VDC	2000	≤200	-30 to +85	IP 67	CPB	PA 12	EPTR	N/A	YE	2M/PVC	2	<b>Diagram 2</b> 
	2000	≤200	-30 to +85	IP 68	SS	PA 12	EPTR	N/A	YE	2M/PVC	2	
	500	≤200	-25 to +70	IP 67	CPB	PA 12	EPTR	N/A	YE	2M/PVC	2	
	1000	≤200	-25 to +70	IP 67	CPB	PA 12	EPTR	N/A	YE	2M/PVC	2	
10-30 VDC	1000	≤200	-25 to +100	IP 67	CPB	IRPA	EPTR	N/A	YE	2M/PVC	3	<b>Diagram 3</b> 
	2000	≤200	-30 to +85	IP 67	SS	PA 12	EPTR	N/A	YE	2M/PVC	3	
	2000	≤200	-30 to +85	IP 67	CPB	PA 12	EPTR	N/A	YE	2M/PVC	3	
	500	≤200	-25 to +70	IP 67	CPB	PA 12	EPTR	N/A	YE	2M/PVC	3	
	1000	≤200	-25 to +70	IP 67	CPB	PA 12	EPTR	N/A	YE	2M/PVC	3	
10-65 VDC	1000	≤200	-25 to +70	IP 67	CPB	PA 12	EPTR	N/A	YE	2M/PVC	4	<b>Diagram 4</b> 
	1000	≤200	-25 to +70	IP 67	CPB	PA 12	EPTR	N/A	YE	2M/PVC	4	
10-65 VDC	1000	≤200	-25 to +70	IP 67	CPB	PA 12	EPTR	N/A	YE	2M/PVC	5	<b>Diagram 5</b> 
	1000	≤200	-25 to +70	IP 67	CPB	PA 12	EPTR	N/A	YE	2M/PVC	5	
20-250 VAC 10-300 VDC	20	≤400/300	-30 to +85	IP 67	CPB	PA 12	EPTR	YE	RD	2M/PVC	6	<b>Diagram 6</b> 
20-250 VAC 10-300 VDC	20	≤400/300	-30 to +85	IP 67	TC	TC	EPTR	YE	RD	2M/PVC	6	

WIRING DIAGRAM

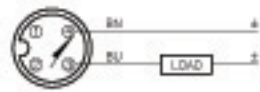

OUTPUT: AD4X

SHORT-CIRCUIT AND OVERLOAD PROTECTED

LOCKNUT LN-M18

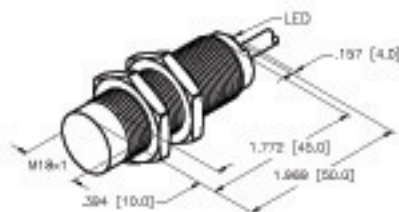
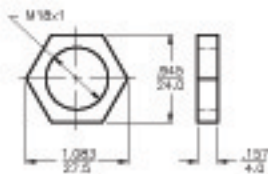

SPECIFICATIONS

OPERATING VOLTAGE	10-30 VDC
Ripple	± 10%
DIFFERENTIAL TENSIL (MINIMUM)	1-150 (SEE TYPICAL)
VOLTAGE DROP ACROSS CONDUCTING SENSOR	≤ 0.5 V at 180 mA
OUTPUT FUNCTION	NORMALLY OPEN 2-WIRE DO SELF-CONTAINED
TTL COMPATIBLE	NO
SHORT-CIRCUIT PROTECTED	YES
TRIGGER CURRENT FOR OVERLOAD PROTECTION	± 120 mA
CONTINUOUS LOAD CURRENT	≤ 100 mA
OFF-STATE (LEAKAGE) CURRENT	≤ 0.5 mA
TIME DELAY BEFORE ANNULLITY	≤ 3 ms
POWER-ON EFFECT	PER IEC 947-5-2
REVERSE POLARITY PROTECTION	INCORPORATED
PROTECTION AGAINST TRANSIENTS	PER EN 60947-5-2
OPERATING TEMPERATURE (10% DRIFT)	-20°C to +70°C (-10°F to +158°F)
ENCLOSURE	MEETS NEMA 1, 3, 4, 6, 13 AND IEC IP67
SHOCK	30 g, 11 ms
VIBRATION	20 Hz, 1 mm AMPLITUDE (IN ALL 3 PLANES)
LED FUNCTION	YELLOW OUTPUT INDICATED
RATED OPERATING DISTANCE(S)	1.4mm = .051" (TYPICAL)
SWITCHING FREQUENCY	400 Hz
REPEATABILITY	< 2% of RATED OPERATING DISTANCE
EMBEDDABLE (SHEATHED)	YES
MATING PLUG/CABLES	4-PIN "TURCK" CONSTRUCTION

SOURCE DRAWING - FOR REFERENCE ONLY

CABLE LENGTH	TOLERANCE
ALL LENGTHS	+ .45 (SEE NOTE) OF LENGTH - .05 (SEE NOTE) OF LENGTH MINIMUM 0 INCHES
STRIP LENGTH	TOLERANCE
0-1/8"	±.005
1/8-3/16"	±.005
3/16-1/4"	±.005
1/4-5/16"	±.005
5/16-3/8"	±.005
3/8-1/2"	±.005

BOARD DIMENSIONS	DO NOT SCALE THIS DRAWING	THIS DRAWING IS PROPERTY OF TURCK INC. USE OF THIS DRAWING WITHOUT WRITTEN PERMISSION IS PROHIBITED.	 High Technology Sensors and Automation Controls	
DRAWING: BRASS BARRREL PART: 100846 [1.00mm]	PART: 100846 [1.00mm]	ORT: CGM DESG:	DWT: 09/26/00 SCALE: NONE	SKETCHES: N114-M18-AD4X
FINISH: COPPER, NICKEL, O-RING PLATING	UNIT OF MEASUREMENT: MMH [ MILLIMETER ]	DESG:	DESG: 74417235	REV: 1
DWG NO: 100846	DWG NO: 100846	DWG NO: 100846	DWG NO: 100846	DWG NO: 100846