



3 FLANGE P C B MOUNTED POWER TRANSFORMERS

FEATURES

- 130°C Insulation System
- 2,500V RMS Hi-pot
- Dual Secondaries for Parallel or Series Connection
- Split Bobbin Construction with Center Flange Barrier Provides High Isolation, Low Leakage & Low Capacitance

FILE#
110331



130B



115 and 115/230V 50/60 Hz Primary Types

| Part Number | | | | VA Size | Secondary RMS Ratings | |
|-------------|----------------|-----------------|----------------|---------|-----------------------|--------------|
| Thordarson | Meissner | Thordarson Inc. | | | Series | Parallel |
| Single 115V | Dual 115V/230V | Single 115V | Dual 115V/230V | | | |
| MIM321 | MIM320 | 3FS-210-T3 | FD-210-T | 1.1 | 10V CT @ 10MA | 5V @ 220MA |
| MIM323 | MIM322 | 3FS-212-T3 | FD-212-T | 1.1 | 12.6V CT @ 90MA | 6.3V @ 180MA |
| MIM325 | MIM324 | 3FS-216-T3 | FD-216-T | 1.1 | 16V CT @ 70MA | 8V @ 140MA |
| MIM327 | MIM326 | 3FS-220-T3 | FD-220-T | 1.1 | 20V CT @ 55MA | 10V @ 110MA |
| MIM329 | MIM328 | 3FS-224-T3 | FD-224-T | 1.1 | 24V CT @ 45MA | 12V @ 90MA |
| MIM331 | MIM330 | 3FS-228-T3 | FD-228-T | 1.1 | 28V CT @ 40MA | 14V @ 80MA |
| MIM333 | MIM332 | 3FS-236-T3 | FD-236-T | 1.1 | 36V CT @ 30MA | 18V @ 60MA |
| MIM335 | MIM334 | 3FS-248-T3 | FD-248-T | 1.1 | 48V CT @ 23MA | 24V @ 46MA |
| MIM337 | MIM336 | 3FS-256-T3 | FD-256-T | 1.1 | 56V CT @ 20MA | 28V @ 40MA |
| MIM339 | MIM338 | 3FS-210-T2 | 3FD-210-T | 1.1 | 120V CT @ 10MA | 60V @ 20MA |
| MIM421 | MIM420 | 3FS-310-T3 | FD-310-T | 2.4 | 10V CT @250MA | 5V @ 500MA |
| MIM423 | MIM422 | 3FS-312-T3 | FD-312-T | 2.4 | 12.6V CT @200MA | 6.3V @400MA |
| MIM425 | MIM424 | 3FS-316-T3 | FD-316-T | 2.4 | 16V CT @150MA | 8V @ 300MA |
| MIM427 | MIM426 | 3FS-320-T3 | FD-320-T | 2.4 | 20V CT @120MA | 10V @ 240MA |
| MIM429 | MIM428 | 3FS-324-T3 | FD-324-T | 2.4 | 24V CT @100MA | 12V @ 200MA |
| MIM431 | MIM430 | 3FS-328-T3 | FD-328-T | 2.4 | 28V CT @ 85MA | 14V @ 170MA |
| MIM433 | MIM432 | 3FS-336-T3 | FD-336-T | 2.4 | 36V CT @ 65MA | 18V @ 130MA |
| MIM435 | MIM434 | 3FS-348-T3 | FD-348-T | 2.4 | 48V CT @ 50MA | 24V @ 100MA |
| MIM437 | MIM436 | 3FS-356-T3 | FD-356-T | 2.4 | 56V CT @ 45MA | 28V @ 90MA |
| MIM439 | MIM438 | 3FS-3120-T | 3FD-3120-T | 2.4 | 120V CT @ 20MA | 60V @ 40MA |
| MIM521 | MIM520 | 3FS-410-T3 | FD-410-T | 6 | 10V CT @600MA | 5V @ 1.2A |
| MIM523 | MIM522 | 3FS-412-T3 | FD-412-T | 6 | 12.6V CT @500MA | 6.3V @ 1.0A |
| MIM525 | MIM524 | 3FS-416-T3 | FD-416-T | 6 | 16V CT @400MA | 8V @ 800MA |
| MIM527 | MIM526 | 3FS-420-T3 | FD-420-T | 6 | 20V CT @300MA | 10V @ 600MA |
| MIM529 | MIM528 | 3FS-424-T3 | FD-424-T | 6 | 24V CT @250MA | 12V @ 500MA |
| MIM531 | MIM530 | 3FS-428-T3 | FD-428-T | 6 | 28V CT @200MA | 14V @ 400MA |
| MIM533 | MIM532 | 3FS-436-T3 | FD-436-T | 6 | 36V CT @170MA | 18V @ 340MA |
| MIM535 | MIM534 | 3FS-448-T3 | FD-448-T | 6 | 48V CT @125MA | 24V @ 250MA |
| MIM537 | MIM536 | 3FS-456-T3 | FD-456-T | 6 | 56V CT @110MA | 28V @ 220MA |
| MIM539 | MIM538 | 3FS-4120-T | 3FD-4120-T | 6 | 120V CT @ 50MA | 60V @ 100MA |
| MIM621 | MIM620 | 3FS-510-T3 | FD-510-T | 12 | 10V CT @ 1.2A | 5V @ 2.4A |
| MIM623 | MIM622 | 3FS-512-T3 | FD-512-T | 12 | 12.6V CT @ 1.0A | 6.3V @ 2.0A |
| MIM625 | MIM624 | 3FS-516-T3 | FD-516-T | 12 | 16V CT @800MA | 8V @ 1.6A |
| MIM627 | MIM626 | 3FS-520-T3 | FD-520-T | 12 | 20V CT @600MA | 10V @ 1.2A |
| MIM629 | MIM628 | 3FS-524-T3 | FD-524-T | 12 | 24V CT @500MA | 12V @ 1.0A |
| MIM631 | MIM630 | 3FS-528-T3 | FD-528-T | 12 | 28V CT @420MA | 14V @ 840MA |
| MIM633 | MIM632 | 3FS-536-T3 | FD-536-T | 12 | 36V CT @350MA | 18V @ 700MA |
| MIM635 | MIM634 | 3FS-548-T3 | FD-548-T | 12 | 48V CT @250MA | 24V @ 500MA |
| MIM637 | MIM636 | 3FS-556-T3 | FD-556-T | 12 | 56V CT @220MA | 28V @ 440MA |
| MIM639 | MIM638 | 3FS-5120-T | 3FD-5120-T | 12 | 120V CT @100MA | 60V @ 200MA |
| MIM720 | MIM721 | N-A | N-A | 20 | 10V CT @ 2.0A | 5V @ 4.0A |
| MIM722 | MIM723 | N-A | N-A | 20 | 12.6V CT @ 1.6A | 6.3V @ 3.2A |
| MIM724 | MIM725 | N-A | N-A | 20 | 16V CT @ 1.25A | 8V @ 2.5A |
| MIM726 | MIM727 | N-A | N-A | 20 | 20V CT @ 1.0A | 10V @ 2.0A |
| MIM728 | MIM729 | N-A | N-A | 20 | 24V CT @800MA | 12V @ 1.6A |
| MIM730 | MIM731 | N-A | N-A | 20 | 28V CT @700MA | 14V @ 1.4A |
| MIM732 | MIM733 | N-A | N-A | 20 | 36V CT @550MA | 18V @ 1.1A |
| MIM734 | MIM735 | N-A | N-A | 20 | 48V CT @400MA | 24V @ 800MA |
| MIM736 | MIM737 | N-A | N-A | 20 | 56V CT @350MA | 28V @ 700MA |
| MIM738 | MIM739 | N-A | N-A | 20 | 120V CT @160MA | 60V @ 320MA |
| MIM820 | MIM821 | N-A | N-A | 36 | 10V CT @ 3.6A | 5V @ 7.20A |
| MIM822 | MIM823 | N-A | N-A | 36 | 12.6V CT @ 2.85A | 6.3V @ 5.7A |
| MIM824 | MIM825 | N-A | N-A | 36 | 16V CT @ 2.25A | 8V @ 4.5A |
| MIM826 | MIM827 | N-A | N-A | 36 | 20V CT @ 1.8A | 10V @ 3.6A |
| MIM828 | MIM829 | N-A | N-A | 36 | 24V CT @ 1.5A | 12V @ 3.0A |
| MIM830 | MIM831 | N-A | N-A | 36 | 28V CT @ 1.3A | 14V @ 2.6A |
| MIM832 | MIM833 | N-A | N-A | 36 | 36V CT @ 1.0A | 18V @ 2.0A |
| MIM834 | MIM835 | N-A | N-A | 36 | 48V CT @750MA | 24V @ 1.5A |
| MIM836 | MIM837 | N-A | N-A | 36 | 56V CT @650MA | 28V @ 1.3A |
| MIM838 | MIM839 | N-A | N-A | 36 | 120V CT @300MA | 60V @ 600MA |

Dimensions in inches(mm)

| MIM P/N Size | VA Size | Case | | | MTG MW | A | B | C | WT. lbs. |
|--------------|---------|-------|-------|-------|--------|-------|------|------|----------|
| | | H | L | W | | | | | |
| 3XX | 1.1 | .938 | 1.375 | 1.125 | — | 1.200 | .250 | .250 | .17 |
| 4XX | 2.4 | 1.188 | 1.375 | 1.125 | — | 1.200 | .250 | .250 | .25 |
| 5XX | 6 | 1.313 | 1.625 | 1.312 | 1.062 | 1.280 | .250 | .350 | .44 |
| 6XX | 12 | 1.438 | 1.875 | 1.562 | 1.250 | 1.410 | .300 | .400 | .70 |
| 7XX | 20 | 1.438 | 2.250 | 1.875 | 1.500 | 1.600 | .300 | .400 | .80 |
| 8XX | 36 | 1.563 | 2.625 | 2.187 | # | 1.850 | .400 | .400 | 1.10 |

4 MTG holes 5/32 on 2-3/16 x 1-3/4 centers

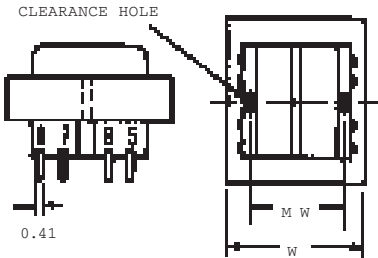
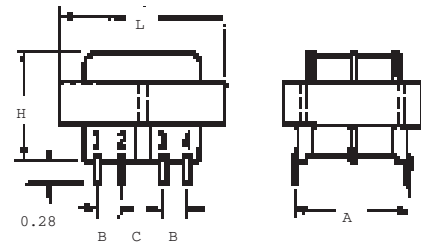

For Single Primary

For Dual Primary

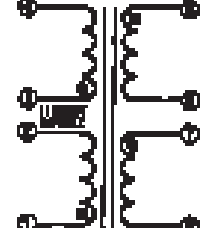
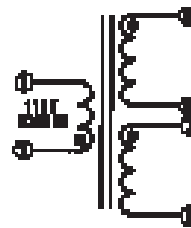

Basic 6 Pin
Single 115V

Basic 8 Pin
Dual 115/230V

■ Polarity

Dual Primary Transformers are designed for both primaries to be in series or parallel. Do not use as individual windings.