



Sunbrite Product Gallery

COMPLETE SOLID STATE, ENERGY EFFICIENT LIGHTING SOLUTIONS

10mm (0.35") Single LED, Miniature Bayonet (BA9S) Base

Applications

- Incandescent Replacements
- Indicator Lights

Features/Benefits

- Large Range of Voltages Available
- Bayonet and Screw Bases Available
- Different Sized Bases Available
- Other Colors Available
- Reverse Polarity Available
- 2 Chips, Wider View Angle



[Product Gallery](#) > [Filament Lamp Replacements](#) > [10mm \(0.35"\) Single LED, Miniature Bayonet \(BA9S\) Base](#)

Part Numbers:	Emitted Color	Wavelength (nm)	Material	Unit LED Intensity mCD per die @ 20mA (If)(Typical)	Fwd. Voltage	Standard Common Pin
SSP-D29B9SIC-12V	Super Intensity Red	636	2500	12	BA9S	1816, 181
SSP-D29B9SIC-28V	Super Intensity Red	636	2200	28	BA9S	1843, 757
SSP-D29B9SIC-6V	Super Intensity Red	636	2600	6	BA9S	316, 755, 47
SSP-D29B9SUGC-12V	Super Pure Green	574	1000	12	BA9S	1816, 181
SSP-D29B9SUGC-28V	Super Pure Green	574	950	28	BA9S	1843, 757
SSP-D29B9SUGC-6V	Super Pure Green	562	1200	6	BA9S	316, 755, 47
SSP-D29B9SWC-28V	Super White	-	950	28	BA9S	1843, 757
SSP-D29B9SYC-12V	Super Yellow	590	1500	12	BA9S	1816, 181
SSP-D29B9SYC-28V	Super Yellow	590	380	28	BA9S	1843, 757
SSP-D29B9SYC-6V	Super Yellow	590	1700	6	BA9S	316, 755, 47

UNCONTROLLED DOCUMENT

PART NUMBER
SSP-D29B9SIC-28V

REV.

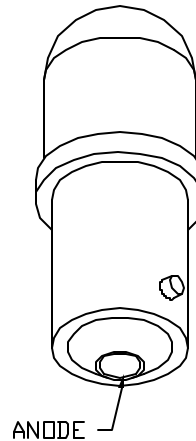
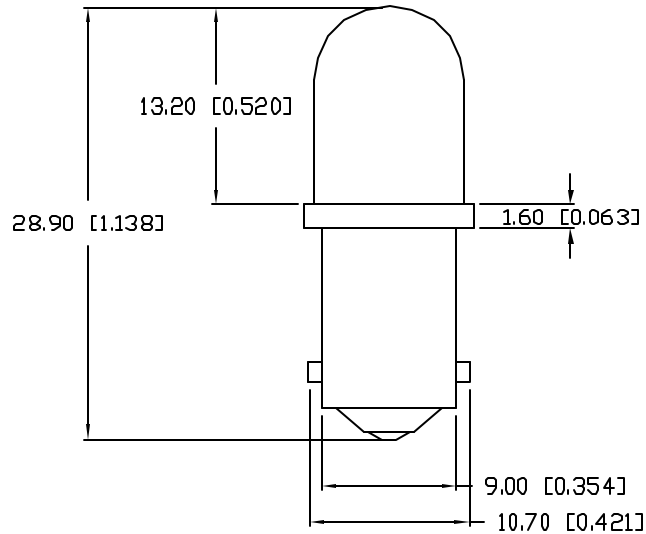
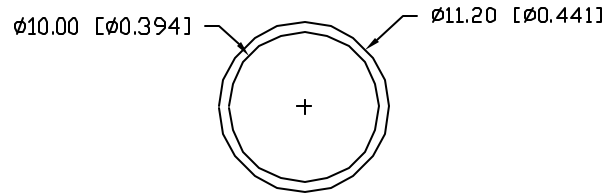

ELECTRO-OPTICAL CHARACTERISTICS $T_A=25^\circ\text{C}$ $V_f=28\text{V}$

PARAMETER	MIN	TYP	MAX	UNITS	TEST COND
PEAK WAVELENGTH		636		nm	
FORWARD VOLTAGE		28		V_f	
REVERSE VOLTAGE	5.0			V_r	$I_f=100\mu\text{A}$
AXIAL INTENSITY		2500		mcd	$V_f=28\text{V}$
VIEWING ANGLE		40		2x theta	
EMITTED COLOR:	RED				
EPOXY LENS FINISH:	WATER CLEAR				

LIMITS OF SAFE OPERATION AT 25°C

PARAMETER	MAX	UNITS
PEAK FORWARD CURRENT*	150	mA
STEADY CURRENT	30	mA
POWER DISSIPATION	150	mW
DERATE FROM 25°C	-1.2	mW/ $^\circ\text{C}$
OPERATING, STORAGE TEMP.	-40 TO +85	$^\circ\text{C}$
SOLDERING TEMP.	+260	$^\circ\text{C}$
2.0mm FROM BODY		3 SEC. MAX

* $t < 10\mu\text{s}$

*UNLESS OTHERWISE SPECIFIED TOLERANCES PER DECIMAL PRECISION ARE: X=±1 (±0.039), X.X=±0.5 (±0.020), X.XX=±0.25 (±0.010), X.XXX=±0.127 (±0.005), LEAD SIZE=±0.05 (±0.002), LEAD LENGTH=±0.75 (±0.030), MIN= ^{+DECIMAL PRECISION} -0.00 MAX= ^{+0.00} -DECIMAL PRECISION

UNCONTROLLED DOCUMENT

REV.

PART NUMBER

SSP-D29B9SIC-28V

CONFIDENTIAL INFORMATION

THE INFORMATION CONTAINED IN THIS DOCUMENT IS THE PROPERTY OF SUNBRITE LEDS. EXCEPT AS SPECIFICALLY AUTHORIZED IN WRITING BY SUNBRITE LEDS, THE HOLDER OF THIS DOCUMENT SHALL KEEP ALL INFORMATION CONTAINED HEREIN CONFIDENTIAL AND SHALL PROTECT SAME IN WHOLE OR IN PART FROM DISCLOSURE AND DISSEMINATION TO ALL THIRD PARTIES.

RELIABILITY NOTE

DUR MANY YEARS OF EXPERIENCE DATA ACCUMULATION INDICATE THAT SOLDER HEAT IS A MAJOR CAUSE OF EARLY AND FUTURE FAILURE. PLEASE PAY ATTENTION TO YOUR SOLDERING PROCESS.



10mm CIRCULAR BA9 BASE LAMP,
636nm AlInGaP RED LED, WATER CLEAR LENS.

DRAWN:
BC

CHECKED:

APPROVED:

DATE:

PAGE: 1 OF 1