

Brilliance by design

Surface Mount LED Model 902 E Series

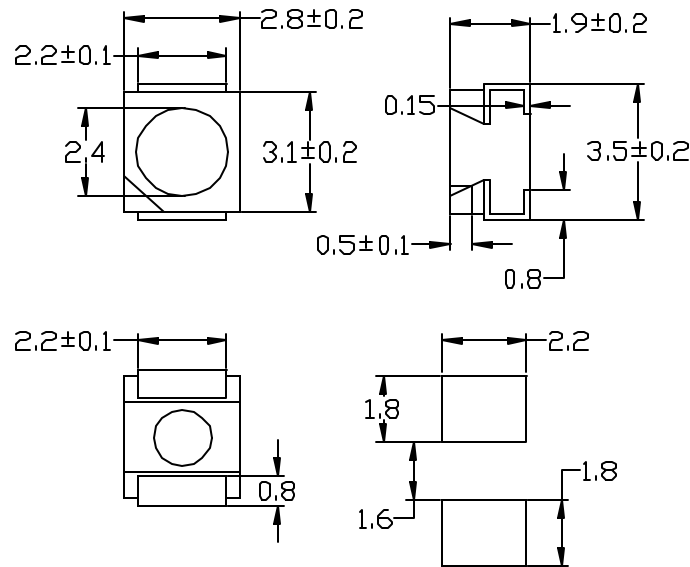

Ta=25°C

Reverse Voltage:	5 Volt
Reverse Current (Vr=5V):	10 uA
Operating Temperature Range:	-40°C - +80°C
Storage Temperature Range:	-40°C - +100°C
Lead Soldering Temperature:	260°C for 5 seconds (1.6mm(1/16inch) from body)

Ta=25°C

Part No.	Chip		Wave Length	Lens Color	View Angle (deg)	Electo-Optical Characteristics			Absolute Max Ratings		
	Raw Material	Emitted Color				Vf(V)		IV (mcd)	Pd mW	If mA	If mA (Peak)
						Typ.	Max.				
SL902WCE	InGaN/YAG	Pure White	-	Water Clear	120	3.6	4.0	150	120	30	100
SL902BCE	GaN/SiC	Blue	430	Water Clear	120	3.8	4.5	45	120	30	100
SL902GCE	AlGaInP	Green	575	Water Clear	120	2.0	2.4	53	120	30	100
SL902RCE	AlGaInP	Red	635	Water Clear	120	2.0	2.4	180	120	30	100
SL902YCE	AlGaInP	Yellow	590	Water Clear	120	2.0	2.4	180	120	30	100
SL902ACE	AlGaInP	Amber	620	Water Clear	120	2.0	2.4	190	120	30	100

Notes:

1. All Dimensions are in millimeters.
2. Tolerance is +0.25mm(0.10") unless otherwise specified.
3. Protruded resin under flange is 1.5 mm(0.059") max.
4. Lead spacing is measured where the leads emerge from the package
5. Specifications are subject to change without notice