

IEC Appliance Connector with Line Switch C14, 70°C



Description

- Panel Mount:
Snap-in version, from front side Appliance Inlet, Protection class I, Line switch 1- or 2-pole

Approvals

- UL License Number: E45115
- CSA License Number: 1406497

Characteristics

- Line switch non-illuminated or illuminated

Weblinks

[Approvals](#), [RoHS](#), [CHINA-RoHS](#), [e-Store](#), [SCHURTER-Stock-Check](#), [Distributor-Stock-Check](#), [Product Configurator](#)

Technical Data

Ratings IEC	10A / 250VAC; 50Hz
Ratings UL/CSA	15A / 250VAC; 60Hz
Dielectric Strength	> 3kVAC between L-N > 1.5kVAC between L/N-PE (1 min/50Hz)
Allowable Operation Temp.	-25 °C to 70 °C
Degree of Protection	from front side IP 20 acc. to IEC 60529
Protection Class	Suitable for appliances with protection class I acc. to IEC 61140
Panel Thickness s	Snap-in: 1/ 1.5/ 2/ 2.5/ 3 mm
Material: Housing	UL 94V-0

Appliance-Inlet/-Outlet	C14 acc. to IEC/EN 60320-1 UL 498, CSA C22.2 no. 42 (for cold conditions) pin-temperature 70 °C, 10A, Protection class I
Line Switch	Rocker switch 1 or 2 pole, non-illuminated or illuminated black, acc. to IEC 61058-1 Technical details

Dimensions

Length |-----| 53.2 mm

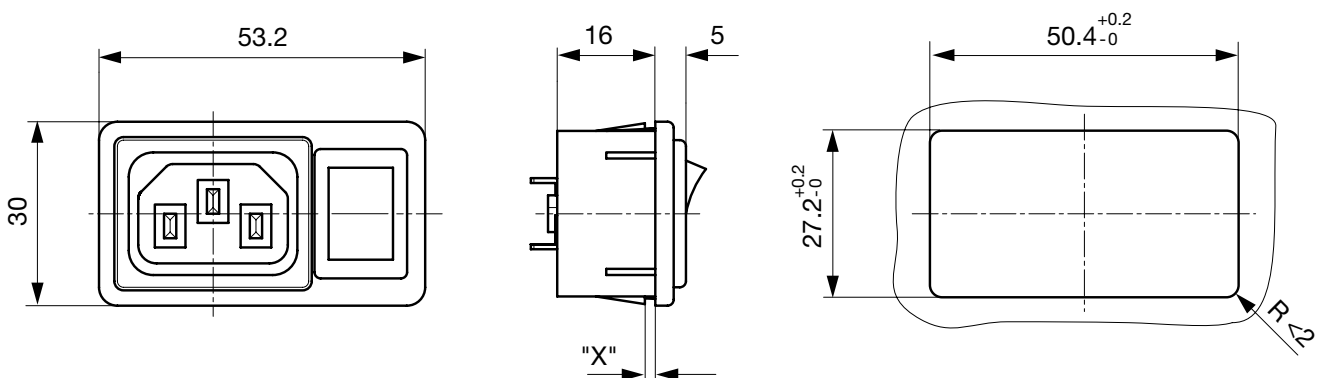

Dimension "X" please ref. to table order code

Variants

Order Code	Description	Order Number
6010-K--7770-A-4256	6010-K, IEC Power Entry Module C14, 70°C, version: I, L: blade terminal (2,8x0,8mm), N: blade terminal (2,8x0,8mm), ground: blade terminal (2,8x0,8mm), fuseholder: without terminal, color: jet black; RAL9005, design: snap-in (x=panel thickness), dimension X: 25, features: not used, bipolar switch, 4,8mm blade terminal, rocker red illuminated	4304.6045
6010-K--9990-A-4154	6010-K, IEC Power Entry Module C14, 70°C, version: I, L: blade terminal (6,3x0,8mm), N: blade terminal (6,3x0,8mm), ground: blade terminal (6,3x0,8mm), fuseholder: without terminal, color: jet black; RAL9005, design: snap-in (x=panel thickness), dimension X: 15, features: not used, bipolar switch, 4,8mm blade terminal, black rocker	4304.6046
6010-K--9990-A-4254	6010-K, IEC Power Entry Module C14, 70°C, version: I, L: blade terminal (6,3x0,8mm), N: blade terminal (6,3x0,8mm), ground: blade terminal (6,3x0,8mm), fuseholder: without terminal, color: jet black; RAL9005, design: snap-in (x=panel thickness), dimension X: 25, features: not used, bipolar switch, 4,8mm blade terminal, black rocker	4304.6047
6010-K--999-A-4254	6010-K, IEC Power Entry Module C14, 70°C, version: I, L: blade terminal (6,3x0,8mm), N: blade terminal (6,3x0,8mm), ground: blade terminal (6,3x0,8mm), fuseholder: without terminal, color: jet black; RAL9005, design: snap-in (x=panel thickness), dimension X: 25, features: not used, bipolar switch, 4,8mm blade terminal, black rocker	4304.6048

The listed variants should be available from stock. Other versions on request.

Packaging unit 50 Pcs

Mating Outlets/Connectors

Category / Description

Appliance Outlet



IEC appliance outlet F, screw-on mounting, front side, solder /quick connect terminal	4787
IEC appliance outlet F, screw-on mounting, front side, solder /quick connect terminal	4788
IEC appliance outlet F oder H, screw-on mounting, front side, solder/PCB/quick connect terminal	5091
IEC appliance outlet F oder H, screw-on mounting, front side, solder/quick connect terminal	5092

Connector



IEC cord connector C15, rewirable, straight	0101
IEC cord connector C15A, rewirable, straight	0102
IEC cord connector C15A, rewirable, straight	0102-G
IEC cord connector C15A, rewirable, angled	0112
IEC cord connector C13, rewirable, angled	4012
IEC cord connector C13, rewirable, angled	4013
IEC cord connector C13, rewirable, straight	4020
IEC cord connector C13, rewirable, straight	4021
IEC cord connector C13, rewirable, straight	4022
IEC cord connector C13, rewirable, angled	4300-06

...

Power Supply or Interconnection Cord



Power Cord with IEC Appliance Connector C13, angled, 70°C	0311
Power Cord with IEC Appliance Connector C13, angled, 70°C	3011
Power Cord with IEC Appliance Connector C13, angled, 70°C	3012
Power Cord with IEC Appliance Connector C13, angled, 70°C	3013
Power Cord with IEC Appliance Connector C13, 70°C	3020
Power Cord with IEC Appliance Connector C13, straight, 70°C	3027
Power Cord with IEC Appliance Connector C13, straight, 70°C	302U
Power Cord with IEC Appliance Connector C13, straight, 70°C	3030
Power Cord with IEC Appliance Connector C13, angled, 70°C	311L
Power Cord with IEC Appliance Connector C13, angled, 70°C	312L

...