

Part Number

Description

[TL-1125](#)

Twist Lock,Natural,1-3/16" Max



PART NO.	"A" REF. APPROXIMATE OVERALL HEIGHT	"B" REF. WIRE BUNDLE
TL-250	.90 (22.9)	.20-.30 (5.1-7.6)
TL-350	1.03 (26.2)	.30-.40 (7.6-10.2)
TL-450	1.20 (30.5)	.40-.50 (10.2-12.7)
TL-600	1.33 (33.7)	.55-.65 (14.0-16.5)
TL-750	1.55 (39.4)	.70-.80 (17.8-20.3)
TL-950	1.70 (43.4)	MAX 1.00 (25.4)
TL-1125	2.19 (55.6)	MAX 1-3/16 (30.2)
TL-1375	2.68 (68.1)	MAX 1-7/16 (36.5)
TL-1500	2.93 (74.4)	MAX 1-9/16 (39.7)
TL-1750	3.45 (87.6)	MAX 1-13/16 (46.0)

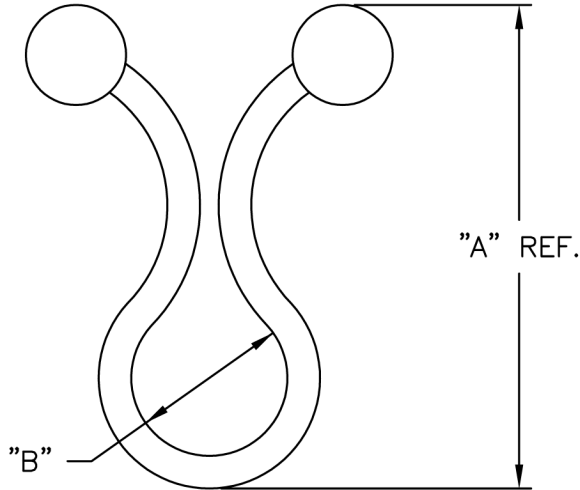

NOTES:

- MATERIAL: NYLON 6/6 (RMS-01).
FLAME RETARDANT NYLON (RMS-19)
AVAILABLE BY SPECIAL ORDER
SPECIFIED MATERIALS COMPLY WITH STANDARD SS-00259-1.
- COLOR: NATURAL.
- BLACK, RED, GREEN, & YELLOW
AVAILABLE BY SPECIAL ORDER.

G	SEE ECN #596 FOR CHANGES	SM 03.12.03	TITLE: TWIST-LOK				DWG IN IN (MM)	FINAL	PRINT TYPE
F	ADDED FLAME RET. NOTE- ECN #516	SM 11.11.02							
E	ADDED NOTE 3	SJ 03.13.02	FILE # TL		DWN: P.B.	APP:	PART #	CA	
D	CHANGED FILE NO. AND TITLE BLOCK	SM 05.31.01	MAT'L: SEE NOTES		DT: 03-22-94	DT:			
C	RANGE OF 1125 THRU 1750 CHANGED "B" DIM TOLERANCE REMOVED	JP 8/15/94	RE: RICHCO, INC.		RICHCO INC.		SEE TABLE		
B	P/N TL-600 AND 950 ADDED	PB 8/8/94	TOLERANCES UNLESS NOTED .XX=±.010 .XXX=±.005 FRAC=±1/64 ANG=±1'						
A	P/N TL-1125/1375/1500 AND 1750 ADDED	JP 7/22/94							
REV	DESCRIPTION	ENGR DATE							