

4.5mm HEX MALE-FEMALE STANDOFFS

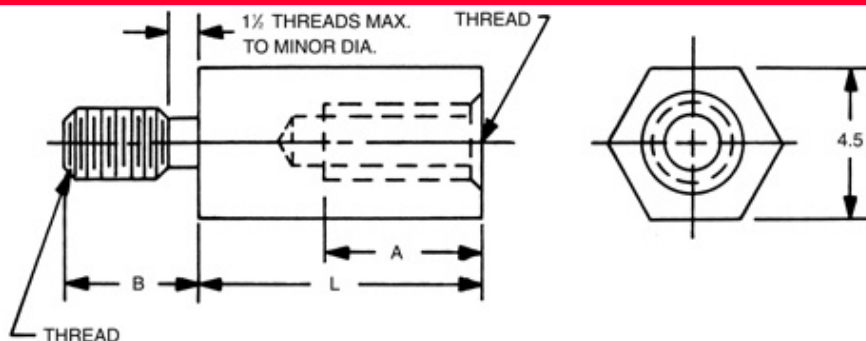

Order Code:

Finishes: [\[How to create part numbers\]](#) [\[Material Specifications\]](#)

SELECT	PART NO.	LENGTH
	M2100	5
	M2101	6
	M2102	7
	M2103	8
	M2104	9
	M2105	10
	M2106	11
	M2107	12
	M2108	13
	M2109	14
	M2110	15
	M2111	16
	M2112	17
	M2113	18
	M2114	19

SELECT	PART NO.	LENGTH
	M2115	20
	M2116	21
	M2117	22
	M2118	23
	M2119	24
	M2120	25
	M2121	28
	M2122	31
	M2123	34
	M2124	37
	M2125	40
	M2126	43
	M2127	46
	M2128	49
	M2129	52

THREAD LENGTH CODE				
Select	CODE	THREAD	A	B
	2545	M2.5x0.45	4.8	3.97
	3005	M3x0.5	6.4	4.76

MINIMUM THREAD DEPTH "A"						
THREAD	Body Length "L"					
	5	6	7	8	9	
M2.5x0.45	1.9	2.9	3.9	-	-	
M3x0.5	1.8	2.8	3.8	4.8	5.8	

Select	CODE	MATERIAL	RoHS
	AL	ALUMINUM	YES
	B	BRASS	YES
	SS	STAINLESS STEEL	YES
	S	STEEL	YES
	N	NYLON	YES

Ordering Code			
mxxxx	xxxx	xx	xx
	Thread		Finish
Length	Material		

[For non standard items please click here](#)

[Available with thread locking products](#)