

# 5/16 ROUND INTERNAL THREAD HANDLES

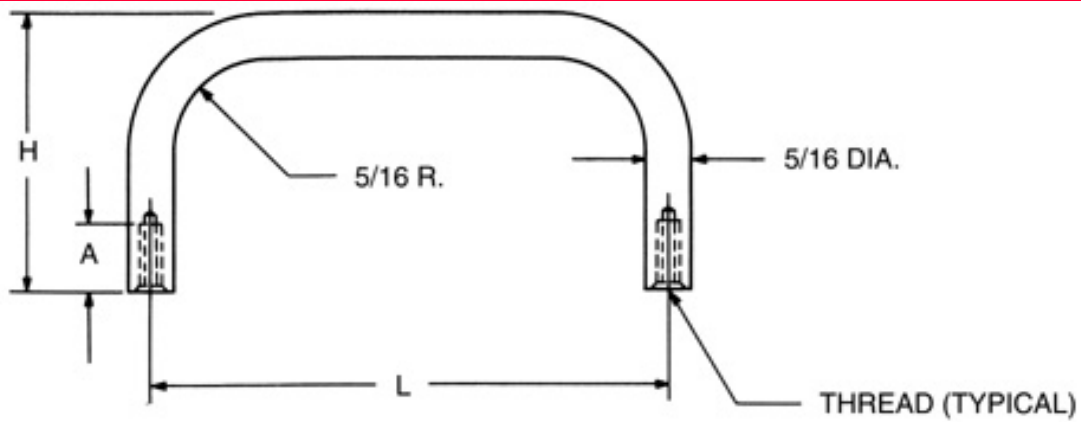

Order Code:

<<<
>>>  
Contents

Finishes: Quote
[\[How to create part numbers\]](#)
[\[Material Specifications\]](#)

1-1/2 LEG HEIGHT				
SELECT	PART NO.	L +1/32 -1/32	H +1/32 -1/32	
	8172	2	1-1/2	
	8173	2-1/8	1-1/2	
	8174	2-1/4	1-1/2	
	8175	2-3/8	1-1/2	
	8176	2-1/2	1-1/2	
	8177	2-3/4	1-1/2	
	8178	3	1-1/2	
	8179	3-1/8	1-1/2	
	8180	3-1/4	1-1/2	
	8181	3-1/2	1-1/2	
	8182	4	1-1/2	
	8183	4-1/4	1-1/2	

1-1/2 LEG HEIGHT				
SELECT	PART NO.	L +1/32 -1/32	H +1/32 -1/32	
	8184	4-1/2	1-1/2	
	8185	4-9/16	1-1/2	
	8186	4-5/8	1-1/2	
	8187	5	1-1/2	
	8188	5-1/4	1-1/2	
	8189	5-1/2	1-1/2	
	8190	5-3/4	1-1/2	
	8191	6	1-1/2	
	8192	6-7/16	1-1/2	
	8193	6-1/2	1-1/2	
	8194	7	1-1/2	

THREAD CODE & DEPTH			
Select	CODE	THREAD	A
	832	8-32	7/16
	1032	10-32	5/16-5/8

Select	CODE	MATERIAL	RoHS
	A	ALUMINUM	YES
	B	BRASS	YES
	SS	STAINLESS STEEL	YES
	S	STEEL	YES

Ordering Code			
xxxx	xxxx	x	xxx
	Thread		Finish
Length & Height		Material	

For non standard items  
please click [here](#)



© 1999 RAF Electronic Hardware All Rights Reserved  
 Seymour CT 06483 203 888-2133 Fax: 203 888-9860 www.rafdwe.com