

5/32 ROUND INTERNAL THREAD HANDLES

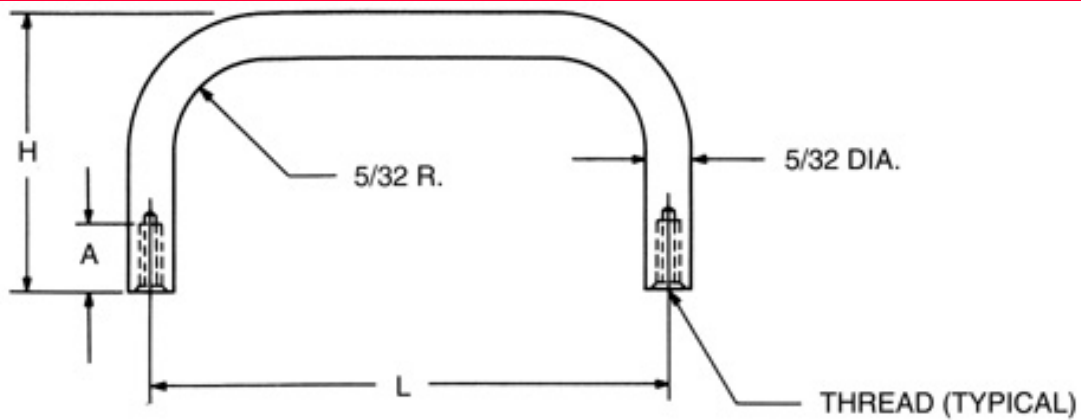

Order Code:

Finishes: [\[How to create part numbers\]](#) [\[Material Specifications\]](#)

| 1 in. LEG HEIGHT | | | |
|--------------------------|----------|---------------------|---------------------|
| SELECT | PART NO. | L +1/32 -1/32 | H +1/32 -1/32 |
| <input type="checkbox"/> | 8041 | 1 | 1 |
| <input type="checkbox"/> | 8042 | 1-1/4 | 1 |
| <input type="checkbox"/> | 8043 | 1-1/2 | 1 |
| <input type="checkbox"/> | 8044 | 1-3/4 | 1 |
| <input type="checkbox"/> | 8045 | 2 | 1 |
| <input type="checkbox"/> | 8046 | 2-1/2 | 1 |
| <input type="checkbox"/> | 8047 | 3 | 1 |

| THREAD CODE & DEPTH | | | |
|--------------------------|------|--------|---------|
| Select | CODE | THREAD | A |
| <input type="checkbox"/> | 256 | 2-56 | 3/16 |
| <input type="checkbox"/> | 440 | 4-40 | 1/4-3/8 |

| Select | CODE | MATERIAL | RoHS |
|--------------------------|------|-----------------|------|
| <input type="checkbox"/> | A | ALUMINUM | YES |
| <input type="checkbox"/> | B | BRASS | YES |
| <input type="checkbox"/> | SS | STAINLESS STEEL | YES |
| <input type="checkbox"/> | S | STEEL | YES |

| Ordering Code | | | |
|-----------------|--------|----------|--------|
| xxxx | xxxx | x | xxx |
| | | | |
| | Thread | | Finish |
| Length & Height | | Material | |

For non standard items
please click here



© 1999 RAF Electronic Hardware All Rights Reserved
Seymour CT 06483 203 888-2133 Fax: 203 888-9860 www.rafdwe.com