

1/4 HEX MALE-FEMALE STANDOFFS

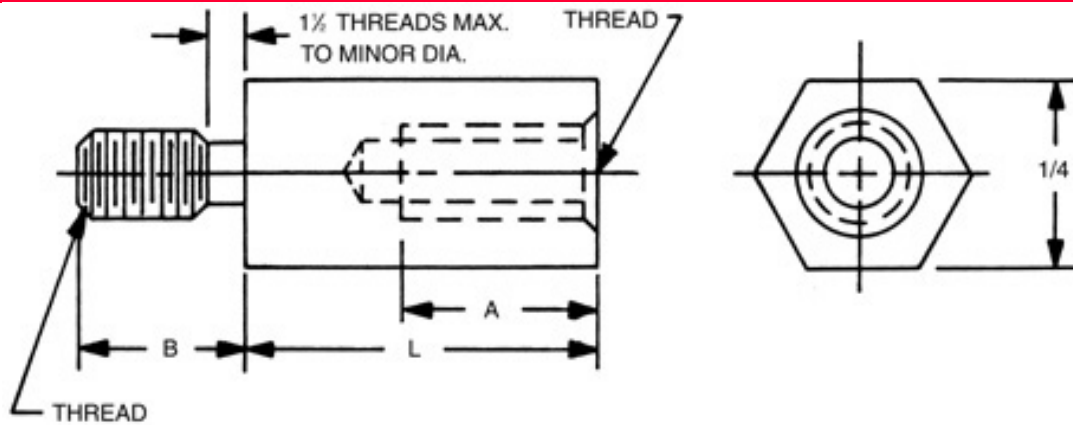

Order Code:



Contents

Finishes:

Quote
[\[How to create part numbers\]](#)
[\[Material Specifications\]](#)

SELECT	PART NO.	LENGTH
<input type="checkbox"/>	4530A	7/32
<input type="checkbox"/>	4530	1/4
<input type="checkbox"/>	4530T	9/32
<input type="checkbox"/>	4531	5/16
<input type="checkbox"/>	4531T	11/32
<input type="checkbox"/>	4532	3/8
<input type="checkbox"/>	4532T	13/32
<input type="checkbox"/>	4533	7/16
<input type="checkbox"/>	4533T	15/32
<input type="checkbox"/>	4534	1/2
<input type="checkbox"/>	4534T	17/32
<input type="checkbox"/>	4535	9/16
<input type="checkbox"/>	4535T	19/32
<input type="checkbox"/>	4536	5/8
<input type="checkbox"/>	4536T	21/32
<input type="checkbox"/>	4537	11/16
<input type="checkbox"/>	4537T	23/32
<input type="checkbox"/>	4538	3/4
<input type="checkbox"/>	4538T	25/32
<input type="checkbox"/>	4539	13/16
<input type="checkbox"/>	4539T	27/32
<input type="checkbox"/>	4540	7/8
<input type="checkbox"/>	4540T	29/32

SELECT	PART NO.	LENGTH
<input type="checkbox"/>	4541	15/16
<input type="checkbox"/>	4541T	31/32
<input type="checkbox"/>	4542	1"
<input type="checkbox"/>	4543	1-1/16
<input type="checkbox"/>	4544	1-1/8
<input type="checkbox"/>	4545	1-3/16
<input type="checkbox"/>	4546	1-1/4
<input type="checkbox"/>	4547	1-5/16
<input type="checkbox"/>	4548	1-3/8
<input type="checkbox"/>	4549	1-7/16

SELECT	PART NO.	LENGTH
<input type="checkbox"/>	4550	1-1/2
<input type="checkbox"/>	4551	1-9/16
<input type="checkbox"/>	4552	1-5/8
<input type="checkbox"/>	4553	1-11/16
<input type="checkbox"/>	4554	1-3/4
<input type="checkbox"/>	4555	1-13/16
<input type="checkbox"/>	4556	1-7/8
<input type="checkbox"/>	4557	1-15/16
<input type="checkbox"/>	4558	2
<input type="checkbox"/>	4559	2-1/8
<input type="checkbox"/>	4560	2-1/4
<input type="checkbox"/>	4561	2-3/8
<input type="checkbox"/>	4562	2-1/2
<input type="checkbox"/>	4563	2-5/8
<input type="checkbox"/>	4564	2-3/4
<input type="checkbox"/>	4565	2-7/8
<input type="checkbox"/>	4566	3
<input type="checkbox"/>	4567	3-1/4
<input type="checkbox"/>	4568	3-1/2
<input type="checkbox"/>	4569	3-3/4
<input type="checkbox"/>	4570	4

Select	CODE	THREAD
<input type="checkbox"/>	256	2-56
<input type="checkbox"/>	440	4-40
<input type="checkbox"/>	632	6-32
<input type="checkbox"/>	832	8-32

THREAD LENGTH CODE		
THREAD	A	B
2-56	3/16	5/32
4-40	1/4	3/16
6-32	3/8	1/4
8-32	7/16	3/8

In short lengths, "A" will be tapped to maximum depth

Select	CODE	MATERIAL	RoHS
<input type="checkbox"/>	A	ALUMINUM	NO
<input type="checkbox"/>	B	BRASS	YES
<input type="checkbox"/>	SS	STAINLESS STEEL	YES
<input type="checkbox"/>	S	STEEL	YES
<input type="checkbox"/>	N	NYLON	YES

Ordering Code			
xxxx	xxx	x	x
	Thread		Finish
	Length		Material

For non standard items

[please click here](#)



© 1999 RAF Electronic Hardware All Rights Reserved
Seymour CT 06483 203 888-2133 Fax: 203 888-9860 www.rafhdwe.com