

**1/4 ROUND SPACERS**

RAF

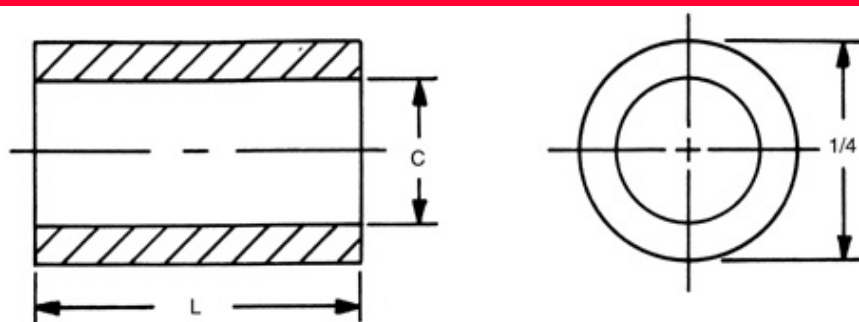

RAF

[\[How to create part numbers\]](#) [\[Material](#)

[Specifications\]](#)

SELECT	PART NO.	LENGTH
	1122A	3/32
	1122	1/8
	1122T	5/32
	1123	3/16
	1123T	7/32
	1124	1/4
	1124T	9/32
	1125	5/16
	1125T	11/32
	1126	3/8
	1126T	13/32
	1127	7/16
	1127T	15/32
	1128	1/2
	1128T	17/32

Select	PART NO.	LENGTH
	1129	9/16
	1129T	19/32
	1130	5/8
	1130T	21/32
	1131	11/16
	1131T	23/32
	1132	3/4
	1132T	25/32
	1133	13/16
	1133T	27/32
	1134	7/8
	1134T	29/32
	1135	15/16
	1135T	31/32
	1136	1

SELECT	PART NO.	LENGTH
	1137	1-1/16
	1138	1-1/8
	1139	1-3/16
	1140	1-1/4
	1141	1-5/16
	1142	1-3/8
	1143	1-7/16
	1144	1-1/2
	1145	1-9/16
	1146	1-5/8
	1147	1-11/16
	1148	1-3/4
	1149	1-13/16
	1150	1-7/8
	1151	1-15/16
	1152	2

HOLE CLEARANCE CODE		
Select	CODE	
		+0.010 -0.000
	2	.090
	4	.115
	6	.140
	8	.166

Select	CODE	MATERIAL	RoHS
	AL	ALUMINUM	YES
	B	BRASS	YES
	SS	STAINLESS STEEL	YES
	S	STEEL	YES
	N	NYLON	YES
	PH	PHENOLIC	YES

Ordering Code			
xxxx	x	x	x
	Clearance Hole		Finish
Length		Material	

[For non standard items please click here](#)