

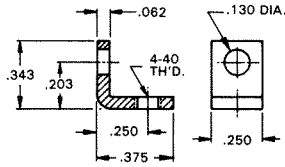

Designers' Choice

# THREADED MOUNTING BRACKETS

4-40 THREAD



CAT. NO. 612

.062 Steel  
Zinc Plate

4-40 THREAD

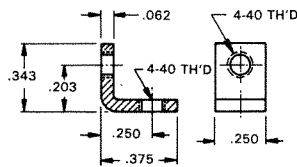

CAT. NO. 621

.062 Steel  
Zinc Plate

4-40 THREAD

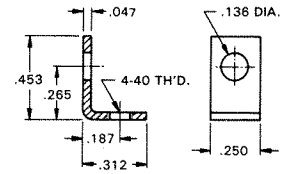
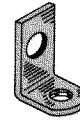

CAT. NO. 616

.047 Brass  
Tin Plate

6-32 THREAD

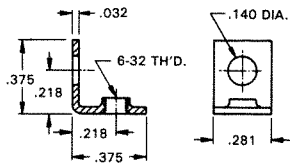

CAT. NO. 634

.032 Brass  
Nickel Plate

6-32 THREAD

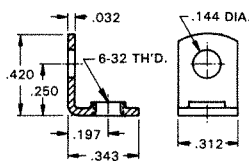

CAT. NO. 614

.032 Brass  
Tin Plate

6-32 THREAD

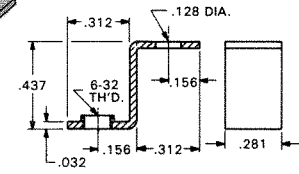
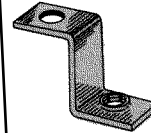

CAT. NO. 630

.032 Brass  
Tin Plate

6-32 THREAD

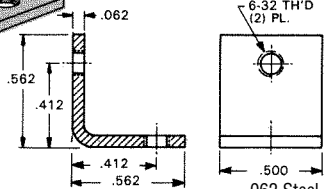
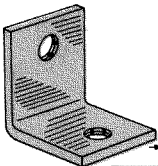

CAT. NO. 4334

.062 Steel  
Nickel Plate

6-32 THREAD

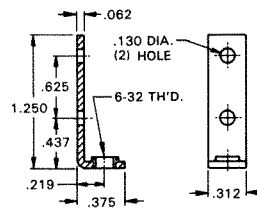
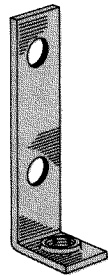

CAT. NO. 708

.062 Steel  
Nickel Plate

6-32 THREAD

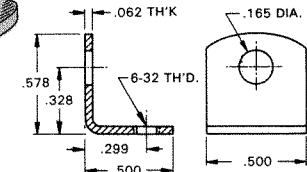
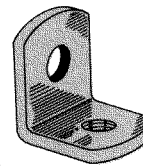

CAT. NO. 617

.062 Steel  
Tin Plate

6-32 OR 8-32 THREAD

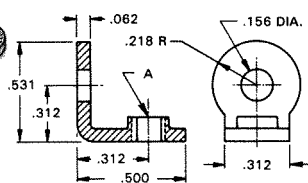
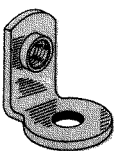

CAT. NO. 4332 #6-32  
CAT. NO. 4333 #8-32

.062 Brass  
Nickel Plate

8-32 THREAD

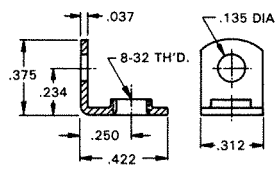

CAT. NO. 611

.037 Brass  
Tin Plate

8-32 THREAD

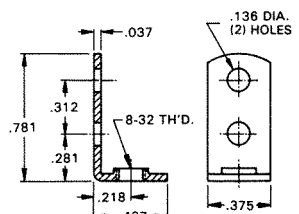
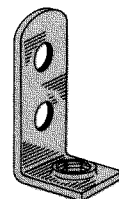

CAT. NO. 631

.037 Steel  
Tin Plate

# CLEAR HOLE MOUNTING BRACKETS

Designers' Choice



## BOARD BRACKETS

Originally designed for our line of standardized terminal boards; these brackets can also be used in other applications.

Choice of Steel or Aluminum

MATERIAL:

.062 Steel, Nickel Plate

.062 Aluminum

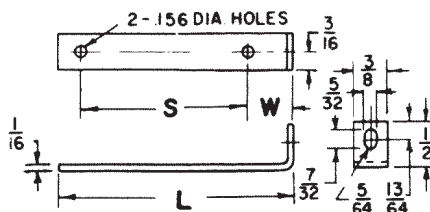
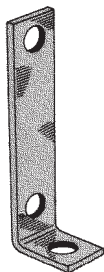

CAT. NO.		W	L	S	For Use With Board No's (see page 98)		
Steel	Alum.				15032	15072	15092
1556	622	3/8	1 5/8	1	15032	15072	15092
1567	623	3/8	2 1/8	1 1/2	15033	15073	15093
1568	624	3/8	2 5/8	2	15034	15074	15094
1569	625	3/8	3 1/8	2 1/2	15035	15075	15095
1570	626	9/32	1 3/16	3/4	15022	15024	15030
1571	627	9/32	1 5/8	1 3/16	15036	15076	15096

.062 STEEL NICKEL PLATE

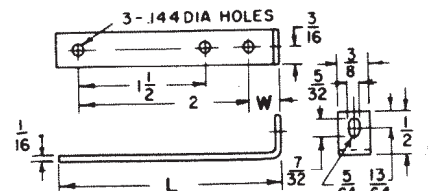
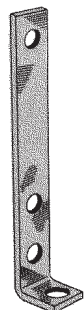

CAT. NO.	L	W
1565	2 5/8	3/8
1566	2 13/16	9/16

.062 STEEL NICKEL PLATE

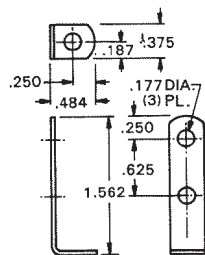
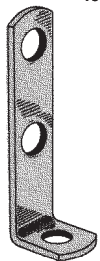

CAT. NO. 1564

.050 STEEL NICKEL PLATE

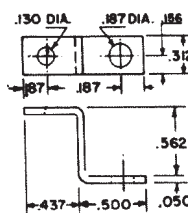
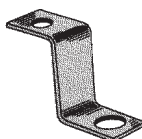

CAT. NO. 4325

.080 ALUMINUM

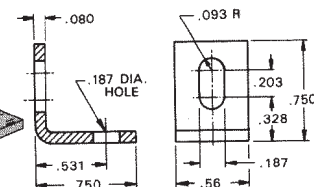
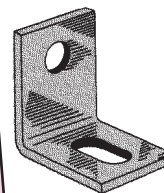

CAT. NO. 4337

## UNIVERSAL BRACKETS

A wide variety of brackets for various mounting applications.

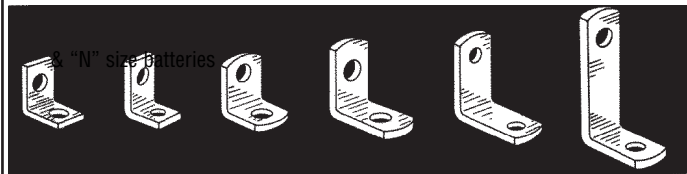

633 613 615 618 619 620  
4335 4336 4326

STANDARD BRACKETS  
(Brass and Steel)

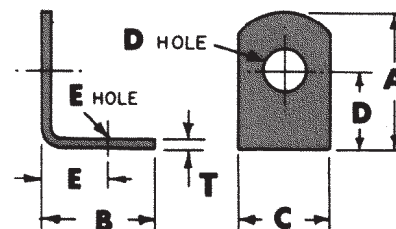

Selection of Brackets with Clear Holes

CAT. NO.	A	B	C	D	"D" Hole Dia.	E	"E" Hole Dia.	"T" Material	Finish
633	.375	.375	.281	.218	.140	.218	.140	.032 Brass	Nickel
613	.390	.453	.375	.234	.147	.299	.128	.032 Brass	Nickel
615	.420	.343	.281	.281	.144	.203	.128	.032 Brass	Tin
4335	.562	.562	.500	.412	.120	.411	.120	.062 Steel	Nickel
4336	.562	.562	.500	.412	.144	.412	.144	.062 Steel	Nickel
618	.628	.628	.375	.378	.169	.378	.169	.050 Brass	Tin
619	.687	.687	.375	.500	.144	.500	.144	.032 Steel	Tin
4326	1.013	.487	.312	.816	.140	.332	.140	.050 Steel	Nickel
620	1.156	.656	.375	.906	.169	.420	.169	.032 Steel	Tin

## BOARD SUPPORT BRACKETS

MATERIAL: Brass, Zinc Plate

A sturdy support for mounting of standardized terminal boards.

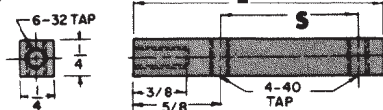

CAT. NO.	Overall Length "L"	Spacing "S"
1647	2 3/8	1 1/2
1648	2 7/8	2
1649	3 3/8	2 1/2

## CUSTOM STAMPING AND ASSEMBLY

Keystone is fully integrated to meet your total design & production needs.

Manufacturing custom designs & modifications of standard items is our specialty.

Quotations on special stamping & assembly furnished promptly upon receipt of sample, sketch, print or CAD drawings.



Designers' Choice

# COMPUTER BRACKETS



These printed circuit card brackets have been designed to fit all PC computers and are available with a variety of holes and cutouts to connect any peripheral. The standard brackets shown reflect the most common configurations and cutouts for specific applications. If our standard brackets do not suit your applications we can fabricate a bracket to your exact requirements. (See page 65)

These premium quality brackets have a "high luster" finish for appearance and durability.

- Premium quality
- Designed to fit all PC computers
- Standard brackets available for most common configurations
- A variety of holes and cutouts to suit all peripherals
- Special configurations available to meet specific needs
- Standard international symbol markings available
- Blanks available for "fillers"
- Fast delivery and cost effective tooling for special designs

MATERIAL: .032 Steel, Nickel Plate



## STANDARD BLANKS & BRACKETS

EISA/ISA or PCI

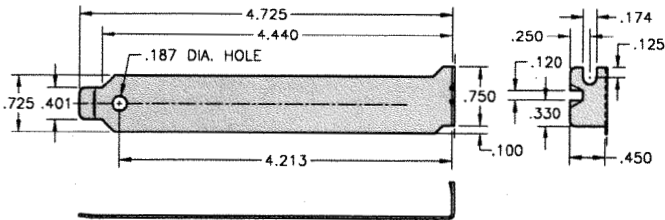

CAT. NO. 9200

EISA/ISA or PCI

- Reinforced with rib for extra strength

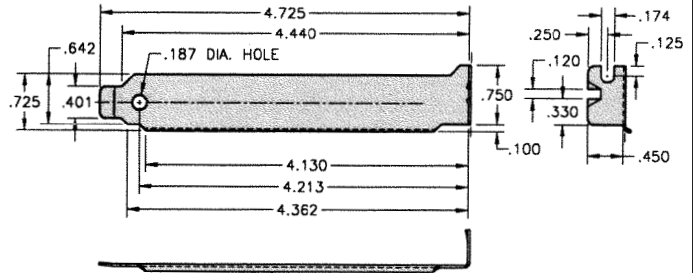

CAT. NO. 9201

EISA/ISA

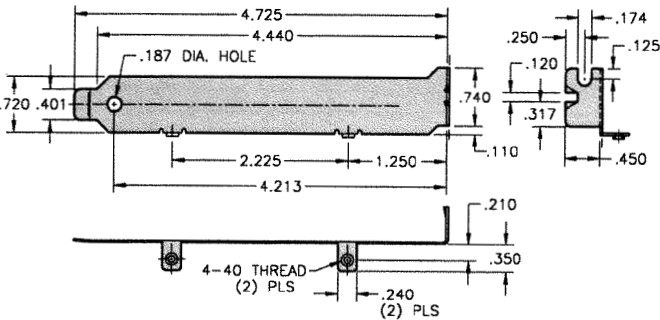

CAT. NO. 9202

PCI

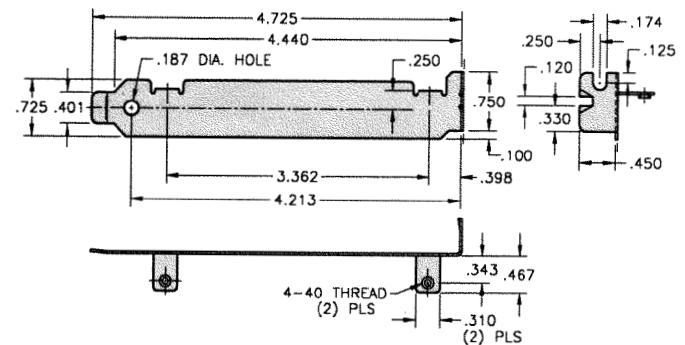

CAT. NO. 9203

PCI

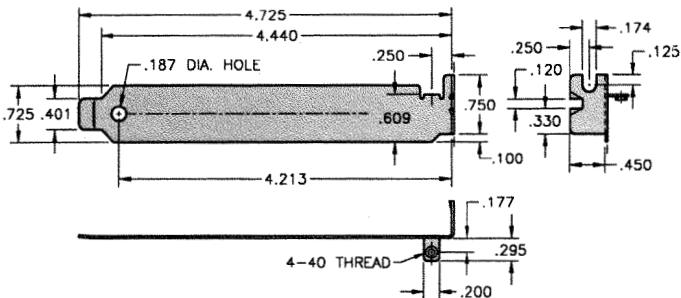

CAT. NO. 9204

## SECURITY BRACKET

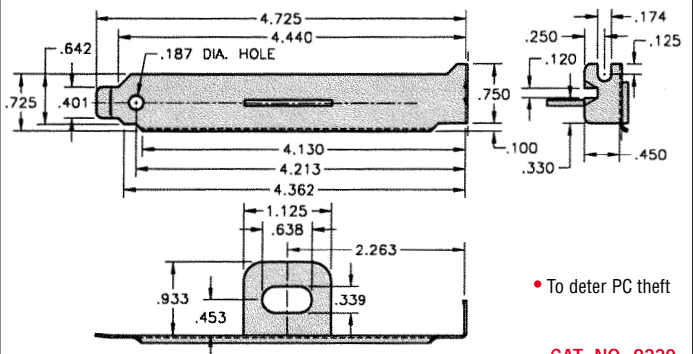

- To deter PC theft

CAT. NO. 9220