

## PLC4S-S10-C0



- Greater resistance to damage caused by ultraviolet light – indoor or outdoor use
- Used to secure a cable bundle to another surface such as a control panel, communication rack, wall or ceiling
- Design allows for bundling before or after screwing clamp in place
- One-piece construction for consistent performance and reliability
- Curved tip is easy to pick up from flat surfaces and allows faster initial threading to speed installation

|                                     |  |
|-------------------------------------|--|
| ■ Part Number                       | PLC4S-S10-C0                             |
| ■ RoHS Compliancy Status            | Compliant                                |
| ■ Part Description                  | Clamp Tie, 15.0", Standard cross section |
| ■ Product Type                      | Cable Ties                               |
| ■ Material                          | Weather Resistant Nylon 6.6              |
| ■ Color                             | Black                                    |
| ■ CSA Certified                     | Yes                                      |
| ■ UL Listed (File #E56854)          | No                                       |
| ■ UL Recognized (File #E56854)      | Yes                                      |
| ■ Length (In.)                      | 15.0                                     |
| ■ Length (mm)                       | 381                                      |
| ■ Width (In.)                       | .190                                     |
| ■ Width (mm)                        | 4.8                                      |
| ■ Boss Height (In.)                 | .220                                     |
| ■ Boss Height (mm)                  | 5.6                                      |
| ■ Boss Width (In.)                  | .373                                     |
| ■ Boss Width (mm)                   | 9.5                                      |
| ■ CE Compliant                      | Yes                                      |
| ■ Cross Section                     | Standard                                 |
| ■ Locking Style                     | Locking                                  |
| ■ Material Flammability Rating      | UL 94V-2                                 |
| ■ Max. Bundle Diameter (In.)        | 4.00                                     |
| ■ Max. Bundle Diameter (mm)         | 102                                      |
| ■ Max. Continuous Use Temperature   | 185°F (85°C)                             |
| ■ Min. Loop Tensile Strength (Lbs.) | 50                                       |
| ■ Min. Loop Tensile Strength (N)    | 222                                      |

|                               |   |
|-------------------------------|---|
| ▪ Nominal Hole Diameter (In.) | .200  |
| ▪ Nominal Hole Diameter (mm)  | 5.1   |
| ▪ Pricing Description         | Clamp Tie, 15.0"L (381mm), #10 (M5) Screw, Standard, Weather Resistant, Black |
| ▪ Screw Size                  | #10   |
| ▪ Screw Size Metric           | M5  |
| ▪ Thickness (In.)             | .052  |
| ▪ Thickness (mm)              | 1.3   |
| ▪ Tool                        | GTS, GTSL, GS2B, GTH, GS4H, PTS, PTH, PPTS, STS2, STH2                        |
| ▪ Min. Order UOM              | PC  |
| ▪ Min. Order Qty.             | 100   |
| ▪ BOM Qty. (# of Pkgs.)       |   |

THIS COPY IS PROVIDED ON A RESTRICTED BASIS AND IS NOT TO BE USED IN ANY WAY DETRIMENTAL TO THE INTERESTS OF PANDUIT CORP.

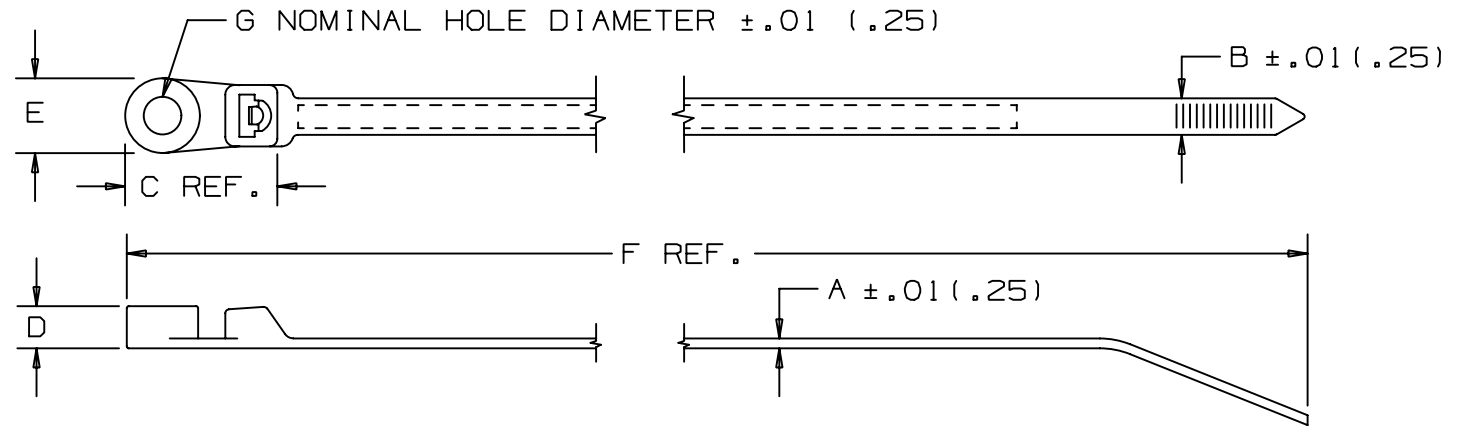
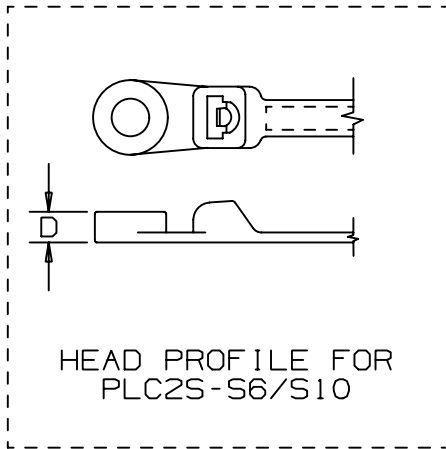

| PANDUIT<br>PART NO. * | BUNDLE DIA.     |                 | A<br>In<br>(mm) | B<br>In<br>(mm) | C<br>In<br>(mm) | D<br>In<br>(mm) | E<br>In<br>(mm) | F<br>In<br>(mm) | G<br>In<br>(mm) | MIN. LOOP<br>TENSILE<br>lbs (N) | CROSS-<br>SECTION | RECM.<br>FASTENER  | WEIGHT<br>lbs/100pcs<br>(g) |
|-----------------------|-----------------|-----------------|-----------------|-----------------|-----------------|-----------------|-----------------|-----------------|-----------------|---------------------------------|-------------------|--------------------|-----------------------------|
|                       | MIN. In<br>(mm) | MAX. In<br>(mm) |                 |                 |                 |                 |                 |                 |                 |                                 |                   |                    |                             |
| PLC1M-S4              | .06<br>(1.5)    | .75<br>(19)     | .045<br>(1.1)   | .100<br>(2.5)   | .542<br>(13.8)  | .153<br>(3.9)   | .239<br>(6.1)   | 4.3<br>(109.2)  | .122<br>(3.1)   | 18<br>(80)                      | MINIATURE         | #4 (M2.5)<br>SCREW | .08<br>(36)                 |
| PLC1.5I-S8            | .06<br>(1.5)    | 1.25<br>(32)    | .045<br>(1.1)   | .135<br>(3.4)   | .694<br>(17.6)  | .166<br>(4.2)   | .335<br>(8.5)   | 6.1<br>(154.9)  | .174<br>(4.4)   | 40<br>(178)                     | INTERMEDIATE      | #8 (M4)<br>SCREW   | .18<br>(82)                 |
| PLC2S-S6              | .06<br>(1.5)    | 1.84<br>(47)    | .047<br>(1.2)   | .190<br>(4.8)   | .765<br>(19.4)  | .160<br>(4.1)   | .373<br>(9.5)   | 7.9<br>(200.7)  | .148<br>(3.8)   | 50<br>(222)                     | STANDARD          | #6 (M3)<br>SCREW   | .32<br>(145)                |
| PLC2S-S10             | .06<br>(1.5)    | 1.84<br>(47)    | .047<br>(1.2)   | .190<br>(4.8)   | .765<br>(19.4)  | .160<br>(4.1)   | .373<br>(9.5)   | 7.9<br>(200.7)  | .200<br>(5.1)   | 50<br>(222)                     | STANDARD          | #10 (M5)<br>SCREW  | .32<br>(145)                |
| PLC3S-S10             | .06<br>(1.5)    | 3.00<br>(76)    | .052<br>(1.3)   | .190<br>(4.8)   | .765<br>(19.4)  | .220<br>(5.6)   | .373<br>(9.5)   | 12<br>(304.8)   | .200<br>(5.1)   | 50<br>(222)                     | STANDARD          | #10 (M5)<br>SCREW  | .50<br>(227)                |
| PLC4S-S10             | .06<br>(1.5)    | 4.00<br>(102)   | .052<br>(1.3)   | .190<br>(4.8)   | .765<br>(19.4)  | .220<br>(5.6)   | .373<br>(9.5)   | 15<br>(381.0)   | .200<br>(5.1)   | 50<br>(222)                     | STANDARD          | #10 (M5)<br>SCREW  | .59<br>(268)                |

NOTES:

- \*1) SEE CURRENT PRICE SHEET FOR PART NUMBER SUFFIX DESIGNATION FOR PACKAGE SIZE AND PART COLOR
- 2) RECOGNIZED UNDER THE COMPONENT PROGRAM OF UNDERWRITERS LABORATORIES INC.

SS\_2724\_18.PRT

CAD FILENAME/LAYERS  
DIMENSIONS IN PARENTHESES ARE IN METRIC UNITS

PANDUIT CORP. TINLEY PARK, ILLINOIS

PAN-TY LOCKING CLAMP TIE  
PLC SERIES

UNLESS OTHERWISE SPECIFIED,  
DIMENSIONAL TOLERANCES ARE:  
(.X)  $\pm$  ---- (.XXX)  $\pm$  .020(.51)  
(.XX)  $\pm$  .02(.5) ANGLES  $\pm$  ----

UNLESS OTHERWISE SPECIFIED,  
ALL DIMENSIONS ARE GIVEN  
IN INCHES, THIRD ANGLE PROJECTION.

| REV | DATE    | BY  | CHK | DESCRIPTION   | ECN  | R  | CUST | SUP | DRAWN BY        | MAT'L:    | SCALE | DRAWING NO. | DWG<br>SIZE |
|-----|---------|-----|-----|---|------|----|------|-----|-----------------|-----------|-------|-------------|-------------|
| --  | -----   | --- |     | CHANGED MAX. BUNDLE DIA. METRIC NUMBERS TO WHOLE NUMBERS          | ---- | -- |      |     | L.V./AJC        |           | NONE  |             |             |
| 18  | 5/31/05 | ERW |     | CHANGED DIMENSION 'G' FROM A TOLERANCE TO A NOMINAL HOLE DIAMETER | 2724 | 18 |      |     | DATE<br>2-11-71 | NYLON 6.6 |       | SS-2724     | A<br>SIZE   |
|     |         |     |     |   |      |    |      |     | CHK'D<br>HVP    |           |       |             |             |