



## MRS6S-C6



- 360° radial seal eliminates gaps under the head of the tie to provide a completely sealed installation
- Self-locking cable tie design locks into place at any length along the tie body, unlike fixed diameter band clamps
- Available in AISI 304 stainless steel for general-purpose applications
- Available in AISI 316 stainless steel for the most corrosive environments

▪ Part Number	MRS6S-C6
▪ RoHS Compliancy Status	Compliant
▪ Part Description	360° radial seal retained tension, stainless steel cable tie, standard, 6.0" (152mm) max. bundle diameter.
▪ Product Type	Cable Ties
▪ Material	Stainless Steel Type 316
▪ Length (In.)	23.8
▪ Length (mm)	604
▪ Width (In.)	.18
▪ Width (mm)	4.4
▪ Cross Section	Standard
▪ Max. Bundle Diameter (In.)	6.0
▪ Max. Bundle Diameter (mm)	152
▪ Min. Bundle Diameter (In.)	.75
▪ Min. Bundle Diameter (mm)	19.1
▪ Min. Loop Tensile Strength (Lbs.)	180
▪ Min. Loop Tensile Strength (N)	800
▪ Pricing Description	Radial Seal Tie, 316 SS, Standard, 23.8" (604mm), .010" (.25mm) thk
▪ Thickness (In.)	.010
▪ Thickness (mm)	.25
▪ Tool	MTRTLS
▪ Min. Order UOM	PC
▪ Min. Order Qty.	100
▪ BOM Qty. (# of Pkgs.)	

THIS COPY IS PROVIDED ON A RESTRICTED BASIS AND IS NOT TO BE USED IN ANY WAY DETRIMENTAL TO THE INTERESTS OF PANDUIT CORP.

PANDUIT PART NO.	PACKAGE QTY.	MAX. BUNDLE DIAMETER	LENGTH "L" ±.3" [ 7 ]
MRS1S-C6	100	1" [ 25 ]	8.1" [ 205 ]
MRS2S-C6	100	2" [ 51 ]	11.3" [ 287 ]
MRS4S-C6	100	4" [ 102 ]	17.6" [ 447 ]
MRS6S-C6	100	6" [ 152 ]	23.8" [ 604 ]

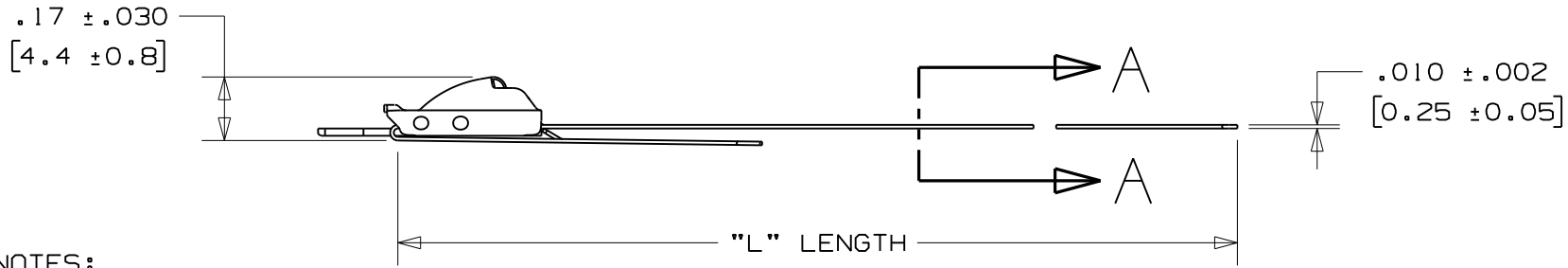
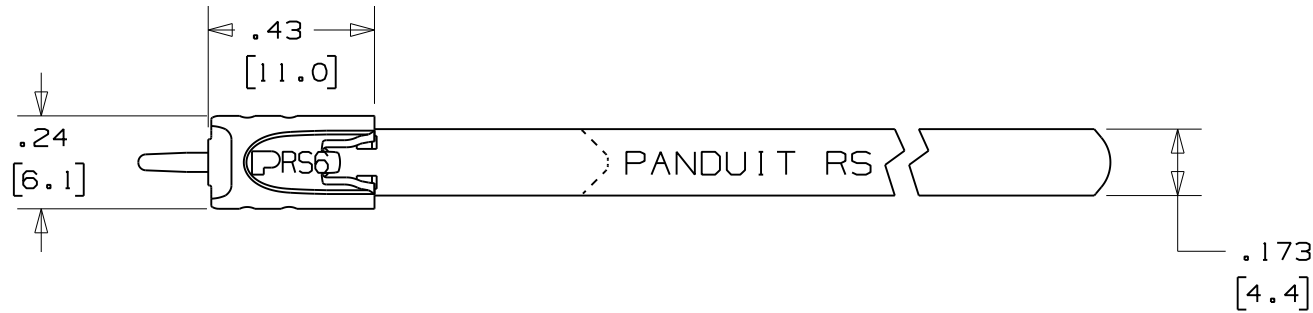

NOTES:

- 1.) APPLICATION TOOLS - MRTLS
- 2.) MINIMUM LOOP TENSILE STRENGTH - 180 LBS. (800 NEWTONS) WHEN TESTED ON A 1.5" MANDREL.
- 3.) [ ] DENOTES DIMENSION IN MILLIMETERS
- 4.) TOLERANCES:  
 .XXX = ±.010 [ .25 ]  
 .XX = ±.02 [ .5 ]  
 .X = ±.03 [ .8 ]  
 ANGLES = ±2°
- 5.) MATERIAL: 316 STAINLESS STEEL

FULLY ROUNDED EDGES  
ALONG STRAP BODY

SECTION A - A

N41256BS\_DC/02A

REV	DATE	BY	CHK	DESCRIPTION	DRAWN BY	CHK'D	SCALE	DRAWING NO.
02A	7/07	JAMB	EJD	TYPO ERROR ON HEAD STAMP MARKING CHANGED FROM RS4 TO RS6	JAMB	EJD	2:1	N41256BS
01	6/07	JAMB	EJD	APPLICATION TOOLS WERE MRT1 & PRT1				
00	6/07	JAMB	EJD	DRAWING RELEASED				

TM

TINLEY PARK, ILLINOIS

METAL TIE - STANDARD SERIES  
RETAINED TENSION - 360° RADIAL SEAL  
316 STAINLESS STEEL