

D

C

B

A

4

4

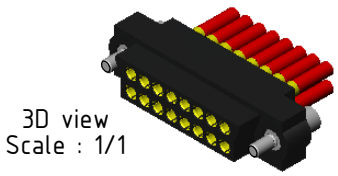
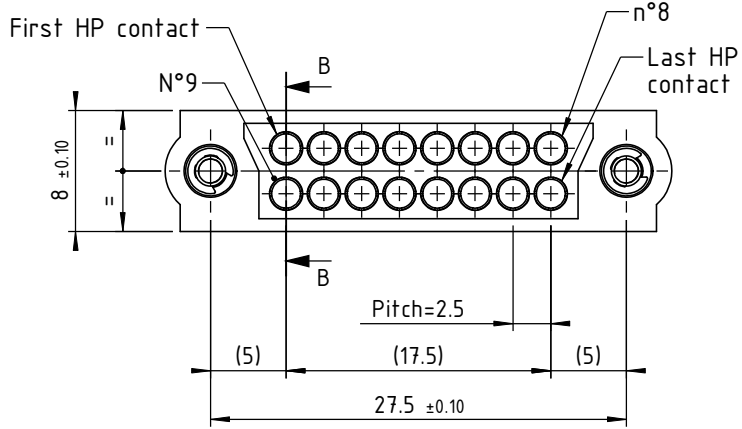
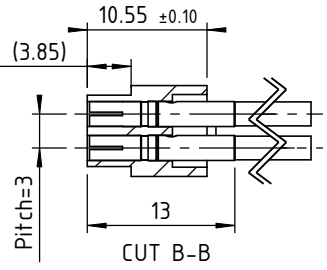

WIRES SPECIFICATION
 MIL-W-22759/11
 AWG16 Red
 Standing : 19x29
 Finished Diameter: 1.95 mm max. (0.076 inch)
 Conductor : Silver coated copper
 Insulation : Extruded PTFE
 Temperature Rating : 200°C
 Voltage Rating : 600 V

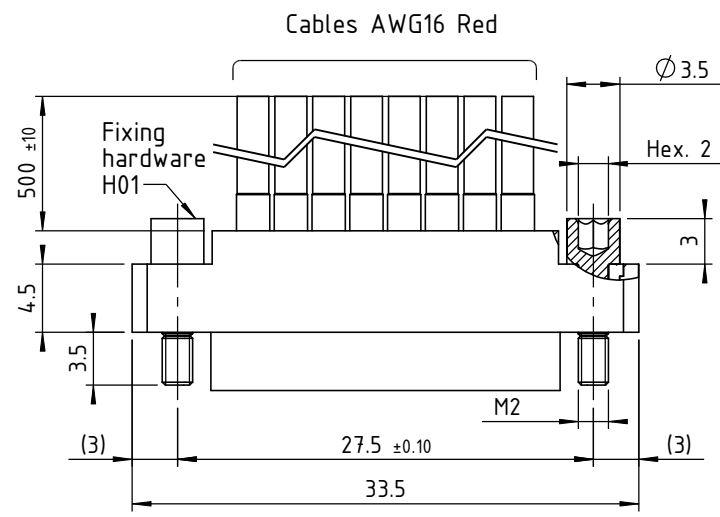

TECHNICALS FEATURES

MATERIALS

INSULATOR : Special PPS (Polyphenylene Sulfide Fibreglass filled thermoplastic) UL 94-V0

- Radiation resistance
- No humidity absorption
- Oxygen free

Note : PPS characteristics are recognized for space applications

FIXING HARDWARE :

- Jackscrew : Stainless steel

TECHNICAL FEATURES for 22 HP CONTACTS

MATERIAL

- Body : Copper alloy Ni + Au 0.5µ

MECHANICAL

- Endurance : 2500 cycles min.
- Insertion force : From 0.60 to 5N per contact
- Extraction force : From 0.50 to 2N per contact
- Secure overlapping : 1.30 mm
- Contact replacement : 5 cycles

ELECTRICAL

- Intensity : 10 A
- Contact resistance : max. 6 mΩ
- Maximum voltage (sea level) : 1000 V (RMS)
- Operating voltage (sea level) : 180 V AC/500 mA

ENVIRONMENTAL

- Temperature range : From -60°C to +260°C
- Vibration severity : 0.75mm, 10 g RMS 6 hours long random with superimposed sinusoid. No intermittencies measured when using an H.S.L.I. (High Speed Logic Interrupt) detector with a trip threshold of 2 ns
- Salt spray test : 96 hrs
- Humidity test : 56 days @ 90% humidity



Tooling recommended

| Désignation | Part number |
|--------------------------------|------------------|
| HP series contacts removal | C13997 |
| Daniels HX3 tool & positionner | C14923 (Hex 1.9) |

HP contact
22-4310 AWG16
scale : 3 : 1

Crimping referee cable instruction IC22HP01
 Soldering referee page 100 of CMM catalogue
 Marking referee page 12-13 of CMM catalogue

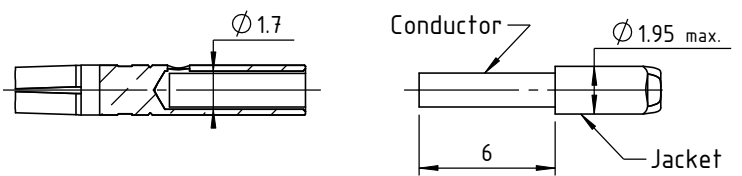

| | | | | | |
|---|-----|----------|-------|---------|----------|
| www.nicomatic.com Mail : nicomatic@nicomatic.fr Tel : +33 (0)4.50.36.13.85 | 2 | 11/09/08 | C.G. | E.M. | D.Z. |
| | Iss | Date | Drawn | Checked | Approved |
| Item : Female harness 342E000H01-0016-4310 Lg 500mm Connector CMM340 F, 16 HP contacts 30-4310, H01 | | | | | |
| Folder : X:\Méthodes\Plans clients\Plans clients 2D\17 - Cablage\2 - Câblage avec contacts spéciaux\HF30004J2A500_cl | | | | | |

This document and drawings, sketches, and schematic drawings are the property of the NICOMATIC company, and no parts thereof may be reproduced and used without the written consent of the owner. Law dated 11.03.1902

Catalogue Reference : HF30004 J2A500

| | | | | | | |
|--|-------------------|------|-------|-----|------|-----|
| | General tolerance | ±0.2 | Scale | 2:1 | Page | 1/1 |
|--|-------------------|------|-------|-----|------|-----|

D

A4

3

3

2

2

1

1