



TECHNICAL FEATURES

MATERIALS

INSULATOR : Special PPS (Polypropylene Sulfide Fiberglass filled thermoplastic) UL 94-V0

- Radiation resistance
- No humidity absorption
- Oxygen free

Note : PPS characteristics are recognized for space application

FIXING HARDWARE :

- Jackscrew : Stainless steel

TECHNICAL FEATURES for 22 HF CONTACTS

MATERIAL

- Body : Copper alloy Ni + Au 0.5 μ
 - Inner contact : Copper alloy Cu + Ni + Au 0.75 μ
 - Insulator : PTFE
- Do not complies with radiation**

MECHANICAL

- Mechanical operations : 2500 cycles min.
- Insertion force : From 0.60 to 5N per contact
- Withdrawal force : From 0.50 to 2N per contact
- Secure overlapping : 1.30 mm
- Contact replacement in insulator : 5 cycles

ELECTRICAL

- Impedance : 50 Ω
- Insulator resistance : 10⁶ m Ω / 250V (RMS)
- SWR (Stationary Wave Rate) : < 1.05 + 0.04 F (GHz)
- Frequency range : 1.5 GHz
- Insulation between 2 contacts : -100dB

ENVIRONMENTAL

- Temperature range : From -60°C to +260°C
- Vibration severity : 0.75mm, 10 g RMS 6 hours long random with superimposed sinusoid. No intermitencies measured when using an H.S.L.I. (High Speed Logic Interrupt) detector with a trip threshold of 2 ns
- Salt spray test : 96 hrs
- Humidity test : 56 days @ 90% humidity

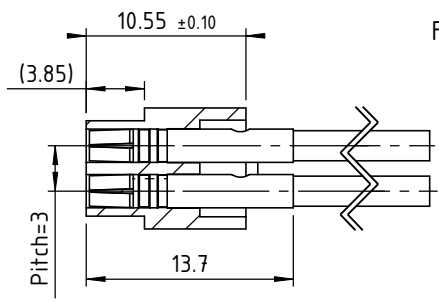

CUT A-A

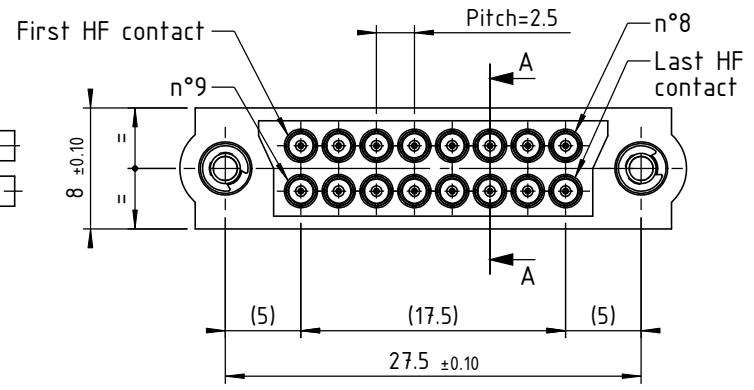

WIRES SPECIFICATION
 MIL-C-17
 RG178
 Standing : 7x0.1
 Finished Diameter : 1.9 mm max.(0.075 inch)
 Conductor : Silver plated copper cover soft steel
 Insulation : Extruded FEP
 Temperature Rating : -55°C to 200°C
 Voltage Rating : 750 V

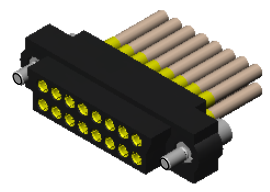

3D view
Scale 1/1

HF contact
22-2320-ZZ RG178
scale : 3 : 1

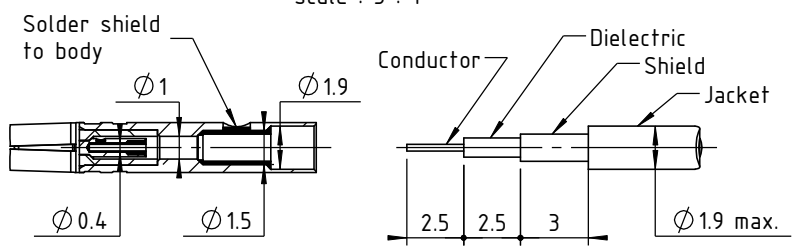
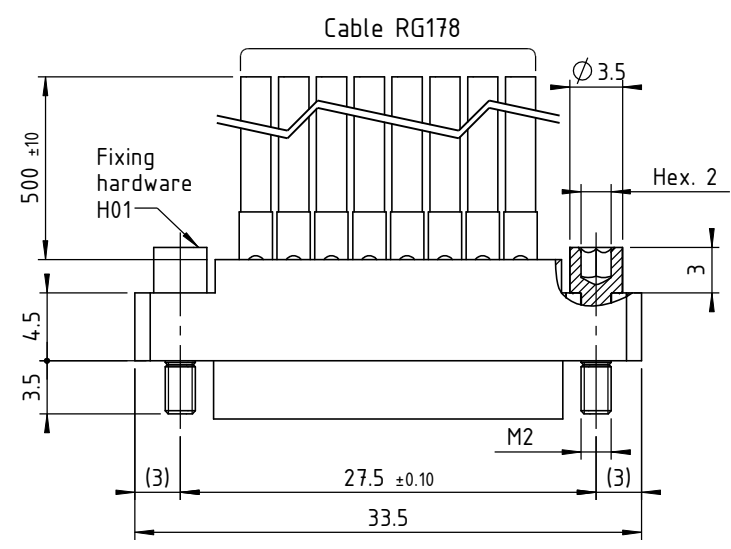

Tooling recommended	
Désignation	Part number
HP series contacts removal	C13997

Soldering referee to page 97 from CMM catalogue
 Marking referee page 12-13 of CMM catalogue

 www.nicomatic.com Mail : nicomatic@nicomatic.fr Tel : +33 (0)4.50.36.13.85	2	11/09/08	C.G.	E.M.	D.Z.
	Iss	Date	Drawn	Checked	Approved
Item : Female Harness 342E000H01-0016-2320ZZ Lg 500mm Connector CMM340 F, 16 HF contacts 22-2320-ZZ, H01					

This document and drawings, sketches, and schematic drawings are the property of the NICOMATIC company. and no parts thereof may be reproduced and used without the written consent of the owner. Law dated 11.03.1902

Catalogue Reference : HF10005ABA500

	General tolerance	±0.2	Scale	Page
			2:1	1/1

4
3
2
1

4
3
2
1