

HARNESS PRO SERIES H106 FEMALE

Contacts number nn	Length without latches in mm	
	A	B
02	2	7
03	4	9
04	6	11
05	8	13
06	10	15
07	12	17
08	14	19
09	16	21
10	18	23
11	20	25
12	22	27
13	24	29
14	26	31
15	28	33
16	30	35
17	32	37
18	34	39
19	36	41
20	38	43
21	40	45
22	42	47
23	44	49
24	46	51
25	48	53

CABLE COLOR

Black : 0 / Brown : 1
 Red : 2 / Orange : 3
 Yellow : 4 / Green : 5
 Blue : 6 / Violet : 7
 Gray : 8 / White : 9

H 1 0 6 S n n D 6 A 5 0 0

Contacts number

Cable length in mm

AWG
 24 : E
 26 : D
 28 : C

NORM
 A : MIL-W-22759/11
 B : « »

Ce plan est la propriété exclusive de la société NICOMATIC.
 Il ne peut être reproduit sans son autorisation. Loi du 11.03.1902.

This document and drawings, sketches, and schematic drawings are the property of the NICOMATIC company, and no parts thereof may be reproduced and used without the written consent of the owner.
 Law dated 11.03.1902

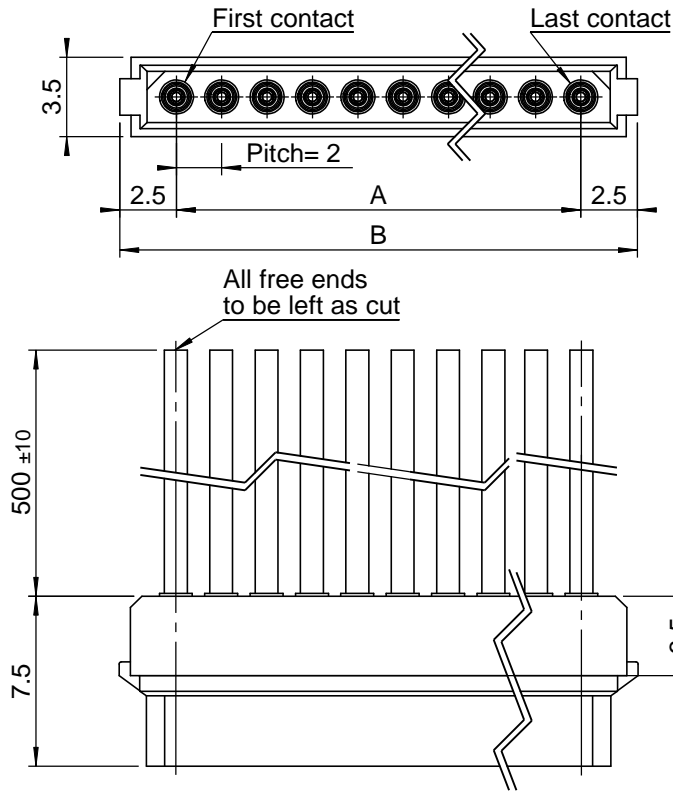

WIRES SPECIFICATION

MIL-W-22759/11
 AWG26 Blue
 Standing : 19 x 38
 Finished Ø : 1.02mm max.(0.04 inch)
 Conductor : Silver coated copper
 Insulation : Extruded PTFE
 Temperature Rating : 200°C
 Voltage Rating : 600V

TECHNICAL FEATURES

MATERIALS

INSULATOR : Glass filled thermoplastic UL 94-V0

CRIMPING SIGNAL CONTACTS :

Female : Beryllium copper / 0.3µ gold on clip
 Brass / 3µ to 5µ 100% tin plated on shell over Ni under plate

ELECTRICAL

- All contacts: 3 A max. @ 25°C
2.2 A max. @ 85°C
- Working / Rated voltage (sea level): 300V AC/DC
- Proof / Withstanding voltage: 400V AC/DC
- Contact resistance (initial): max. 20 mΩ
- Contact resistance (after conditioning): max. 25 mΩ
- Insulation resistance (initial): 1000 MΩ min

MECHANICAL

- Mechanical operations: 500 cycles.
- Contact insertion and withdrawal force: 2N max. / 0.2 N min.
- Contact retention in insulator: 10N min.

ENVIRONMENTAL

- Temperature range: From -55°C to +125°C
Peak Reflow Compatible 260°C
- RoHS: Yes

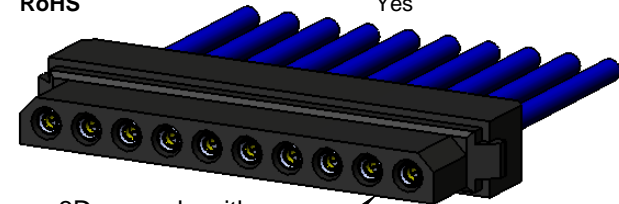

3D example with P/N H106S10D6A500



173, rue des fougères
 Z.I. Les Bracots
 F-74890 Bons-en-Chablais
 Tel. : +33 (0)4.50.36.13.85
 Fax : +33 (0)4.50.36.11.33
 Web : www.nicomatic.com

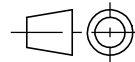

Echelle/Scale

3:1

a	19/05/08	H.T.		D.Z.
Ind	Date	Drawn	Checked	Approved

**Désignation : Harness CMM100 Pro series
 Female AWG26 blue 500mm**

H106SnnD6A500_cl

**Réf. catalogue /
 Catalogue Reference H106SnnD6A500**

Tolérance générale /
 General tolerance ±0.2

Page 1/1

A4