

FEATURES AND SPECIFICATIONS

Features and Benefits

- RJ-45 version meets Category 5 for Fast Ethernet
- Plug latch on top
- Shortened leads with bottom contacts
- Pin and paste solderability
- Shielding meets IEC 950, UL 1863 and CSA 233
- Enhanced panel grounding tabs on shield
- Continuity

Reference Information

Product Specification: PS-43860-001

Packaging:

Unshielded—Tube

Shielded—Tray

UL File No.: E107635

CSA File No.: LR19980

Mates With: FCC 68 plugs

Designed In: Inches

Electrical

Voltage: 125V

Current: 1.5A

Contact Resistance: 10mΩ max.

Dielectric Withstanding Voltage: 1000V AC

Insulation Resistance: 500 MΩ min.

Mechanical

Durability: 500 cycles min.

Physical

Housing: Black glass-filled, high-temperature nylon, UL 94V-0

Contact: Gold per FCC 68.5 specification

Plating: 1.27μm (50μ") min. Gold in contact area and 1.27μm (50μ") Tin/Lead on solder tails both over Nickel overall

Operating Temperature: -40 to +80°C

molex® Modular Jack

43860

**Right Angle, Low Profile
Inverted, Shielded and
Unshielded Versions**

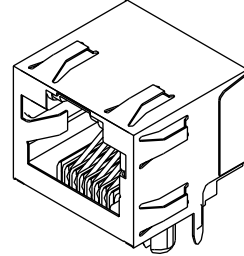

CATALOG DRAWING (FOR REFERENCE ONLY)

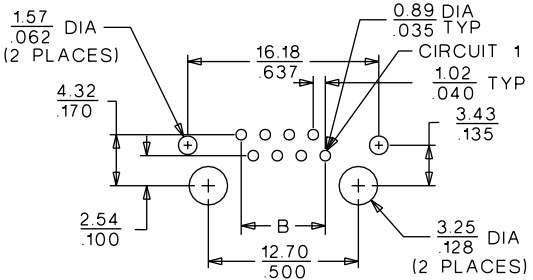
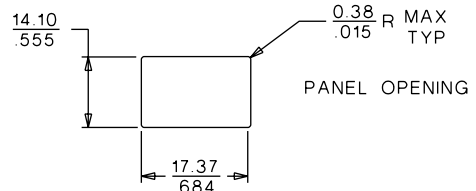
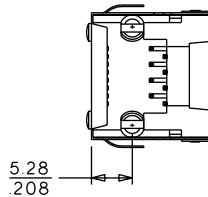
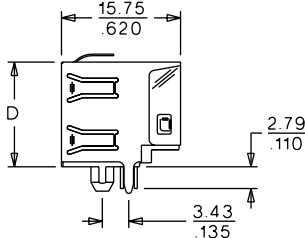
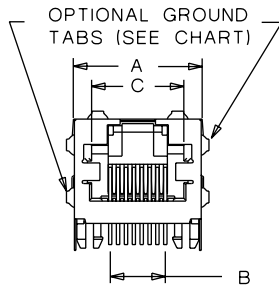

PCB LAYOUT : COMPONENT SIDE
RECOMMENDED PCB THICKNESS : 1.57 / .062

ORDERING INFORMATION AND DIMENSIONS

| Circuits | Loaded Contacts | Order No. | | Dimension | | | | |
|----------|-----------------|------------|-------------------------------|----------------------------------|--------------|-------------|--------------|--------------|
| | | Unshielded | Shielded | | A | B | C | D |
| | | | With All Panel Grounding Tabs | With Offset Panel Grounding Tabs | | | | |
| 6 | 2 | 43860-0020 | | | 15.75 (.620) | 1.02 (.040) | 9.88 (.389) | 13.21 (.520) |
| 6 | 4 | 43860-0003 | | | 15.75 (.620) | 3.05 (.120) | 9.88 (.389) | 13.21 (.520) |
| 6 | 4 | | 43860-0006 | | 16.38 (.645) | 3.05 (.120) | 9.88 (.389) | 13.54 (.533) |
| 6 | 4 | | | 43860-0015 | 16.38 (.645) | 3.05 (.120) | 9.88 (.389) | 13.54 (.533) |
| 6 | 6 | 43860-0002 | | | 15.75 (.620) | 5.08 (.200) | 9.88 (.389) | 13.21 (.520) |
| 6 | 6 | | 43860-0005 | | 16.38 (.645) | 5.08 (.200) | 9.88 (.389) | 13.54 (.533) |
| 6 | 6 | | | 43860-0014 | 16.38 (.645) | 5.08 (.200) | 9.88 (.389) | 13.54 (.533) |
| 8 | 8 | 43860-0001 | | | 15.75 (.620) | 7.11 (.280) | 11.91 (.469) | 13.21 (.520) |
| 8 | 8 | | 43860-0004 | | 16.38 (.645) | 7.11 (.280) | 11.91 (.469) | 13.54 (.533) |
| 8 | 8 | | | 43860-0013 | 16.38 (.645) | 7.11 (.280) | 11.91 (.469) | 13.54 (.533) |