

Switch Language

English

Need Assistance?

Contact Us  
Find a Distributor  
Order Samples  
Tech Library

Printer-friendly page

Email this page

[Home](#)   [Crimp Housings](#)   [Datasheet](#)

**Part Number:** 0039012060

**Status:** Active    **Overview:** [Mini-Fit Jr.™](#)

**Description:** 4.20mm (.165") Pitch Mini-Fit Jr.™ Receptacle Housing, Dual Row, UL 94V-2, 6 Circuits

**Documents:**

*Note - Please disable browser pop-up blockers for documents on www.molex.com*

- [Drawing \(PDF\)](#)    [Product Specification PS-5557-003 \(PDF\)](#)
- [Product Specification PS-5557-004 \(PDF\)](#)    [Product Specification PS-5557-010 \(PDF\)](#)
- [Product Specification PS-5557-011 \(PDF\)](#)    [Product Specification PS-5557-012 \(PDF\)](#)
- [Product Specification PS-5557-013 \(PDF\)](#)    [Product Specification PS-5557-015 \(PDF\)](#)
- [Product Specification PS-5557-016 \(PDF\)](#)    [Product Specification PS-5557-021 \(PDF\)](#)
- [Product Specification PS-5557-039 \(PDF\)](#)    [Product Specification PS-5557-040 \(PDF\)](#)
- [Product Specification PS-5557-041 \(PDF\)](#)    [Product Specification PS-5557-042 \(PDF\)](#)
- [Product Specification PS-5557-043 \(PDF\)](#)    [Product Specification PS-5557-044 \(PDF\)](#)
- [3D Model](#)    [Test Summary \(PDF\)](#)
- [Related Catalog Page \(PDF\)](#)

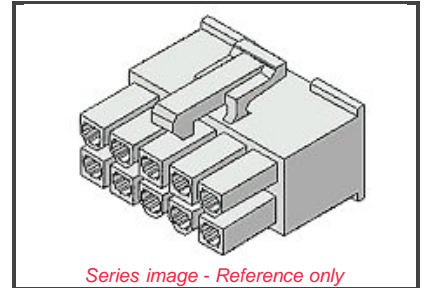

**EU RoHS**    **China RoHS**  
**ELV and RoHS Compliant**



**Need more information on product compliance?**

Email [productcompliance@molex.com](mailto:productcompliance@molex.com)

Please visit the [Contact Us](#) section for any non-product compliance questions.

**Order Products:**

[Check Distributor Inventory](#)    [Add to My Parts](#)  
[Request Samples](#)

**Part Detail:** ([show all](#))

[General](#)   [Physical](#)   [Electrical](#)   [Material Info](#)

**General**

Product Family    Crimp Housings  
Series    [5557](#)  
Comments    Glow Wire Equivalent Part Number [50361672](#)  
Overview    [Mini-Fit Jr.™](#)  
Product Name    Mini-Fit Jr.™

**Physical**

Breakaway    No  
Circuits (maximum)    6  
Color - Resin    Natural  
Flammability    94V-2  
Gender    Female  
Material - Resin    Nylon  
Number of Rows    2  
Packaging Type    Bag  
Panel Mount    No  
Pitch - Mating Interface (in)    0.165 In  
Pitch - Mating Interface (mm)    4.20 mm  
Pitch - Term. Interface (in)    0.165 In  
Pitch - Term. Interface (mm)    4.20 mm

**Search Parts in this Series**

[5557](#) Series

**Mates With**

[5559d](#), [5566vw](#), [5566vwo](#), [5569rdf](#),  
[5569rdp](#), [43810a](#), [43810b](#), [43810c](#),  
[43810d](#), [44068a](#), [44068b](#), [44068c](#),  
[44068d](#), [44281](#), [44472dw](#), [44472dwo](#),  
[87427](#), [87427r](#), [87427rf](#), [42404](#),  
[44474](#), [42440](#), [43879](#), [42475](#)

**Use With**

[41995](#) Strain Relief

Polarized to Mating Part	Yes
Stackable	No
Temperature Range - Operating	-40°C to +105°C

**Electrical**

CSA	LR19980
TUV	R75142
UL	E29179

**Material Info**

Old Part Number	5557-06R
-----------------	----------

**Reference - Drawing Numbers**

Product Specification	PS-5557-003
Product Specification	PS-5557-004
Product Specification	PS-5557-010
Product Specification	PS-5557-011
Product Specification	PS-5557-012
Product Specification	PS-5557-013
Product Specification	PS-5557-015
Product Specification	PS-5557-016
Product Specification	PS-5557-021
Product Specification	PS-5557-039
Product Specification	PS-5557-040
Product Specification	PS-5557-041
Product Specification	PS-5557-042
Product Specification	PS-5557-043
Product Specification	PS-5557-044
Sales Drawing	SD-5557-003

10 9 8 7 6 5 4 3 2 1

**NOTES**

1. TERMINAL : 5556 SERIES
2. MATE WITH : 5559 SERIES  
5566 SERIES  
5569 SERIES  
501566 SERIES
3. (METRIC) VALUES SHOWN GOVERN OVER ENGLISH CONVERSION VALUES.  
A TO BE MEASURED AT POSITION OF D SURFACE.

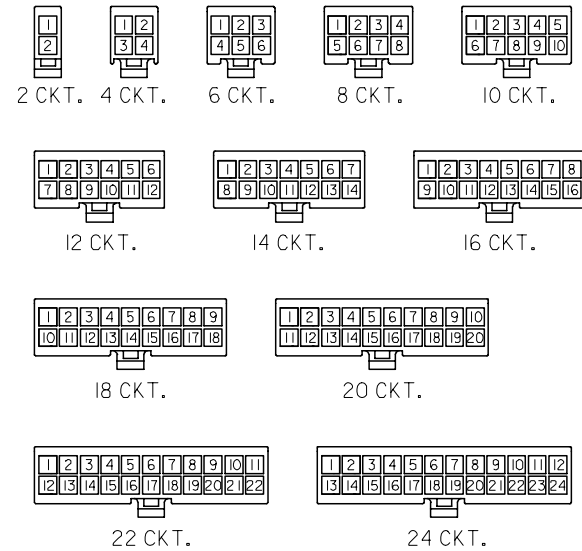

**CIRCUIT SIZE LAYOUT**  
(SCALE 1:1)

(3.6) .142	(51.6) 2.031	(46.2) 1.819	39-01-2240	5557-24R	24
	(47.4) 1.866	(42) 1.654	↑ -2220	↑ -22R	22
(3.3) .129	(43.2) 1.701	(37.8) 1.488	-2200	-20R	20
	(39) 1.535	(33.6) 1.323	-2180	-18R	18
	(34.8) 1.37	(29.4) 1.158	-2160	-16R	16
	(30.6) 1.205	(25.2) .992	-2140	-14R	14
	(26.4) 1.039	(21) .827	-2120	-12R	12
	(22.2) .874	(16.8) .661	-2100	-10R	10
	(18) .709	(12.6) .496	-2080	-08R	8
	(13.8) .543	(8.4) .331	-2060	-06R	6
	(9.6) .378	(4.2) .165	↓ -2040	↓ -04R	4
	(5.4) .213	—	39-01-2020	5557-02R	2

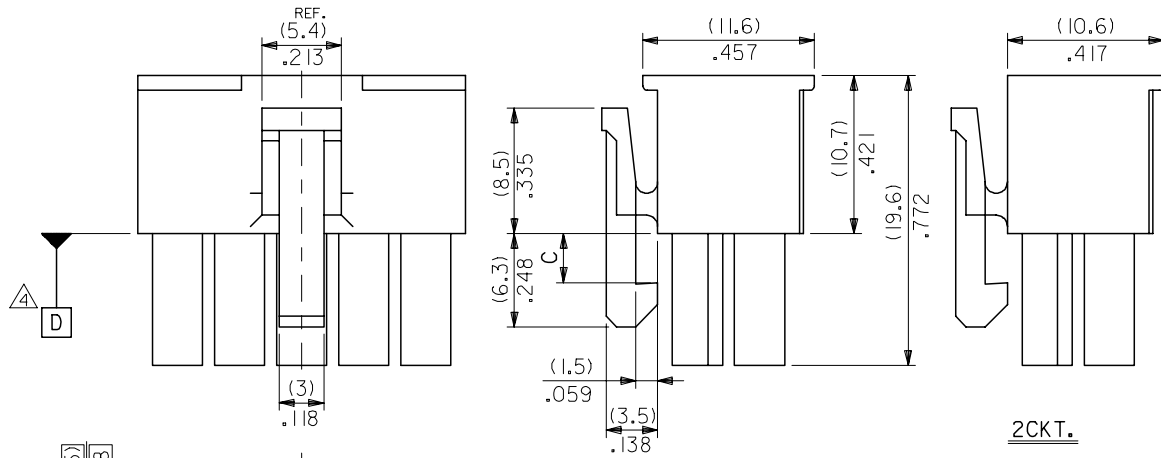
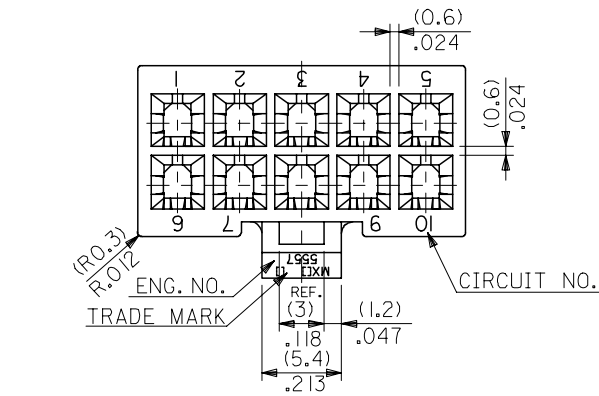

4~24CKT.

材料 MATERIAL	66NYLON (UL94V-2)
仕上り FINISH	—
適用電線範囲 WIRE RANGE	—
被覆外径 NS. RANGE	—

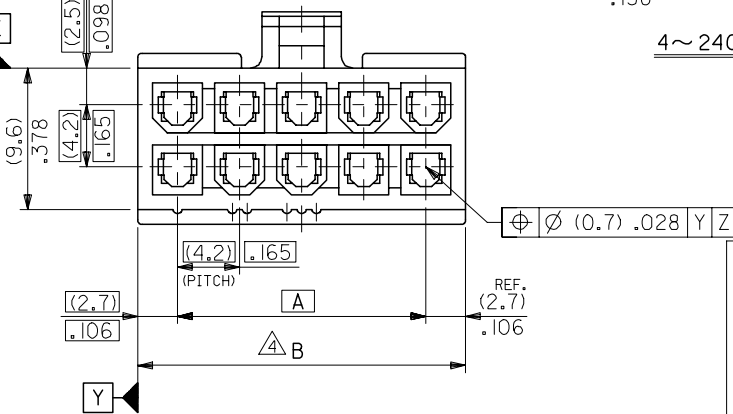

REVISED EC NO: J2005-3799 DRW: NABEI CHK: KATOYODA APP: NUKITA	DESCRIPTION 2005/06/20 2005/06/21 2005/06/27	GENERAL TOLERANCES (UNLESS SPECIFIED)		DIMENSION STYLE MM ONLY		SCALE 3:1	DESIGN UNITS METRIC	THIRD ANGLE PROJECTION	
		10 UNDER	±0.2	DRAWN BY S. MOCHIZUKI	DATE '90/02/22	TITLE NEW MINI FIT CONN REC. HOUSING			
		10 OVER 30 UNDER	±0.3	CHECKED BY M. FUKUSHIMA	DATE '97/01/08	MOLEX INCORPORATED			
		30 OVER	±0.4	APPROVED BY M. FUKUSHIMA	DATE '97/01/08	SHEET NO. 2 OF 2			
ANGULAR ±3 °		DRAFT WHERE APPLICABLE MUST REMAIN WITHIN DIMENSIONS		MATERIAL NO. SEE CHART		DOCUMENT NO. SD-5557-003		INCORPORATED AND SHOULD NOT BE USED WITHOUT WRITTEN PERMISSION	