

Switch Language

English

Need Assistance?

- Contact Us
- Find a Distributor
- Order Samples
- Tech Library

Printer-friendly page

Email this page

[Home](#) [Quick Disconnects](#) [Datasheet](#)

Part Number: 0190160111

Status: Active

Description: Krimptite™ Quick Disconnect, Female, for 14-16 (2.00-1.30) Wire, Box, Tab 6.35mm (.250") x 0.81mm (.032")

Documents:

Note - Please disable browser pop-up blockers for documents on www.molex.com

[Drawing \(PDF\)](#)

[Related Catalog Page \(PDF\)](#)

Order Products:

[Check Distributor Inventory](#)

[Add to My Parts](#)

[Request Samples](#)

Part Detail: [\(show all\)](#)

[General](#) [Physical](#) [Electrical](#) [Material Info](#)

General

Product Family	Quick Disconnects
Series	19016
Comments	Butted Seam
Product Name	Krimptite™
Type	Quick Disconnect

Physical

Barrel Type	Closed
Gender	Female
Insulation	None
Lock to Mating Part	None
Material - Metal	Brass
Orientation	Straight
Packaging Type	Bag
Polarized to Mating Part	No
Tab Thickness	0.81mm (.032")
Tab Width	6.35mm (.250")
Temperature Range - Operating	Per Wire Specification
Wire Size AWG	14
Wire Size AWG	16
Wire Size mm ²	1.30 - 2.00

Electrical

CSA	LR18689
UL	E79133
Voltage - Maximum	PER WIRE SPECIFICATION

Material Info

Old Part Number	BB-1141
-----------------	---------

Reference - Drawing Numbers

Sales Drawing	SD-19016-003
---------------	--------------

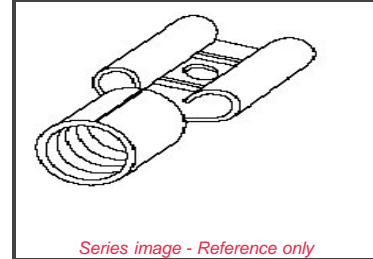

Series image - Reference only

EU RoHS

ELV and RoHS Compliant



China RoHS

Need more information on product compliance?

Email productcompliance@molex.com

Please visit the [Contact Us](#) section for any non-product compliance questions.

Search Parts in this Series

[19016 Series](#)

Application Tooling

Tooling specifications and manuals are found by selecting the products below. Crimp Height Specifications are then contained in the Application Tooling Specification document.

Global

Description	Product #
Hand Crimp Tool	0640031200
Crimp Head for the AT-200™ Pneumatic Hand Tool	0640071200

MATERIAL NUMBER	ENGINEERING NUMBER	CARRIER	FINISH
190160111	BB-1141	LOOSE	TIN PLATING
190160063	BBZ-1141	STRIP	TIN PLATING
190160126	BB-1141-N	LOOSE	NICKEL PLATING

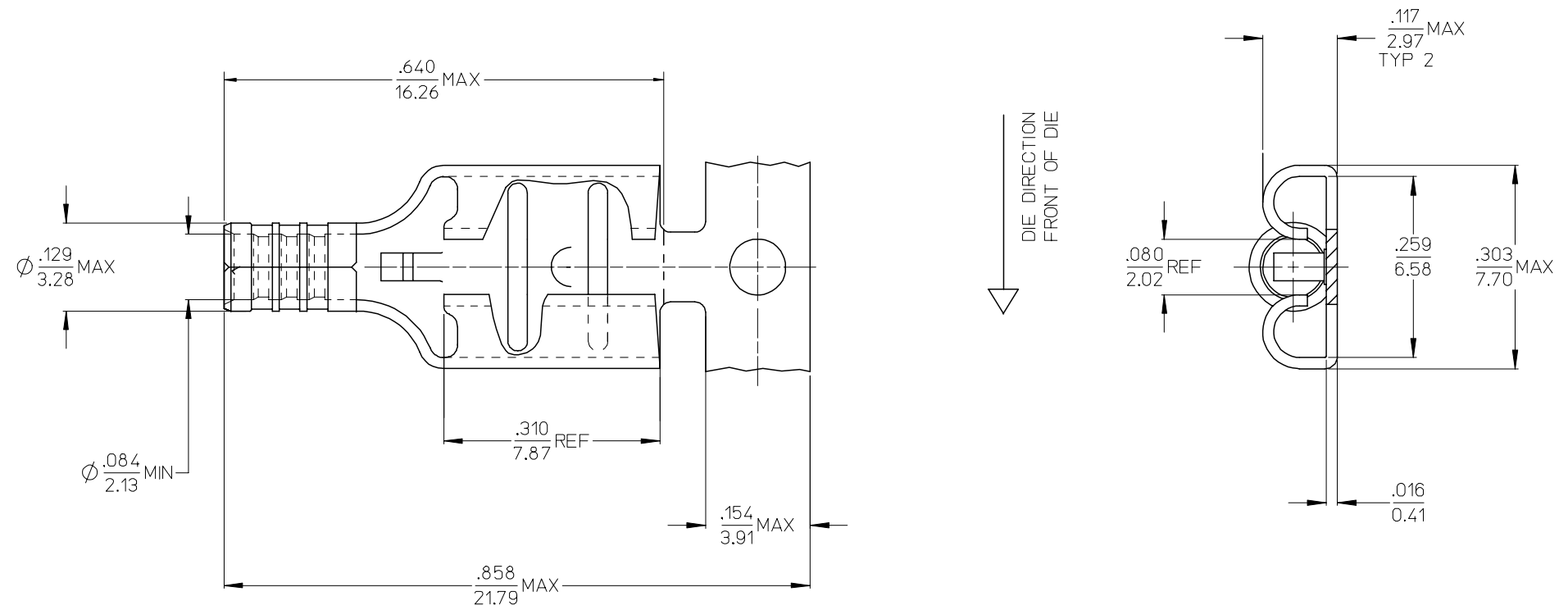

- NOTES:
- ENTIRE PART TO BE FREE OF BURRS AND SHARP EDGES
 - LOOSE PIECE PARTS TO HAVE CUT-OFF TAB .005-.020
 - MATERIAL: 3/4 HARD BRASS

RELEASED EC NO: ETC2006-0143 DRWN:NASAYDEH 2005/12/17 CHKD:RDEROSS 2005/12/19 APPR:RDEROSS 2005/12/14	DESCRIPTION A	QUALITY SYMBOLS	GENERAL TOLERANCES (UNLESS SPECIFIED)	DIMENSION STYLE	SCALE	DESIGN UNITS	THIRD ANGLE PROJECTION															
		$\nabla=0$ $\nabla=0$	<table border="1"> <thead> <tr> <th></th> <th>mm</th> <th>INCH</th> </tr> </thead> <tbody> <tr> <td>4 PLACES</td> <td>± ---</td> <td>± ---</td> </tr> <tr> <td>3 PLACES</td> <td>± ---</td> <td>± .010</td> </tr> <tr> <td>2 PLACES</td> <td>± 0.25</td> <td>± .02</td> </tr> <tr> <td>1 PLACE</td> <td>± 0.3</td> <td>± ---</td> </tr> </tbody> </table>		mm	INCH	4 PLACES	± ---	± ---	3 PLACES	± ---	± .010	2 PLACES	± 0.25	± .02	1 PLACE	± 0.3	± ---	IN/MM	4:1	INCH	
			mm	INCH																		
		4 PLACES	± ---	± ---																		
3 PLACES	± ---	± .010																				
2 PLACES	± 0.25	± .02																				
1 PLACE	± 0.3	± ---																				
	DRAWN BY	DATE	TITLE	QUICK CONNECT RECEPTACLE FOR 16-14 AWG .250X.032 TAB SIZE																		
	CHECKED BY	DATE	MOLEX INCORPORATED																			
	APPROVED BY	DATE	MATERIAL NO.	DOCUMENT NO.	SHEET NO.																	
			SEE CHART	SD-19016-003	1 OF 1																	
			DRAFT WHERE APPLICABLE MUST REMAIN WITHIN DIMENSIONS																			
			THIS DRAWING CONTAINS INFORMATION THAT IS PROPRIETARY TO MOLEX INCORPORATED AND SHOULD NOT BE USED WITHOUT WRITTEN PERMISSION																			