

Allows Inputs to be Jumped to Adjacent Sockets Without Additional Wiring.

- Infinite number of connections.
- Eliminates need to insert stripped jumper wires into terminals.
- Installs quickly.
- NO tools needed.

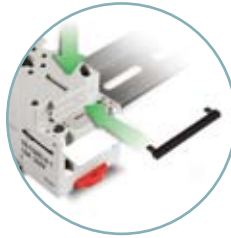

Characteristics	16-782CBJ-1	16-750/788CBJ-1
Description	Internal Coil Bus Jumper System	Internal Coil Bus Jumper System
Function	Wireless Socket Connection	Wireless Socket Connection
Packaging Minimum	20 pieces	20 pieces
Used with these Sockets		
	70-782EL8-1 (Sec. 2, p.14-15)	70-750DL8-1 (Sec. 2, p.30-31)
	70-782EL11-1 (Sec. 2, p.16-17)	70-750DL11-1 (Sec. 2, p.30-31)
	70-782EL14-1 (Sec. 2, p.18-19)	70-750EL8-1 (Sec. 2, p.26-27)
		70-750EL11-1 (Sec. 2, p.26-27)
		70-788EL11-1 (Sec. 2, p.24-25)



Coil Bus Jumpers colored green for better viewing.

16-782CBJ-1

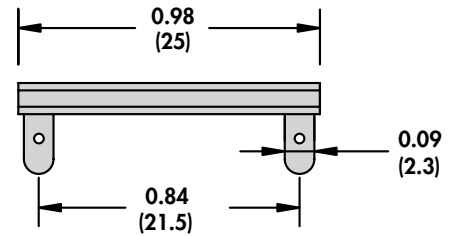
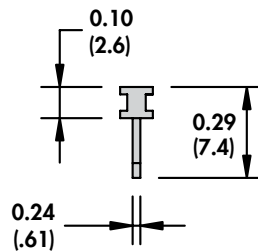

16-750/788CBJ-1

