



We Tame Photons to Work for You!



Products > High Power LEDs > SuperBeamLED



Features / Options

- ▶ State-of-the-Art, High Brightness Chip Technology
- ▶ Choice of Colors and Lens Finishes
- ▶ Maintenance Free Long Life

Applications / Uses

- ▶ Flashlights
- ▶ Illuminating Signs/Artwork
- ▶ Decorative Lighting
- ▶ Backlighting

| Part Number: | Brightness | Dice Material | Emitted Color | Peak Wavelength | Epoxy Lens | Operating Typ Vf (V) | Intensity Typ, mcd @ 20 mA | View Angle 2x Theta | | |
|-------------------|------------|---------------|---------------|-----------------|------------|----------------------|----------------------------|---------------------|--|---|
| SSL-LX100T123SIC | High | AlInGaP | Red | 630 | Clear | 2.0 | 35 lm | 25 | | — |
| SSL-LX100T123SYC | High | AlInGaP | Yellow | 590 | Clear | 2.0 | 35 lm | 25 | | — |
| SSL-LX100T123UPGC | High | InGaN | Green | 525 | Clear | 3.5 | 55 lm | 25 | | — |

UNCONTROLLED DOCUMENT

SC:0.50

PART NUMBER

REV.

SSL-LX100T123SIC

PRELIMINARY IN P/N DIR

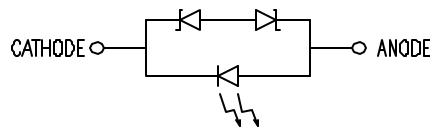
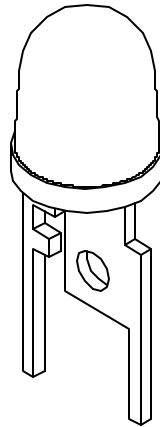
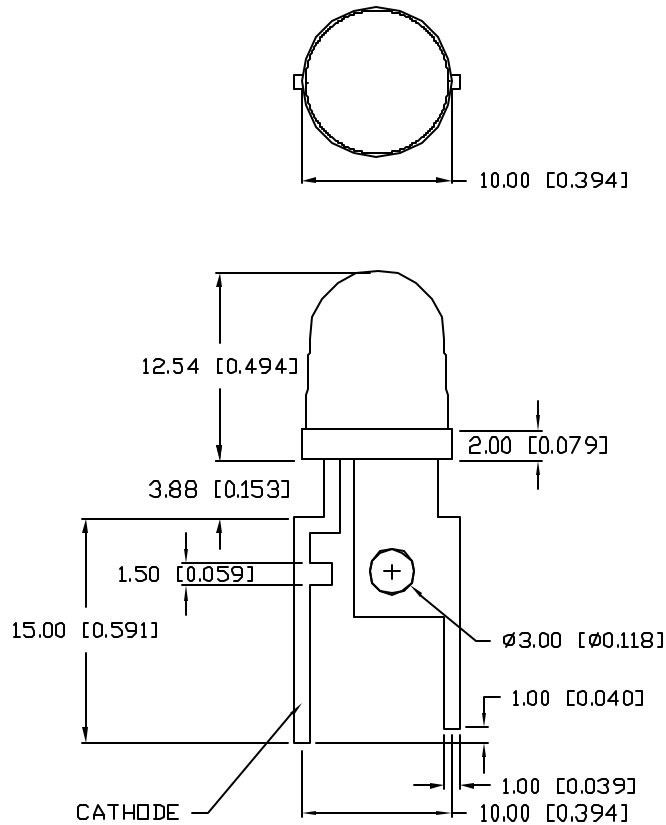

ELECTRO-OPTICAL CHARACTERISTICS $T_A=25^{\circ}\text{C}$

| PARAMETER | SYMBOL | MIN | TYP | MAX | UNITS | TEST COND |
|--------------------|--------|-----|-----|-----|------------|---------------------|
| PEAK WAVELENGTH | | | 636 | | nm | |
| FORWARD VOLTAGE | V_f | | 2.0 | 3.0 | V | $I_f=350\text{mA}$ |
| REVERSE VOLTAGE | V_r | 5 | | | V | $I_r=10\mu\text{A}$ |
| AXIAL INTENSITY | I_v | 27 | | 45 | lm | $I_f=350\text{mA}$ |
| VIEWING ANGLE | | | 25 | | $2x$ theta | |
| EMITTED COLOR: | RED | | | | | |
| EPOXY LENS FINISH: | CLEAR | | | | | |

LIMITS OF SAFE OPERATION AT 25°C

| PARAMETER | MAX | UNITS |
|----------------------------------|------------|------------------------|
| PEAK FORWARD CURRENT* | 500 | mA |
| STEADY CURRENT | 350 | mA |
| POWER DISSIPATION | 1.4 | W |
| DERATE FROM 25°C | -1.2 | mW/ $^{\circ}\text{C}$ |
| OPERATING, STORAGE TEMP. | -40 TO +85 | $^{\circ}\text{C}$ |
| SOLDERING TEMP. | 260 | $^{\circ}\text{C}$ |
| 2.0mm FROM BODY | 3 | SEC |

* $t < 10\mu\text{s}$

*UNLESS OTHERWISE SPECIFIED TOLERANCES PER DECIMAL PRECISION ARE: X=±1 (±0.039), XX=±0.5 (±0.020), XXX=±0.25 (±0.010), XXXX=±0.127 (±0.005). LEAD SIZE=±0.05 (±0.002), LEAD LENGTH=±0.75 (±0.030), MIN= ^{+0.00} -0.00, MAX= ^{+0.00} -DECIMAL PRECISION

UNCONTROLLED DOCUMENT



REV.

PART NUMBER

SSL-LX100T123SIC

CONFIDENTIAL INFORMATION

THE INFORMATION CONTAINED IN THIS DOCUMENT IS THE PROPERTY OF LUMEX INC. EXCEPT AS SPECIFICALLY AUTHORIZED IN WRITING BY LUMEX INC, THE HOLDER OF THIS DOCUMENT SHALL KEEP ALL INFORMATION CONTAINED HEREIN CONFIDENTIAL AND SHALL PROTECT SAME IN WHOLE OR IN PART FROM DISCLOSURE AND DISSEMINATION TO ALL THIRD PARTIES.



RELIABILITY NOTE

OUR MANY YEARS OF EXPERIENCE DATA ACCUMULATION INDICATE THAT SOLDER HEAT IS A MAJOR CAUSE OF EARLY AND FUTURE FAILURE. PLEASE PAY ATTENTION TO YOUR SOLDERING PROCESS.

ø10.00mm 1 WATT THROUGH HOLE, HIGH POWER LED,
636nm AlInGaP RED LED, WATER CLEAR LENS.

DRAWN BY:

JN

CHECKED BY:

APPROVED BY:

DATE: 12.19.07

PAGE: 1 OF 1

SCALE: N/A