



E-Chain®  
Cable Carrier System



Chainflex®  
flexible cable



ReadyChain®  
harnessed systems



iglide®  
polymer bearings



Drylin® linear  
bearings & slides



igubal®  
spherical bearings

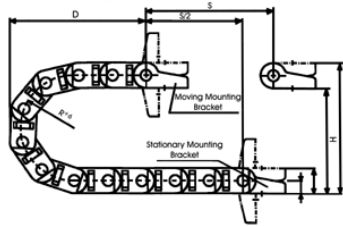

**Series E06: Please select a Part Number Inch Version**

Part Number	Inner Width	Outer Width	Radius	Curve Height H	Curve Length K	Weight
<a href="#">E06-10-018-0</a>	0.39 in	0.65 in	.71 in	2.04 in	3.94 in	0.09 lbs/ft
<a href="#">E06-10-028-0</a>	0.39 in	0.65 in	1.10 in	2.83 in	5.51 in	0.09 lbs/ft
<a href="#">E06-10-038-0</a>	0.39 in	0.65 in	1.50 in	3.62 in	6.3 in	0.09 lbs/ft
<a href="#">E06-16-018-0</a>	0.63 in	0.89 in	.71 in	2.04 in	3.94 in	0.11 lbs/ft
<a href="#">E06-16-028-0</a>	0.63 in	0.89 in	1.10 in	2.83 in	5.51 in	0.11 lbs/ft
<a href="#">E06-16-038-0</a>	0.63 in	0.89 in	1.50 in	3.62 in	6.3 in	0.11 lbs/ft

2 Widths and  
3 Bending Radii



Mounting brackets with  
and without tie-wrap  
plates



Quickfix: mounting  
bracket with dowel  
Call for availability



Quicksnap: the  
complete unit, detach-  
able by hand  
Call for availability



Very easy to install cables and  
hoses – ideal for applications  
with pre-assembled connectors

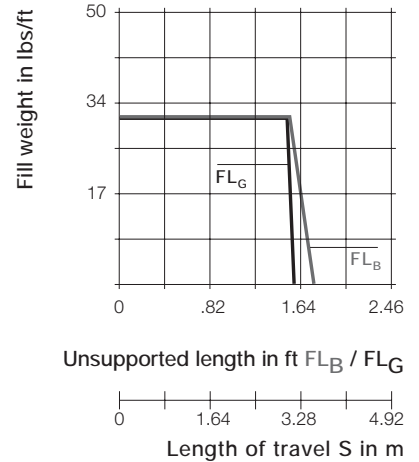

Unsupported length

- FL<sub>B</sub> = unsupported with permitted sag
- FL<sub>G</sub> = unsupported with straight upper run

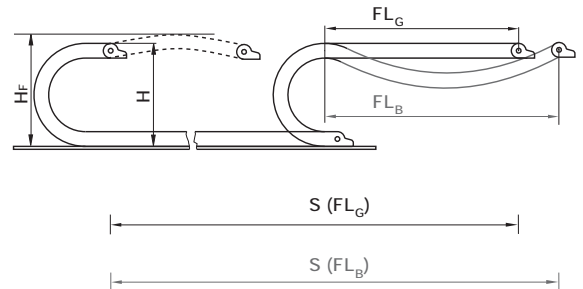

Product Range:

Inner Widths (Bi) inches (mm):	.39 (10), .63 (16)
Bending Radii (R) inches (mm):	.71 (018), 1.10 (028), 1.50 (038)
Pitch:	.79 in (20 mm)/link = 15.24 links/ft (50 links/m)



When to use the Series  
E06/Z06:

- If price is an issue
- If fast and easy cable and hose accessibility is required
- If torsional rigidity and torque resistance are required
- If very quiet operation is required



When not to use the Series  
E06/Z06:

- If a long unsupported length is required
- "Z" Series is unsuitable for gliding applications

E06 (split crossbar along the outer radius)

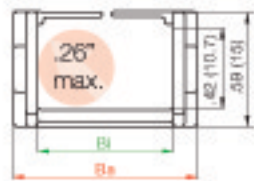

Part No.	Bi	Ba	Bending Radii for ALL Widths	
E06-10	.39 (10)	.65 (16.5)		.71 (018)
E06-16	.63 (16)	.86 (22.5)		1.10 (028)
				1.50 (038)

Z06 (split crossbar along the inner radius)

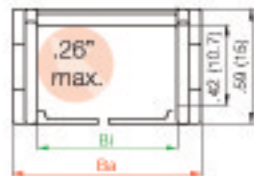

Part No.	Bi	Ba	Bending Radii for ALL Widths	
Z06-10	.39 (10)	.65 (16.5)		.71 (018)
Z06-16	.63 (16)	.86 (22.5)		1.10 (028)
				1.50 (038)

Installation Dimensions

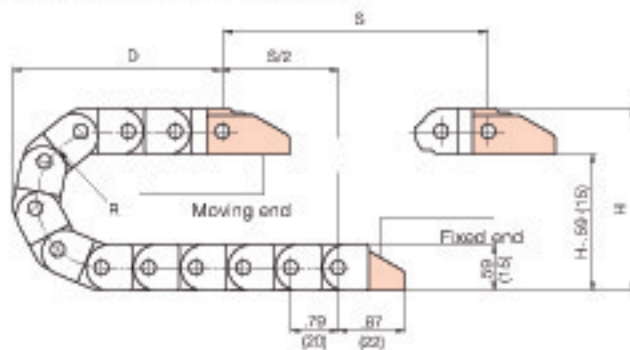

R	.71 (018)	1.10 (028)	1.50 (038)
H*	2.04 (52)	2.76 (70)	3.54 (90)
D	1.57 (40)	1.97 (50)	2.36 (60)
K	3.74 (95)	4.72 (120)	5.71 (145)

\*The required clearance height is HF = H + .39 (10) with .13 lbs/ft (0.2 kg/m) fill weight.

- Pitch: = .79 (20 mm) per link
- Links per ft (m): = 15.24 (50)
- Chain length: =  $\frac{L}{2} + K$

Mounting Brackets

Option 1:

- Without tiwrap plate



Option 2:

- With tiwrap plate

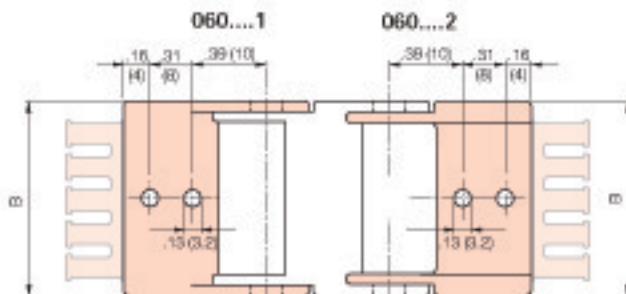

Standard mounting bracket

- One-piece, locking mounting bracket
- Corrosion-resistant
- Available pre-assembled
- Inner and outer attachment possible
- Available with integrated strain relief tiwrap plates

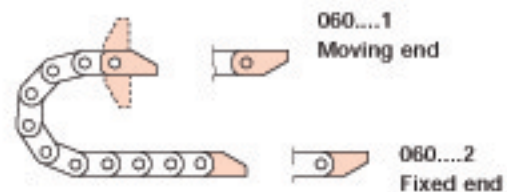

Chain Type	Part No. Set Full set with Strain Relief Tiwrap Plate	Part No. Mounting Bracket Set	Number of Teeth	Dimensions B in. (mm)
E06/Z06-10	060-10-12 PZ	060-10-12	1	.65 (16.5)
E06/Z06-16	060-16-12 PZ	060-16-12	2	.88 (22.5)

- 060...12 - Full set, each part with pin/bore
- 060... 1 - Mounting bracket with bore
- 060... 2 - Mounting bracket with pin

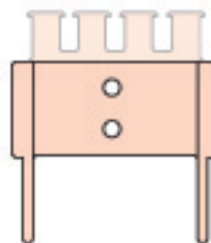
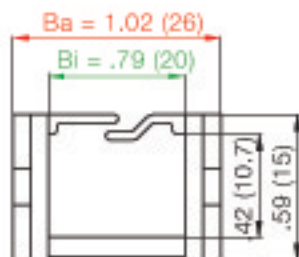
**Order Example**
**E06-20-**

**1. Chain selection:**
**E06-20-038-0**

**2. Mounting brackets:**
**060-20-12 - with strain relief tiewrap plate**

**For 2.62 ft (0.8 m) chain, color black, with mounting brackets:**
**2.62 ft (0.8 m) E06-20-038-0 and 060-20-12PZ**

**Technical data**

Chain Type	Weight Per Link		Weight	
	(oz.)	(g)	(lbs/ft)	(kg/m)
E06/Z06-06-10	0.049	(≈2.8)	0.094	(≈0.14)
E06/Z06-06-16	0.112	(≈3.2)	0.106	(≈0.16)

Material (chain)	igumid NB
Material (mounting brackets)*	igumid G
Permitted temperature	-22°F/212°F (-30°C/+100°C)
Gliding speed max.	Conditionally suitable
Unsupported v max.	32.8 ft/s (10m/s)
Flammability class (chain)	VDE 0304 IIC UL94 V2
Flammability class (mounting brackets)*	VDE 0304 IIC UL94 HB

\*Available in igumid NB upon request