



7 Widths
3 Bending Radii



Mounting brackets with or without strain relief tiewrap plate



Quicksnap: the complete unit, detachable by hand
Call for availability



Quickfix: mounting bracket with pin
Call for availability

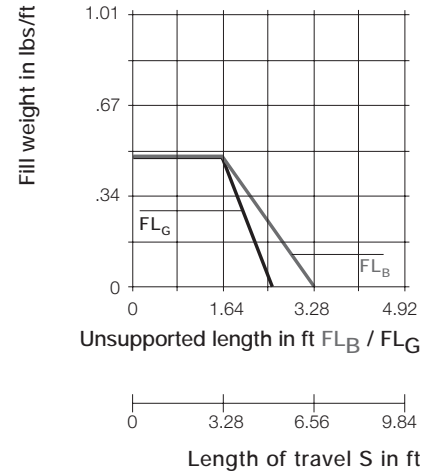

Unsupported length

- FL_B = unsupported with permitted sag
- FL_G = unsupported with straight upper run

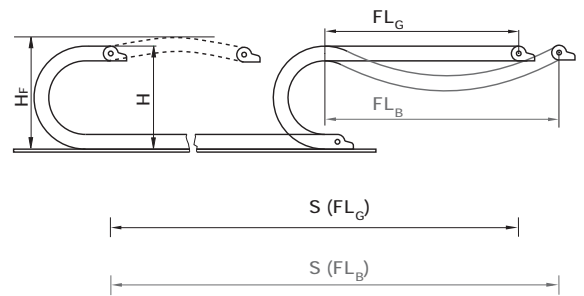

Product Range:

Inner Widths (Bi) inches (mm):	.39 (10), .63 (16), .79 (20), 1.18 (30), 1.57 (40), 1.97 (50), 1.89 (048)
Bending Radii (R) inches (mm):	1.10 (028), 1.50 (038), 1.89 (048)
Pitch:	.79 (20 mm/link) = 15.24 links/ft (50 links/m)



When to use the Series 08 E2 "micro":

- If quieter operation is required
- If cost is a factor
- If connection options are required (Quicksnap, Quickfix, etc.)
- If torsional rigidity is required



When not use the Series 08 E2 "micro":

- If snap-open links are required
▶ Series 09 "Zipper", Chapter 3
- If quick insertion of cables with pre-assembled connectors is required
▶ Series E08 "E-Z Chain", Chapter 2

Series 08 E2 "micro"

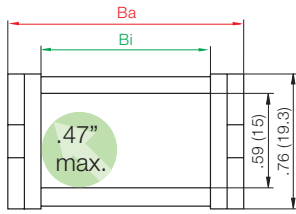

Part No.	Bi	Ba
08-10	.39 (10)	.72 (18.2)
08-16	.63 (16)	.95 (24.2)
08-20	.79 (20)	1.11 (28.2)
08-30	1.18 (30)	1.50 (38.2)
08-40	1.57 (40)	1.90 (48.2)
08-50	1.97 (50)	2.29 (58.2)

Bending Radii
for ALL Widths
1.10 (028)
1.50 (038)
1.89 (048)

Supplement part number with required radius
for example 08-20-038-0

Installation Dimensions

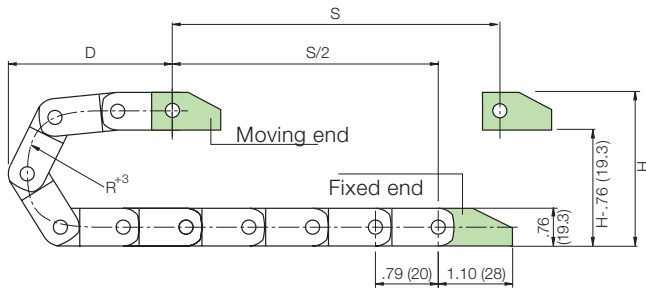

R	1.10 (028)	1.50 (038)	1.89 (048)	.98 (025**)
H*	2.99 (76)	3.78 (96)	4.57 (116)	2.76 (70)
D	2.36 (60)	2.76 (70)	3.15 (80)	2.24 (57)
K	5.12 (130)	6.30 (160)	7.48 (190)	.79 (20)

*The required clearance height is $HF = H + .59 (15)$ with .20 lbs/ft (0.3 kg/m) fill weight. Please consult igus® if space is particularly restricted.

** only Part No. 08-10

Pitch: = .79 (20 mm) per link
 Links per ft (m): = 15.24 (50)
 Chain length: = $\frac{S}{2} + K$

Mounting Brackets

Polymer, One Piece

- One-piece, locked mounting bracket
- Corrosion resistant
- Available pre-assembled
- Inner and outer attachment possible
- Available with strain relief tie-wrap plates

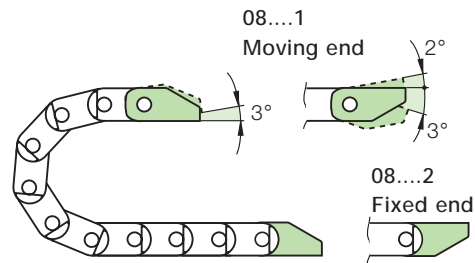
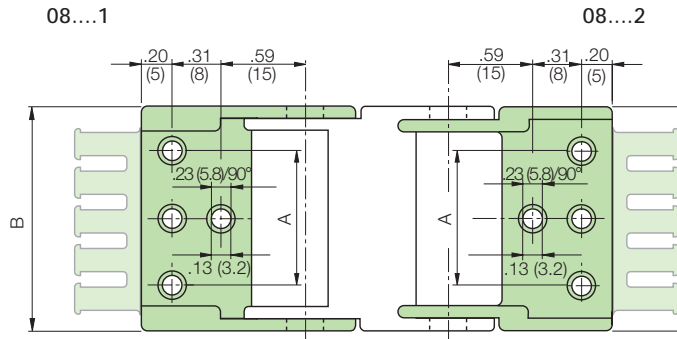

080-10-12 – 080-20-12:
Center bores only
 080-30-12 – 080-50-12:
All bores

Chain Type	Part No. Full set with Tiewrap Plate	Part No. Mounting Bracket Set	Number of Teeth	Dimension A in. (mm)	Dimensions B in. (mm)
08-10	080-10-12 PZ	080-10-12	1	–	.72 (18.2)
08-16	080-16-12 PZ	080-16-12	2	–	.95 (24.2)
08-20	080-20-12 PZ	080-20-12	2	–	1.11 (28.2)
08-30	080-30-12 PZ	080-30-12	3	.87 (22)	1.50 (38.2)
08-40	080-40-12 PZ	080-40-12	4	1.26 (32)	1.90 (48.2)
08-50	080-50-12 PZ	080-50-12	5	1.65 (42)	2.29 (58.2)

08...12 = Full set, each part
with pin/bore
 08... 1 = Mounting bracket
with bore
 08... 2 = Mounting bracket
with pin

Order example

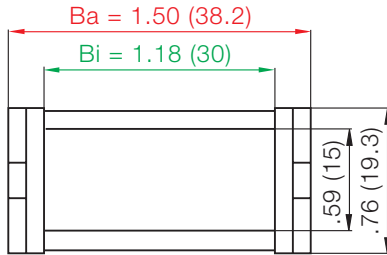

08-30...

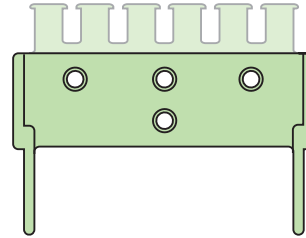

1. Chain selection:

08-30-038-0



2. Mounting brackets:

080-30-12 PZ - with strain relief tiewrap plate



For 16.4 ft (5 m) chain, color black, with mounting brackets:
16.4 ft (5 m) 08-30-038-0 and 080-30-12 PZ

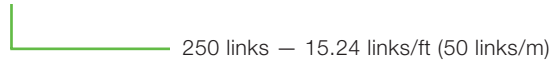

Technical data

Chain Type	Weight Per Link		Weight	
	(oz.)	(g)	(lbs/ft)	(kg/m)
08-10	0.095	(≈ 2.7)	0.141	(≈ 0.21)
08-16	0.109	(≈ 3.1)	0.161	(≈ 0.24)
08-20	0.112	(≈ 3.2)	0.168	(≈ 0.25)
08-30	0.126	(≈ 3.6)	0.188	(≈ 0.28)
08-40	0.140	(≈ 4.0)	0.208	(≈ 0.31)
08-50	0.168	(≈ 4.8)	0.249	(≈ 0.37)

Material	igumid G
Permitted temperature	-40°F/266°F (-40°C/+130°C)
Gliding speed max.	9.8 ft/s (3 m/s)
Unsupported v max.	32.8 ft/s (10 m/s)
Flammability class	VDE 0304 IIC UL94 HB