



E-Chain®  
Cable Carrier System



Chainflex®  
flexible cable



ReadyChain®  
harnessed systems



iglide®  
polymer bearings



Drylin® linear  
bearings & slides



igubal®  
spherical bearings

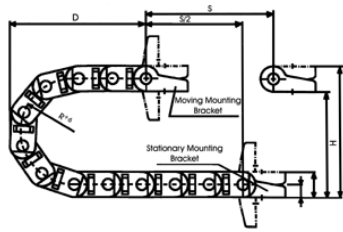

**Series 08: Please select a Part Number Inch Version**

Part Number	Inner Width	Outer Width	Radius	Curve Height H	Curve Length K	Weight
<a href="#">08-06-028-0</a>	0.23 in	0.55 in	1.1 in	3.15 in	5.12 in	0.115 lbs/ft
<a href="#">08-06-038-0</a>	0.23 in	0.55 in	1.5 in	3.9 in	6.3 in	0.115 lbs/ft
<a href="#">08-06-048-0</a>	0.23 in	0.55 in	1.9 in	4.72 in	7.48 in	0.115 lbs/ft
<a href="#">08-10-028-0</a>	0.39 in	0.71 in	1.1 in	3.15 in	5.12 in	0.15 lbs/ft
<a href="#">08-10-038-0</a>	0.39 in	0.71 in	1.5 in	3.9 in	6.3 in	0.15 lbs/ft
<a href="#">08-10-048-0</a>	0.39 in	0.71 in	1.9 in	4.72 in	7.48 in	0.15 lbs/ft
<a href="#">08-16-028-0</a>	0.63 in	0.95 in	1.1 in	3.15 in	5.12 in	0.16 lbs/ft
<a href="#">08-16-038-0</a>	0.63 in	0.95 in	1.5 in	3.9 in	6.3 in	0.16 lbs/ft
<a href="#">08-16-048-0</a>	0.63 in	0.95 in	1.9 in	4.72 in	7.48 in	0.16 lbs/ft
<a href="#">08-20-028-0</a>	0.79 in	1.11 in	1.1 in	3.15 in	5.12 in	0.17 lbs/ft
<a href="#">08-20-038-0</a>	0.79 in	1.11 in	1.5 in	3.9 in	6.3 in	0.17 lbs/ft
<a href="#">08-20-048-0</a>	0.79 in	1.11 in	1.9 in	4.72 in	7.48 in	0.17 lbs/ft
<a href="#">08-30-028-0</a>	1.18 in	1.5 in	1.1 in	3.15 in	5.12 in	0.19 lbs/ft
<a href="#">08-30-038-0</a>	1.18 in	1.5 in	1.5 in	3.9 in	6.3 in	0.19 lbs/ft
<a href="#">08-30-048-0</a>	1.18 in	1.5 in	1.9 in	4.72 in	7.48 in	0.19 lbs/ft
<a href="#">08-40-028-0</a>	1.57 in	1.89 in	1.1 in	3.15 in	5.12 in	0.21 lbs/ft
<a href="#">08-40-038-0</a>	1.57 in	1.89 in	1.5 in	3.9 in	6.3 in	0.21 lbs/ft
<a href="#">08-40-048-0</a>	1.57 in	1.89 in	1.9 in	4.72 in	7.48 in	0.21 lbs/ft
<a href="#">08-50-028-0</a>	1.97 in	2.29 in	1.1 in	3.15 in	5.12 in	0.25 lbs/ft
<a href="#">08-50-038-0</a>	1.97 in	2.29 in	1.5 in	3.9 in	6.3 in	0.25 lbs/ft
<a href="#">08-50-048-0</a>	1.97 in	2.29 in	1.9 in	4.72 in	7.48 in	0.25 lbs/ft

7 Widths  
3 Bending Radii



Mounting brackets with or without strain relief tiewrap plate



**Quicksnap:** the complete unit, detachable by hand  
Call for availability



**Quickfix:** mounting bracket with pin  
Call for availability

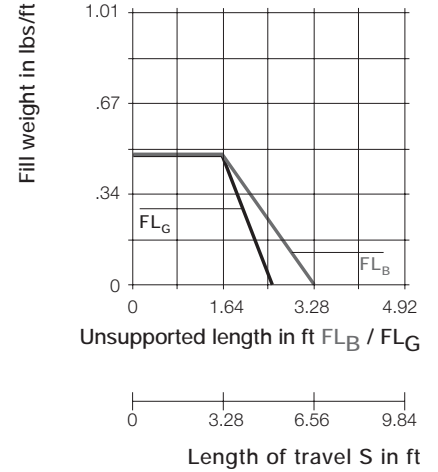

**Unsupported length**

- FL<sub>B</sub> = unsupported with permitted sag
- FL<sub>G</sub> = unsupported with straight upper run

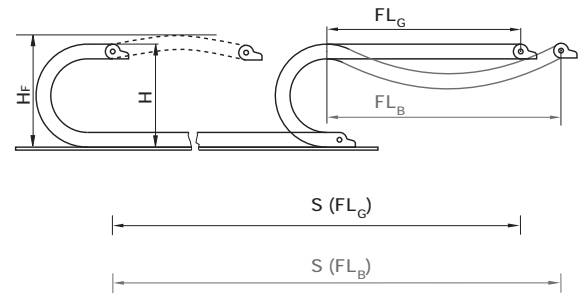

**Product Range:**

Inner Widths (Bi) inches (mm):	.39 (10), .63 (16), .79 (20), 1.18 (30), 1.57 (40), 1.97 (50), 1.89 (048)
Bending Radii (R) inches (mm):	1.10 (028), 1.50 (038), 1.89 (048)
Pitch:	.79 (20 mm/link) = 15.24 links/ft (50 links/m)



**When to use the Series 08 E2 "micro":**

- If quieter operation is required
- If cost is a factor
- If connection options are required (Quicksnap, Quickfix, etc.)
- If torsional rigidity is required



**When not use the Series 08 E2 "micro":**

- If snap-open links are required
- If quick insertion of cables with pre-assembled connectors is required

# Series 08 E2 "micro"

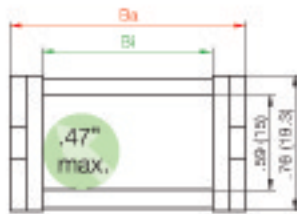

Part No.	Bi	Ba
08-10	.39 (10)	.72 (18.2)
08-16	.63 (16)	.95 (24.2)
08-20	.79 (20)	1.11 (28.2)
08-30	1.18 (30)	1.50 (38.2)
08-40	1.57 (40)	1.90 (48.2)
08-50	1.97 (50)	2.29 (58.2)

Bending Radii for ALL Widths  
 1.10 (028)  
 1.50 (038)  
 1.89 (048)

## Installation Dimensions

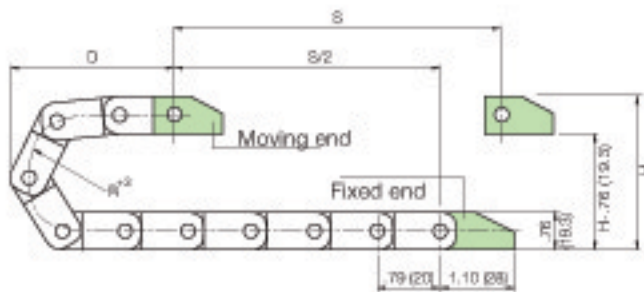

R	1.10 (028)	1.50 (038)	1.89 (048)	.98 (025**)
H*	2.99 (76)	3.78 (96)	4.57 (116)	2.76 (70)
D	2.36 (60)	2.76 (70)	3.15 (80)	2.24 (57)
K	5.12 (130)	6.30 (160)	7.48 (190)	.79 (20)

\*The required clearance height is  $HF = H + .59$  (15) with .20 lbs/ft (0.3 kg/m) fill weight.

\*\* only Part No. 08-10

- Pitch: - .79 (20 mm) per link
- Links per ft (m): - 15.24 (50)
- Chain length: -  $\frac{S}{.79} + K$

## Mounting Brackets

### Polymer, One Piece

- One-piece, locked mounting bracket
- Corrosion resistant
- Available pre-assembled
- Inner and outer attachment possible
- Available with strain relief tie-wrap plates

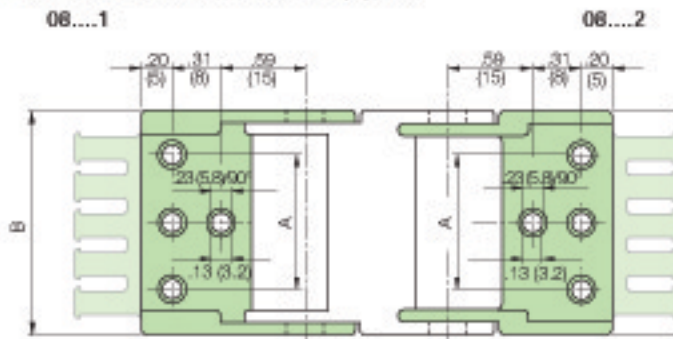
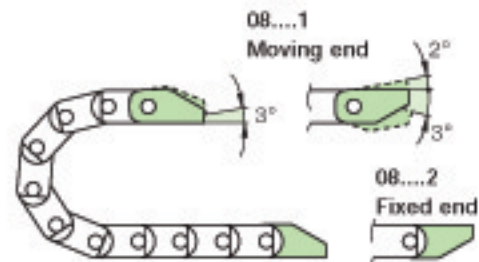

080-10-12 - 080-20-12:  
Center bores only  
 080-30-12 - 080-50-12:  
All bores

Chain Type	Part No. Full set with Tie-wrap Plate	Part No. Mounting Bracket Set	Number of Teeth	Dimension A in. (mm)	Dimensions B in. (mm)
08-10	080-10-12 PZ	080-10-12	1	-	.72 (18.2)
08-16	080-16-12 PZ	080-16-12	2	-	.95 (24.2)
08-20	080-20-12 PZ	080-20-12	2	-	1.11 (28.2)
08-30	080-30-12 PZ	080-30-12	3	.87 (22)	1.50 (38.2)
08-40	080-40-12 PZ	080-40-12	4	1.26 (32)	1.90 (48.2)
08-50	080-50-12 PZ	080-50-12	5	1.65 (42)	2.29 (58.2)

08...12 - Full set, each part with pin/bore  
 08... 1 - Mounting bracket with bore  
 08... 2 - Mounting bracket with pin

## Order example

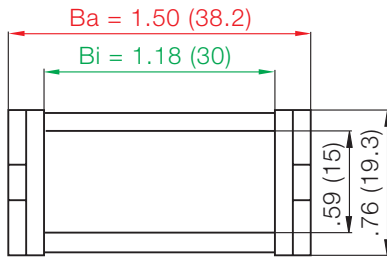

## 08-30...

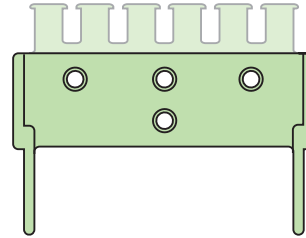

### 1. Chain selection:

08-30-038-0



### 2. Mounting brackets:

080-30-12 PZ - with strain relief tiewrap plate



For 16.4 ft (5 m) chain, color black, with mounting brackets:

16.4 ft (5 m) 08-30-038-0 and 080-30-12 PZ

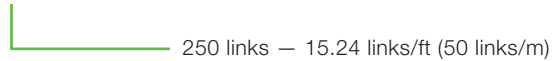

## Technical data

Chain Type	Weight Per Link		Weight	
	(oz.)	(g)	(lbs/ft)	(kg/m)
08-10	0.095	(≈ 2.7)	0.141	(≈ 0.21)
08-16	0.109	(≈ 3.1)	0.161	(≈ 0.24)
08-20	0.112	(≈ 3.2)	0.168	(≈ 0.25)
08-30	0.126	(≈ 3.6)	0.188	(≈ 0.28)
08-40	0.140	(≈ 4.0)	0.208	(≈ 0.31)
08-50	0.168	(≈ 4.8)	0.249	(≈ 0.37)

Material	igumid G
Permitted temperature	-40°F/266°F (-40°C/+130°C)
Gliding speed max.	9.8 ft/s (3 m/s)
Unsupported v max.	32.8 ft/s (10 m/s)
Flammability class	VDE 0304 IIC UL94 HB