

CTM210M4

Cable Tie Mount .857"X.605" - PA66, White, T18-T120 Cable Ties, #8 Screw, 1000/pk

Article Number: 151-30506

Part Number: CTM210M4

Type: CTM2

Material: PA66



1. Base Data

| | |
|---------------------------|---|
| Part No. | CTM210M4 |
| Type | CTM2 |
| Color | White |
| Features | The CTM series is designed to provide stability to wire bundles. These mounts can accommodate the T18 through T120 series cable ties. |
| Application | Designed specifically for holding heavier cable bundles. |
| Application Method | Each mount is secured with a single #8 screw. |

2. Product Dimensions

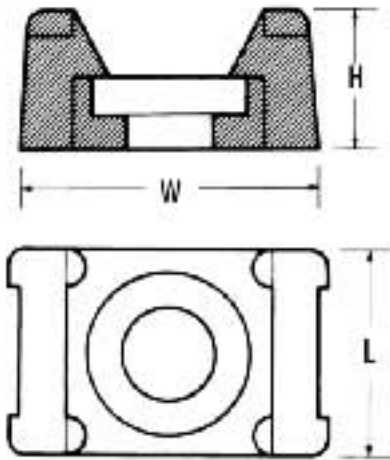

| | |
|-----------------------------|------------------|
| Length (L) | .857 " / 21.8 |
| Width (W) | .605 " / 15.4 mm |
| Max. Cable Tie Width | 7.7 mm |
| Height (H) | .372 " / 9.4 mm |
| Mounting Hole Ø | .173 " / 4.5 mm |

4. Material and Specifications

| | |
|------------------------------|---|
| Material | Polyamide 6.6 (PA66) |
| Material Shortcut | PA66 |
| Flammability | UL94 V2 |
| Operating Temperature | -40 °F to +185 °F (-40 °C to +85 °C) continuous |
| ROHS Conformity |  |

Logistic and Packaging

| | |
|-----------------------|-------------|
| Packaging Type | bag |
| Pkg. Qty. | 1000 |
| UPC | 08930601260 |

Cable Tie Mounts

Cable Tie Mounts

The CTM series is designed to provide stability to wire bundles. These mounts can accommodate miniature, intermediate, or standard cross-section cable ties. Each mount is secured with a single screw.



| Material Data | |
|-----------------------|--|
| Material | Polyamide 6.6 (PA66) |
| Operating Temperature | -40 °F to +185 °F (-40 °C to +85 °C) continuous |
| Flammability | UL94 V2 |

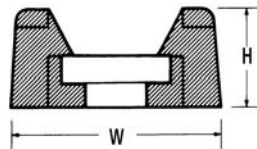
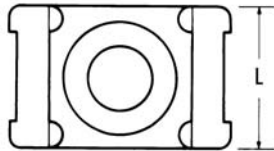

UL
File# E64139

| Product Selection | | | | | | | | | | | | | |
|-------------------|-----------------|------|------------------|------------|------------|---------|-----------|--------|------------|--------|--------|-----------|------|
| Article No. | Part No. | Type | Cable Tie Series | Mounting | Length (L) | | Width (W) | | Height (H) | | | | |
| | | | | | in. | (mm) | in. | (mm) | in. | (mm) | Color | Pkg. Qty. | |
| 151-30303 | CTM010C2 | CTM0 | T18 - T50 | # 6 Screw | .578" | (14.68) | .375" | (9.52) | .266" | (6.76) | White | 100 | |
| 151-30305 | CTM010M4 | | | | .578" | (14.68) | .375" | (9.52) | .266" | (6.76) | White | 1000 | |
| 151-30300 | CTM00C2 | | | | .578" | (14.68) | .375" | (9.52) | .266" | (6.76) | Black | 100 | |
| 151-30301 | CTM00M4 | | | | .578" | (14.68) | .375" | (9.52) | .266" | (6.76) | Black | 1000 | |
| 151-30404 | CTM110C2 | CTM1 | | T18 - T120 | # 8 Screw | .579" | (14.71) | .370" | (9.40) | .266" | (6.76) | White | 100 |
| 151-30406 | CTM110M4 | | | | | .579" | (14.71) | .370" | (9.40) | .266" | (6.76) | White | 1000 |
| 151-30400 | CTM10C2 | | | | | .579" | (14.71) | .370" | (9.40) | .266" | (6.76) | Black | 100 |
| 151-30402 | CTM10M4 | | | | | .579" | (14.71) | .370" | (9.40) | .266" | (6.76) | Black | 1000 |
| 151-30504 | CTM210C2 | CTM2 | T18 - T120 | | # 8 Screw | .857" | (21.77) | .605" | (15.37) | .372" | (9.45) | White | 100 |
| 151-30506 | CTM210M4 | | | | | .857" | (21.77) | .605" | (15.37) | .372" | (9.45) | White | 1000 |
| 151-30500 | CTM20C2 | | | | | .857" | (21.77) | .605" | (15.37) | .372" | (9.45) | Black | 100 |
| 151-30501 | CTM20M4 | | | | | .857" | (21.77) | .605" | (15.37) | .372" | (9.45) | Black | 1000 |
| 151-30605 | CTM310C2 | CTM3 | | T18 - T120 | #10 Screw | .858" | (21.79) | .609" | (15.47) | .374" | (9.50) | White | 100 |
| 151-30607 | CTM310M4 | | | | | .858" | (21.79) | .609" | (15.47) | .374" | (9.50) | White | 1000 |
| 151-30600 | CTM30C2 | | | | | .858" | (21.79) | .609" | (15.47) | .374" | (9.50) | Black | 100 |
| 151-30603 | CTM30M4 | | | | | .858" | (21.79) | .609" | (15.47) | .374" | (9.50) | Black | 1000 |
| 151-30703 | CTM410C2 | CTM4 | T18 - T120 | | .25" Screw | .864" | (21.95) | .616" | (15.65) | .372" | (9.45) | White | 100 |
| 151-30705 | CTM410M4 | | | | | .864" | (21.95) | .616" | (15.65) | .372" | (9.45) | White | 1000 |
| 151-30700 | CTM40C2 | | | | | .864" | (21.95) | .616" | (15.65) | .372" | (9.45) | Black | 100 |
| 151-30702 | CTM40M4 | | | | | .864" | (21.95) | .616" | (15.65) | .372" | (9.45) | Black | 1000 |

Dimensions are approximate and subject to technical changes. Use **Part No.** for ordering and **Type** for specification purposes.