

CTM110M4

Cable Tie Mount .579"X.370" - PA66, White, T18-T50 Cable Ties, #8 Screw, 1000/pk

Article Number: 151-30406

Part Number: CTM110M4

Type: CTM1

Material: PA66



1. Base Data

Part No.	CTM110M4
Type	CTM1
Color	White
Features	The CTM series is designed to provide stability to wire bundles. These mounts can accommodate the T18 through T50 series cable ties.
Application	Designed specifically for holding heavier cable bundles.
Application Method	Each mount is secured with a single #8 screw.

2. Product Dimensions

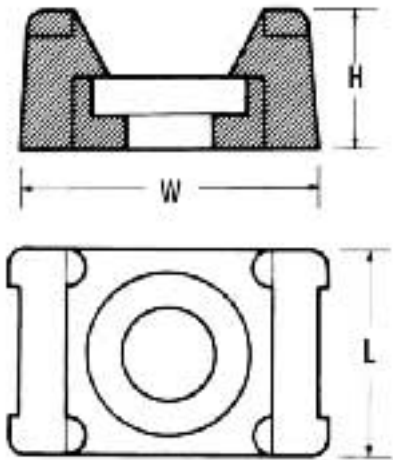

Length (L)	.579 " / 14.7
Width (W)	.370 " / 9.4 mm
Max. Cable Tie Width	5.1 mm
Height (H)	.266 " / 6.8 mm
Mounting Hole Ø	.185 " / 4.7

4. Material and Specifications

Material	Polyamide 6.6 (PA66)
Material Shortcut	PA66
Flammability	UL94 V2
Operating Temperature	-40 °F to +185 °F (-40 °C to +85 °C) continuous
ROHS Conformity	

Logistic and Packaging

Packaging Type	bag
Pkg. Qty.	1000
Carton Qty.	15000
UPC	08930601232

Miscellaneous

UL Recognized (US and Canada) Yes

Cable Tie Mounts

Cable Tie Mounts

The CTM series is designed to provide stability to wire bundles. These mounts can accommodate miniature, intermediate, or standard cross-section cable ties. Each mount is secured with a single screw.



Material Data	
Material	Polyamide 6.6 (PA66)
Operating Temperature	-40 °F to +185 °F (-40 °C to +85 °C) continuous
Flammability	UL94 V2

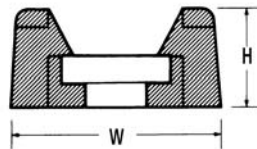
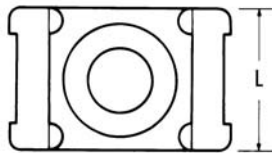

UL
File# E64139

Product Selection													
Article No.	Part No.	Type	Cable Tie Series	Mounting	Length (L)		Width (W)		Height (H)				
					in.	(mm)	in.	(mm)	in.	(mm)	Color	Pkg. Qty.	
151-30303	CTM010C2	CTM0	T18 - T50	# 6 Screw	.578"	(14.68)	.375"	(9.52)	.266"	(6.76)	White	100	
151-30305	CTM010M4				.578"	(14.68)	.375"	(9.52)	.266"	(6.76)	White	1000	
151-30300	CTM00C2				.578"	(14.68)	.375"	(9.52)	.266"	(6.76)	Black	100	
151-30301	CTM00M4				.578"	(14.68)	.375"	(9.52)	.266"	(6.76)	Black	1000	
151-30404	CTM110C2	CTM1		T18 - T120	# 8 Screw	.579"	(14.71)	.370"	(9.40)	.266"	(6.76)	White	100
151-30406	CTM110M4					.579"	(14.71)	.370"	(9.40)	.266"	(6.76)	White	1000
151-30400	CTM10C2					.579"	(14.71)	.370"	(9.40)	.266"	(6.76)	Black	100
151-30402	CTM10M4					.579"	(14.71)	.370"	(9.40)	.266"	(6.76)	Black	1000
151-30504	CTM210C2	CTM2	T18 - T120		# 8 Screw	.857"	(21.77)	.605"	(15.37)	.372"	(9.45)	White	100
151-30506	CTM210M4					.857"	(21.77)	.605"	(15.37)	.372"	(9.45)	White	1000
151-30500	CTM20C2					.857"	(21.77)	.605"	(15.37)	.372"	(9.45)	Black	100
151-30501	CTM20M4					.857"	(21.77)	.605"	(15.37)	.372"	(9.45)	Black	1000
151-30605	CTM310C2	CTM3		T18 - T120	#10 Screw	.858"	(21.79)	.609"	(15.47)	.374"	(9.50)	White	100
151-30607	CTM310M4					.858"	(21.79)	.609"	(15.47)	.374"	(9.50)	White	1000
151-30600	CTM30C2					.858"	(21.79)	.609"	(15.47)	.374"	(9.50)	Black	100
151-30603	CTM30M4					.858"	(21.79)	.609"	(15.47)	.374"	(9.50)	Black	1000
151-30703	CTM410C2	CTM4	T18 - T120		.25" Screw	.864"	(21.95)	.616"	(15.65)	.372"	(9.45)	White	100
151-30705	CTM410M4					.864"	(21.95)	.616"	(15.65)	.372"	(9.45)	White	1000
151-30700	CTM40C2					.864"	(21.95)	.616"	(15.65)	.372"	(9.45)	Black	100
151-30702	CTM40M4					.864"	(21.95)	.616"	(15.65)	.372"	(9.45)	Black	1000

Dimensions are approximate and subject to technical changes. Use **Part No.** for ordering and **Type** for specification purposes.