

## CTM110C2

Cable Tie Mount .579"X.370" - PA66, White, T18-T50 Cable Ties, #8 Screw, 100/pk

Article Number: 151-30404

Part Number: CTM110C2

Type: CTM1

Material: PA66



### 1. Base Data

---

<b>Part No.</b>	CTM110C2
<b>Type</b>	CTM1
<b>Color</b>	White
<b>Features</b>	The CTM series is designed to provide stability to wire bundles. These mounts can accommodate the T18 through T50 series cable ties.
<b>Application</b>	Designed specifically for holding heavier cable bundles.
<b>Application Method</b>	Each mount is secured with a single #8 screw.

## 2. Product Dimensions

---

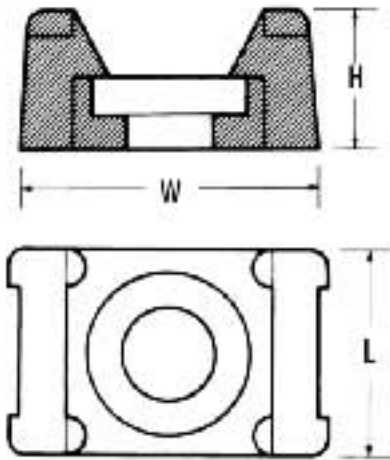

Length (L)	.579 " / 14.7
Width (W)	.370 " / 9.4 mm
Max. Cable Tie Width	5.1 mm
Height (H)	.266 " / 6.8 mm
Mounting Hole Ø	.185 " / 4.7

## 4. Material and Specifications

---

Material	Polyamide 6.6 (PA66)
Material Shortcut	PA66
Flammability	UL94 V2
Operating Temperature	-40 °F to +185 °F (-40 °C to +85 °C) continuous
ROHS Conformity	

## Logistic and Packaging

---

Packaging Type	bag
Pkg. Qty.	100
Carton Qty.	10000
UPC	08930601227

## Miscellaneous

---

UL Recognized (US and Canada) Yes

# Cable Tie Mounts

## Cable Tie Mounts

The CTM series is designed to provide stability to wire bundles. These mounts can accommodate miniature, intermediate, or standard cross-section cable ties. Each mount is secured with a single screw.



Material Data	
Material	<b>Polyamide 6.6 (PA66)</b>
Operating Temperature	<b>-40 °F to +185 °F (-40 °C to +85 °C) continuous</b>
Flammability	<b>UL94 V2</b>

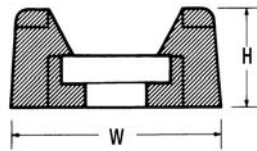
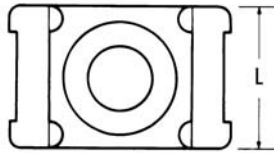

**UL**  
File# E64139

Product Selection													
Article No.	Part No.	Type	Cable Tie Series	Mounting	Length (L)		Width (W)		Height (H)		Color	Pkg. Qty.	
					in.	(mm)	in.	(mm)	in.	(mm)			
151-30303	<b>CTM010C2</b>	CTM0	T18 - T50	# 6 Screw	.578"	(14.68)	.375"	(9.52)	.266"	(6.76)	White	100	
151-30305	<b>CTM010M4</b>				.578"	(14.68)	.375"	(9.52)	.266"	(6.76)	White	1000	
151-30300	<b>CTM00C2</b>				.578"	(14.68)	.375"	(9.52)	.266"	(6.76)	Black	100	
151-30301	<b>CTM00M4</b>				.578"	(14.68)	.375"	(9.52)	.266"	(6.76)	Black	1000	
151-30404	<b>CTM110C2</b>	CTM1		T18 - T120	# 8 Screw	.579"	(14.71)	.370"	(9.40)	.266"	(6.76)	White	100
151-30406	<b>CTM110M4</b>					.579"	(14.71)	.370"	(9.40)	.266"	(6.76)	White	1000
151-30400	<b>CTM10C2</b>					.579"	(14.71)	.370"	(9.40)	.266"	(6.76)	Black	100
151-30402	<b>CTM10M4</b>					.579"	(14.71)	.370"	(9.40)	.266"	(6.76)	Black	1000
151-30504	<b>CTM210C2</b>	CTM2	T18 - T120		# 8 Screw	.857"	(21.77)	.605"	(15.37)	.372"	(9.45)	White	100
151-30506	<b>CTM210M4</b>					.857"	(21.77)	.605"	(15.37)	.372"	(9.45)	White	1000
151-30500	<b>CTM20C2</b>					.857"	(21.77)	.605"	(15.37)	.372"	(9.45)	Black	100
151-30501	<b>CTM20M4</b>					.857"	(21.77)	.605"	(15.37)	.372"	(9.45)	Black	1000
151-30605	<b>CTM310C2</b>	CTM3		T18 - T120	#10 Screw	.858"	(21.79)	.609"	(15.47)	.374"	(9.50)	White	100
151-30607	<b>CTM310M4</b>					.858"	(21.79)	.609"	(15.47)	.374"	(9.50)	White	1000
151-30600	<b>CTM30C2</b>					.858"	(21.79)	.609"	(15.47)	.374"	(9.50)	Black	100
151-30603	<b>CTM30M4</b>					.858"	(21.79)	.609"	(15.47)	.374"	(9.50)	Black	1000
151-30703	<b>CTM410C2</b>	CTM4	T18 - T120		.25" Screw	.864"	(21.95)	.616"	(15.65)	.372"	(9.45)	White	100
151-30705	<b>CTM410M4</b>					.864"	(21.95)	.616"	(15.65)	.372"	(9.45)	White	1000
151-30700	<b>CTM40C2</b>					.864"	(21.95)	.616"	(15.65)	.372"	(9.45)	Black	100
151-30702	<b>CTM40M4</b>					.864"	(21.95)	.616"	(15.65)	.372"	(9.45)	Black	1000

Dimensions are approximate and subject to technical changes. Use **Part No.** for ordering and **Type** for specification purposes.