

## CTM010C2

Cable Tie Mount .578"X.375" - PA66, White, T18-T50 Cable Ties, #6 Screw, 100/pk

Article Number: 151-30303

Part Number: CTM010C2

Type: CTM0

Material: PA66



### 1. Base Data

|                           |  |
|---------------------------|--|
| <b>Part No.</b>           | CTM010C2   |
| <b>Type</b>               | CTM0   |
| <b>Color</b>              | White  |
| <b>Features</b>           | The CTM series is designed to provide stability to wire bundles. These mounts can accommodate the T18 through T50 series cable ties. |
| <b>Application</b>        | Designed specifically for holding heavier cable bundles.   |
| <b>Application Method</b> | Each mount is secured with a single #6 screw.  |

|                        |           |
|------------------------|-----------|
| Label E-Number Finland | 13 708 40 |
| Label E-Number Norway  | 13 302 04 |
| Label E-Number Sweden  | 15 164 30 |

## 2. Product Dimensions

---

|                      |                 |
|----------------------|-----------------|
| Length (L)           | .578 " / 14.7   |
| Width (W)            | .375 " / 9.5 mm |
| Max. Cable Tie Width | 5.1 mm          |
| Height (H)           | .266 " / 6.8 mm |
| Mounting Hole Ø      | .146 " / 3.8 mm |

## 4. Material and Specifications

---

|                       |   |
|-----------------------|---|
| Material              | Polyamide 6.6 (PA66)  |
| Material Shortcut     | PA66  |
| Flammability          | UL94 V2   |
| Operating Temperature | -40 °F to +185 °F (-40 °C to +85 °C)<br>continuous                                  |
| ROHS Conformity       |  |

## Logistic and Packaging

---

|                |       |
|----------------|-------|
| Packaging Type | bag   |
| Pkg. Qty.      | 100   |
| Carton Qty.    | 15000 |

**UPC**

08930601202

**Miscellaneous**

---

**UL Recognized (US and Canada)** Yes

# Cable Tie Mounts

## Cable Tie Mounts

The CTM series is designed to provide stability to wire bundles. These mounts can accommodate miniature, intermediate, or standard cross-section cable ties. Each mount is secured with a single screw.



| Material Data         |  |
|-----------------------|--|
| Material              | <b>Polyamide 6.6 (PA66)</b>                            |
| Operating Temperature | <b>-40 °F to +185 °F (-40 °C to +85 °C) continuous</b> |
| Flammability          | <b>UL94 V2</b>   |

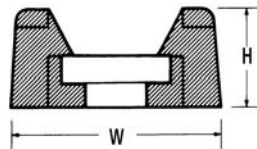
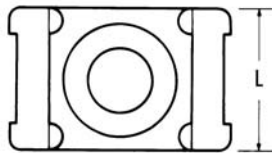

**UL**  
File# E64139

| Product Selection |                 |      |                  |            |            |         |           |        |            |        |        |           |      |
|-------------------|-----------------|------|------------------|------------|------------|---------|-----------|--------|------------|--------|--------|-----------|------|
| Article No.       | Part No.        | Type | Cable Tie Series | Mounting   | Length (L) |         | Width (W) |        | Height (H) |        |        |           |      |
|                   |                 |      |                  |            | in.        | (mm)    | in.       | (mm)   | in.        | (mm)   | Color  | Pkg. Qty. |      |
| 151-30303         | <b>CTM010C2</b> | CTM0 | T18 - T50        | # 6 Screw  | .578"      | (14.68) | .375"     | (9.52) | .266"      | (6.76) | White  | 100       |      |
| 151-30305         | <b>CTM010M4</b> |      |                  |            | .578"      | (14.68) | .375"     | (9.52) | .266"      | (6.76) | White  | 1000      |      |
| 151-30300         | <b>CTM00C2</b>  |      |                  |            | .578"      | (14.68) | .375"     | (9.52) | .266"      | (6.76) | Black  | 100       |      |
| 151-30301         | <b>CTM00M4</b>  |      |                  |            | .578"      | (14.68) | .375"     | (9.52) | .266"      | (6.76) | Black  | 1000      |      |
| 151-30404         | <b>CTM110C2</b> | CTM1 |                  | T18 - T120 | # 8 Screw  | .579"   | (14.71)   | .370"  | (9.40)     | .266"  | (6.76) | White     | 100  |
| 151-30406         | <b>CTM110M4</b> |      |                  |            |            | .579"   | (14.71)   | .370"  | (9.40)     | .266"  | (6.76) | White     | 1000 |
| 151-30400         | <b>CTM10C2</b>  |      |                  |            |            | .579"   | (14.71)   | .370"  | (9.40)     | .266"  | (6.76) | Black     | 100  |
| 151-30402         | <b>CTM10M4</b>  |      |                  |            |            | .579"   | (14.71)   | .370"  | (9.40)     | .266"  | (6.76) | Black     | 1000 |
| 151-30504         | <b>CTM210C2</b> | CTM2 | T18 - T120       |            | # 8 Screw  | .857"   | (21.77)   | .605"  | (15.37)    | .372"  | (9.45) | White     | 100  |
| 151-30506         | <b>CTM210M4</b> |      |                  |            |            | .857"   | (21.77)   | .605"  | (15.37)    | .372"  | (9.45) | White     | 1000 |
| 151-30500         | <b>CTM20C2</b>  |      |                  |            |            | .857"   | (21.77)   | .605"  | (15.37)    | .372"  | (9.45) | Black     | 100  |
| 151-30501         | <b>CTM20M4</b>  |      |                  |            |            | .857"   | (21.77)   | .605"  | (15.37)    | .372"  | (9.45) | Black     | 1000 |
| 151-30605         | <b>CTM310C2</b> | CTM3 |                  | T18 - T120 | #10 Screw  | .858"   | (21.79)   | .609"  | (15.47)    | .374"  | (9.50) | White     | 100  |
| 151-30607         | <b>CTM310M4</b> |      |                  |            |            | .858"   | (21.79)   | .609"  | (15.47)    | .374"  | (9.50) | White     | 1000 |
| 151-30600         | <b>CTM30C2</b>  |      |                  |            |            | .858"   | (21.79)   | .609"  | (15.47)    | .374"  | (9.50) | Black     | 100  |
| 151-30603         | <b>CTM30M4</b>  |      |                  |            |            | .858"   | (21.79)   | .609"  | (15.47)    | .374"  | (9.50) | Black     | 1000 |
| 151-30703         | <b>CTM410C2</b> | CTM4 | T18 - T120       |            | .25" Screw | .864"   | (21.95)   | .616"  | (15.65)    | .372"  | (9.45) | White     | 100  |
| 151-30705         | <b>CTM410M4</b> |      |                  |            |            | .864"   | (21.95)   | .616"  | (15.65)    | .372"  | (9.45) | White     | 1000 |
| 151-30700         | <b>CTM40C2</b>  |      |                  |            |            | .864"   | (21.95)   | .616"  | (15.65)    | .372"  | (9.45) | Black     | 100  |
| 151-30702         | <b>CTM40M4</b>  |      |                  |            |            | .864"   | (21.95)   | .616"  | (15.65)    | .372"  | (9.45) | Black     | 1000 |

Dimensions are approximate and subject to technical changes. Use **Part No.** for ordering and **Type** for specification purposes.