

## CTAM210C2

Cable Tie Anchor Mount .400"X.800" - PA66, White, T18-T50 Cable, Ties, #10 Screw, 100/pk

Article Number: 151-31203

Part Number: CTAM210C2

Type: CTAM2

Material: PA66



### 1. Base Data

---

<b>Part No.</b>	CTAM210C2
<b>Type</b>	CTAM2
<b>Color</b>	White
<b>Features</b>	T18 through T50 series cable ties may be inserted from any of the four sides of the CTAM.
<b>Application</b>	The mount may be placed either parallel or perpendicular to the wires.
<b>Application Method</b>	Secured with one #10 screw.

## 2. Product Dimensions

---

Length (L) .800 " / 20.32 mm

Width (W) .400 " / 10.16 mm

Max. Cable Tie Width 4.6

Height (H) .200 " / 5.08 mm

Height (H2) 1.78 mm

Mounting Hole Ø .20 " / 5.2

## 4. Material and Specifications

---

Material Polyamide 6.6 (PA66)

Material Shortcut PA66

Flammability UL94 V2

Operating Temperature -40 °F to +185 °F (-40 °C to +85 °C)  
continuous

ROHS Conformity 

## Logistic and Packaging

---

Packaging Type bag

Pkg. Qty. 100

Carton Qty. 15000

UPC 08930601174

**Miscellaneous**

---

**UL Recognized (US and Canada)** Yes

### Cable Tie Anchor Mounts

Cable ties may be inserted from any of the four sides of the CTAM. This feature allows the mount to be placed either parallel or perpendicular to the wires.

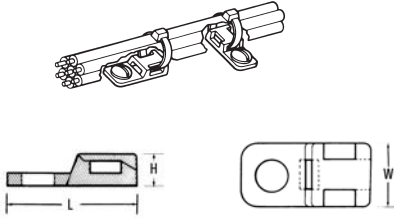

Material Data	
Material	<b>Polyamide 6.6 (PA66)</b>
Operating Temperature	<b>-40 °F to +185 °F</b> <b>(-40 °C to +85 °C) continuous</b>
Flammability	<b>UL94 V2</b>



Product Selection									
Article No.	Part No.	Type	Cable Tie Series	Mounting	Width (W)	Length (L)	Height (H)	Color	Pkg. Qty.
					in. (mm)	in. (mm)	in. (mm)		
151-31103	<b>CTAM110C2</b>	CTAM1	T18 - T50	#8 screw	.400" (10.16)	.800" (20.32)	.200" (5.08)	White	100
151-31106	<b>CTAM110M4</b>	CTAM1			.400" (10.16)	.800" (20.32)	.200" (5.08)	White	1000
151-31101	<b>CTAM10C2</b>	CTAM1			.400" (10.16)	.800" (20.32)	.200" (5.08)	Black	100
151-00287	<b>CTAM10M4</b>	CTAM1			.400" (10.16)	.800" (20.32)	.200" (5.08)	Black	1000
151-31203	<b>CTAM210C2</b>	CTAM2		#10 screw	.400" (10.16)	.800" (20.32)	.200" (5.08)	White	100
151-31205	<b>CTAM210M4</b>	CTAM2			.400" (10.16)	.800" (20.32)	.200" (5.08)	White	1000
151-31201	<b>CTAM20C2</b>	CTAM2			.400" (10.16)	.800" (20.32)	.200" (5.08)	Black	100
151-31202	<b>CTAM20M4</b>	CTAM2			.400" (10.16)	.800" (20.32)	.200" (5.08)	Black	1000

Dimensions are approximate and subject to technical changes. Use **Part No.** for ordering and **Type** for specification purposes.

### Cable Tie Anchor Plates

These plates have slotted mounting holes to provide for easier alignment of mount and bundles. Once aligned, they are fastened securely by tightening the applied screw. The CTAP2 allows an additional screw for maximum stability. Both plates are used perpendicularly to the wire bundle.

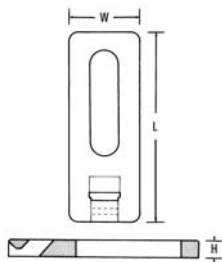

Material Data	
Material	<b>Polyamide 6.6 (PA66)</b>
Operating Temperature	<b>-40 °F to +185 °F</b> <b>(-40 °C to +85 °C) continuous</b>
Flammability	<b>UL94 V2</b>



Product Selection									
Article No.	Part No.	Type	Cable Tie Series	Mounting	Width (W)	Length (L)	Height (H)	Color	Pkg. Qty.
					in. (mm)	in. (mm)	in. (mm)		
151-30100	<b>CTAP110C2</b>	CTAP1	T18 - T50	#10 screw	.50" (12.7)	1.34" (34.04)	.15" (3.81)	White	100
151-00288	<b>CTAP110M4</b>	CTAP1			.50" (12.7)	1.34" (34.04)	.15" (3.81)	White	1000
151-00289	<b>CTAP10C2</b>	CTAP1			.50" (12.7)	1.34" (34.04)	.15" (3.81)	Black	100
151-00290	<b>CTAP10M4</b>	CTAP1			.50" (12.7)	1.34" (34.04)	.15" (3.81)	Black	1000
151-30200	<b>CTAP210C2</b>	CTAP2			.50" (12.7)	2.13" (54.1)	.14" (3.5)	White	100
151-00308	<b>CTAP210H4</b>	CTAP2			.50" (12.7)	2.13" (54.1)	.14" (3.5)	White	500
151-00291	<b>CTAP20C2</b>	CTAP2			.50" (12.7)	2.13" (54.1)	.14" (3.5)	Black	100
151-00292	<b>CTAP20M4</b>	CTAP2			.50" (12.7)	2.13" (54.1)	.14" (3.5)	Black	500

Dimensions are approximate and subject to technical changes. Use **Part No.** for ordering and **Type** for specification purposes.