

80 x 38 mm (3.1" X 1.5") Brushless DC

8100 Series

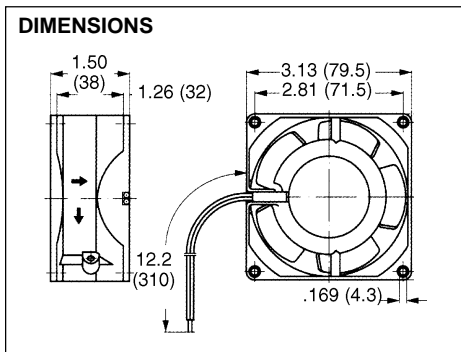
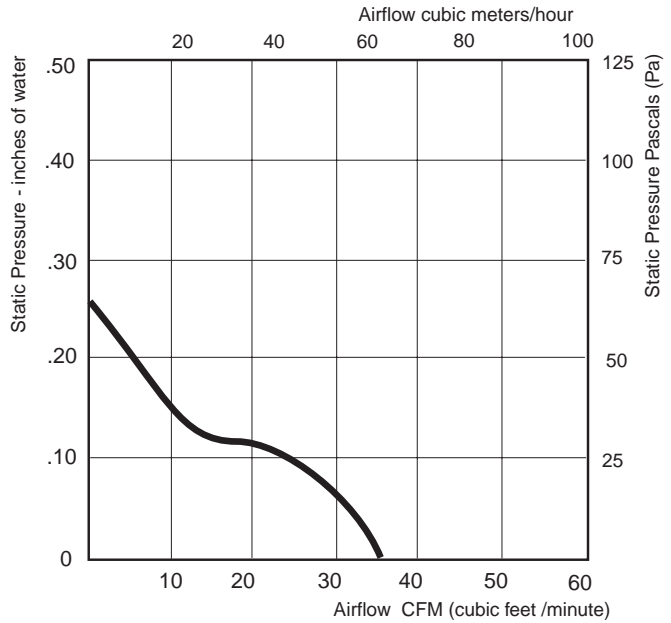

HIGH PERFORMANCE
SINTEC
SLEEVE BEARING SYSTEM

3.13" X 3.13" X 1.50" Brushless DC, All Metal, Air Exhaust – Over Struts

PART NUMBER	Type of Bearing	DC Volts	Voltage Range	Watts	CFM @ 0"	Temp. dBA	Wgt. Max °C	Wgt. (oz)	Features	Approvals*		
										UL	CSA	VDE
8105G	Sleeve	5	4.5 - 5.5	3	35	38	72	15	22 AWG 12.2" Leads	-	-	-
8112G	Sleeve	12	8 - 16	3	35	38	72	15	22 AWG 12.2" Leads	✓	✓	✓
8112K	Ball	12	8 - 16	3	35	39	72	15	22 AWG 12.2" Leads	✓	✓	✓
8124G	Sleeve	24	18 - 30	3	35	38	72	15	22 AWG 12.2" Leads	✓	✓	✓
8124K	Ball	24	18 - 30	3	35	39	72	15	22 AWG 12.2" Leads	✓	✓	✓
8148	Ball	48	38 - 56	3	35	39	72	15	22 AWG 12.2" Leads	✓	✓	✓

* UL yellow card E38324, CSA file 27697, VDE file 3041

CONSTRUCTION MOUNTING & CONNECTION	Mounting:	From either face using four .169" (4.3 mm) holes	Connection:	Lead wires color coded, red (+), black/blue (-)
	Weight:	15 ounces (425g)	Options:	Hall Effect monitor
	Housing:	Metal with metal impeller		