

Type MPF AC Motor Run Capacitors

Round and Flat Oval, Oil Filled, 70 °C, Metallized Polypropylene Capacitors



Type MPF AC metallized polypropylene film dielectric capacitors offer a reliable option for alternating current applications. All devices are oil filled in metal cases with 4-prong quick disconnect terminals for easy assembly. These capacitors pack high capacitance and voltage capabilities into a small, light-weight package. The MPF is internally protected for fail-safe operation. These capacitors have extremely low DF that is ideal for AC motor-run applications.

Highlights

- Low DF
- Protected with a pressure sensitive interrupter
- Small size and light weight
- UL E233394
- CSA 219950
- Air conditioning and refrigeration applications
- Power factor correction
- Motors

Specifications

Capacitance Range:	1 to 80 μ F
Voltage Ratings:	330 Vac, 370 Vac, 440 Vac
Capacitance Tolerance:	$\pm 10\%$
Operating Temperature Range:	-40 °C to +70 °C
Operating Frequency:	50 to 60 Hz
Dissipation Factor:	0.1% max @ 60 Hz

Outline Drawings

Flat Oval					
Style	A	B	H	D	Industry Type
32	1 5/16	2 5/32	*	13/16	1 1/4 F.O.
37	1 19/32	2 29/32	*	13/16	1 3/4 F.O.
38	1 19/32	3 19/32	*	13/16	2 F.O.

*See Ratings Table for "H" dimension

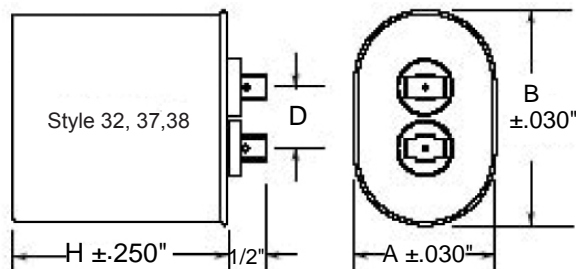

Round					
Style	A	B	H	D	Industry Type
21	1 3/4	1 7/8	*	13/16	1 3/4" Round
23	2	2 1/2	*	13/16	2" Round
24	2 1/2	2 5/8	*	13/16	2 1/2" Round

*See Ratings Table for "H" dimension

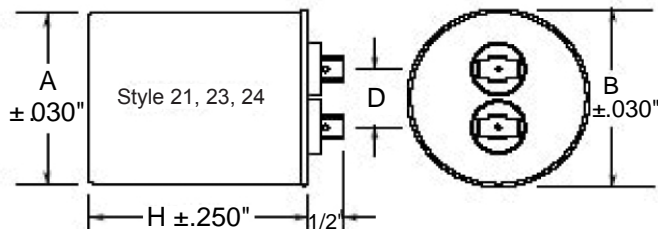

21** Style round units are 3-prong

Type MPF AC Motor Run Capacitors

Ratings

Flat Oval Single

Cap (µF)	Voltage (Vac)	Base Style	Height (Inches)	Catalog Part Number
370 Vac				
1.0	370	32	2.13	32FD3701
2.0	370	32	2.13	32FD3702
3.0	370	32	2.13	32FD3703
4.0	370	32	2.13	32FD3704
5.0	370	32	2.38	32FD3705
6.0	370	32	2.38	32FD3706
7.5	370	32	2.38	32FD37075
10.0	370	32	2.63	32FD3710
12.5	370	32	3.00	32FD37125
12.5	370	37	2.63	37FD37125
15.0	370	37	2.63	37FD3715
17.5	370	37	2.63	37FD37175
20.0	370	37	2.63	37FD3720
22.5	370	37	2.63	37FD37225
25.0	370	37	2.63	37FD3725
27.5	370	38	3.00	38FD37275
30.0	370	37	3.00	37FD3730
30.0	370	38	3.00	38FD3730
35.0	370	37	3.75	37FD3735
35.0	370	38	3.00	38FD3735
40.0	370	37	3.75	37FD3740
40.0	370	38	3.00	38FD3740
45.0	370	37	3.75	37FD3745
45.0	370	38	3.00	38FD3745
50.0	370	38	3.00	38FD3750
70.0	370	38	3.75	38FD3770
440 Vac				
1.0	440	32	2.13	32FB4401
2.0	440	32	2.13	32FB4402
3.0	440	32	2.38	32FB4403
4.0	440	32	2.38	32FB4404
5.0	440	32	2.63	32FB4405
6.0	440	32	2.63	32FB4406
7.5	440	32	2.63	32FB44075
7.5	440	37	2.63	37FB44075
10.0	440	32	3.75	32FB4410
10.0	440	37	2.63	37FB4410
12.5	440	37	2.63	37FB44125
15.0	440	37	2.63	37FB4415
17.5	440	37	2.63	37FB44175
20.0	440	37	3.00	37FB4420
20.0	440	38	3.00	38FB4420
25.0	440	37	3.75	37FB4425
25.0	440	38	3.75	38FB4425
30.0	440	38	3.75	38FB4430
35.0	440	37	4.75	37FB4435
35.0	440	38	3.75	38FB4435
40.0	440	37	4.75	37FB4440
40.0	440	38	3.75	38FB4440
45.0	440	38	3.75	38FB4445
50.0	440	38	3.75	38FB4450
55.0	440	38	4.75	38FB4455
60	440	38	4.75	38FB4460

Flat Oval Dual

Cap (µF)	Voltage (Vac)	Base Style	Height (Inches)	Catalog Part Number
370 Vac				
15+4	370	37	2.63	37FD371504
15+5	370	37	2.63	37FD371505
15+10	370	37	2.63	37FD371510
20+5	370	37	2.63	37FD372005
20+15	370	38	2.63	38FD372015
25+5	370	38	2.63	38FD372505
30+5	370	38	3.00	38FD373005
35+3	370	38	3.00	38FD373503
35+4	370	38	3.00	38FD373504
35+5	370	38	3.00	38FD373505
40+5	370	38	3.75	38FD374005
40+7.5	370	38	3.75	38FD3740075
45+5	370	38	3.75	38FD374505
45+7.5	370	38	3.75	38FD3745075
45+10	370	38	3.75	38FD374510
440 Vac				
25+5	440	37	3.00	37FB442505
30+5	440	38	3.75	38FB443005
35+5	440	38	3.75	38FB443505

Round

Cap (µF)	Voltage (Vac)	Base Style	Height (Inches)	Catalog Part Number
330 Vac				
3.0	330	23	2.63	23FD3303
4.0	330	23	2.63	23FD3304
5.0	330	23	2.63	23FD3305
6.0	330	23	2.63	23FD3306
7.0	330	23	2.63	23FD3307
8.0	330	23	2.63	23FD3308
10.0	330	23	2.63	23FD3310
370 Vac				
3.0	370	21	2.63	21FD3703
4.0	370	21	2.63	21FD3704
5.0	370	21	2.63	21FD3705
6.0	370	21	2.63	21FD3706
7.0	370	21	2.63	21FD3707
8.0	370	21	2.63	21FD3708
10.0	370	21	2.63	21FD3710
12.5	370	21	2.63	21FD37125
15.0	370	21	2.63	21FD3715
17.5	370	21	2.63	21FD37175
20	370	21	2.63	21FD3720
25	370	21	3.00	21FD3725
25	370	23	3.00	23FD3725
30	370	21	3.00	21FD3730
30	370	23	3.00	23FD3730
35	370	21	3.75	21FD3735
35	370	23	3.00	23FD3735
40	370	21	3.75	21FD3740
40	370	23	3.00	23FD3740
45	370	23	3.75	23FD3745
45	370	24	3.00	24FD3745
50	370	23	3.75	23FD3750
50	370	24	3.00	24FD3750
55	370	23	3.75	23FD3755
55	370	24	3.00	24FD3755
60	370	23	3.75	23FD3760
60	370	24	3.00	24FD3760
65	370	24	3.75	24FD3765
70	370	24	3.75	24FD3770
80	370	24	4.75	24FD3780
440 Vac				
15	440	21	2.63	21FB4415
20	440	21	3.00	21FB4420
20	440	23	3.00	23FB4420
22.5	440	21	3.00	21FB44225
22.5	440	23	3.00	23FB44225
25	440	21	3.75	21FB4425
25	440	23	3.00	23FB4425
30	440	23	3.75	23FB4430
30	440	24	3.00	24FB4430
35	440	23	3.75	23FB4435
35	440	24	3.00	24FB4435
40	440	23	3.75	23FB4440
40	440	24	3.75	24FB4440
45	440	24	3.75	24FB4445
50	440	24	3.75	24FB4450
55	440	24	3.75	24FB4455
60	440	24	4.75	24FB4460
70	440	24	4.75	24FB4470

Type MPF AC Motor Run Capacitors

Oval Capacitor Hardware

Mounting Brackets #32107

Case Code	Bracket
A	32107-1
C	32107-2
D	32107-3

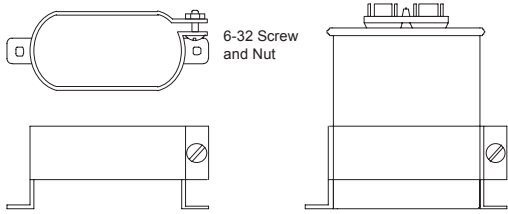

Insulating Terminal Boots UL 465 Listed

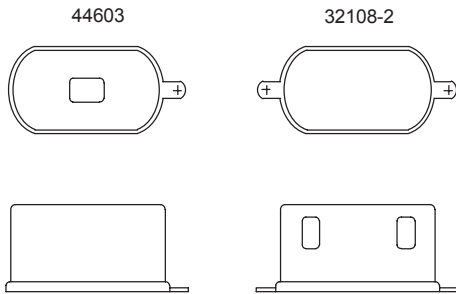

Round Capacitor Hardware

3 Footed Round Mounting Bracket

Case Code	Bracket
P	VR6B
S	VR8B
T	VR10B

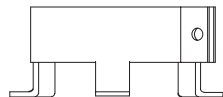
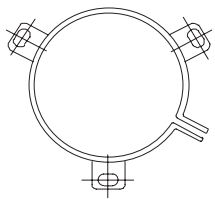

2 Footed Round Mounting Bracket

Case Code	Bracket
P	32107-6
S	32107-7
T	32107-8

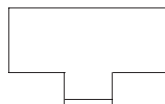
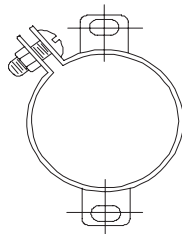

Wrap Around Bracket

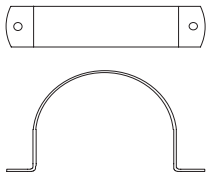

Case Code	Bracket
P	RB175
S	RB200
T	RB250

End Mount Footed Bracket (2 required) #30434



Side Mount Footed Bracket (2 required) #31762

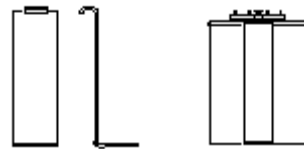

Wrap Around Bracket #30393

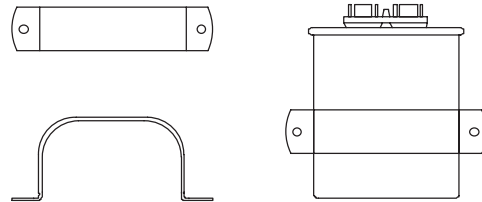

H (Inches)	End Mount	Side Mount
2.13	30434-33	31762-45
2.38	30434-37	31762-46
2.63	30434-41	31762-47
2.88	30434-45	31762-48
3.13	30434-49	31762-49
3.50	30434-55	31762-50
3.75	30434-59	31762-83
3.88	30434-61	31762-51
4.25	30434-67	31762-52
4.75	30434-75	31762-54
5.13	30434-81	31762-132
5.25	30434-83	31762-55
5.75	30434-91	31762-56
6.25	30434-99	31762-59
6.75	30434-107	31762-60
7.25	30434-115	31762-62
8.00	30434-127	31762-63
9.00	30434-143	31762-78

Case Code	Bracket
A	30393-5
C	30393-9
D	30393-10

Motor Start Mounting Hardware

Bracket



End Cap

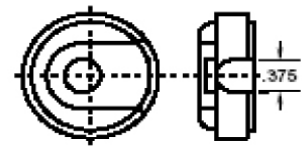

Case Code	Case Dimensions (Inches)		Down Wire Cap	Up Wire Cap	Optional Mounting Bracket
	D	L			
1	1.438	2.750	PL3	PLA3	HB2
2	1.438	3.375	PL3	PLA3	HB4
3	1.438	4.375	PL3	PLA3	HB8
4	1.813	3.375	PL6	PLA6	HB4
5	1.813	4.375	PL6	PLA6	HB8
6	2.063	3.375	PL8	PLA8	HB4
7	2.063	4.375	PL8	PLA8	HB8
8	2.563	4.375	PL10	PLA10	HB8

Order both endcap and bracket for mounting