

TECHNICAL DATA

'' D '' SUBMINIATURE CONNECTORS

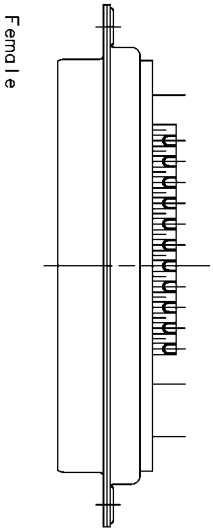
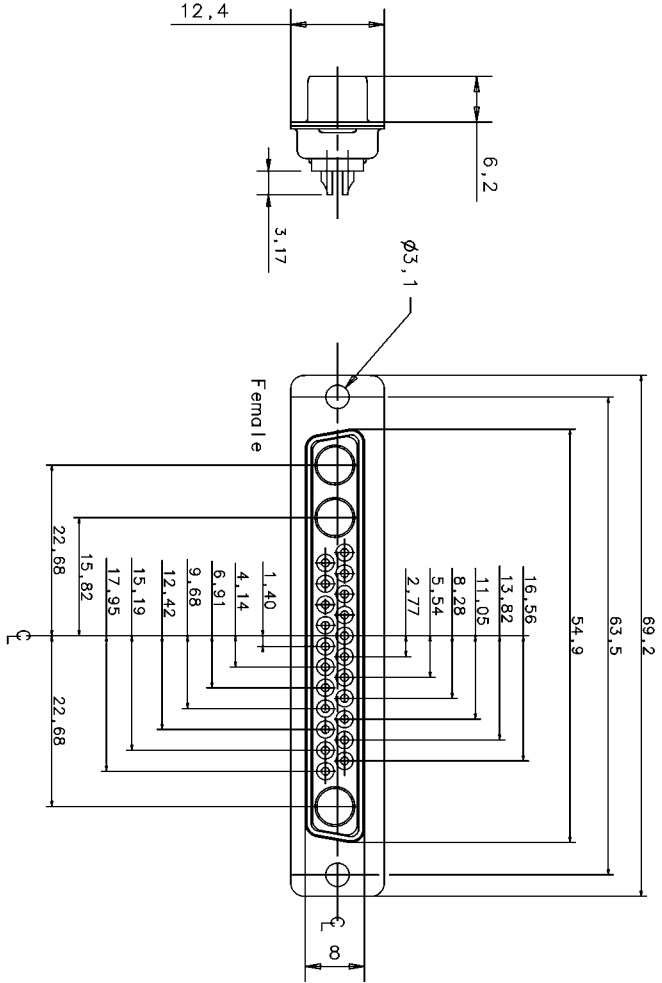
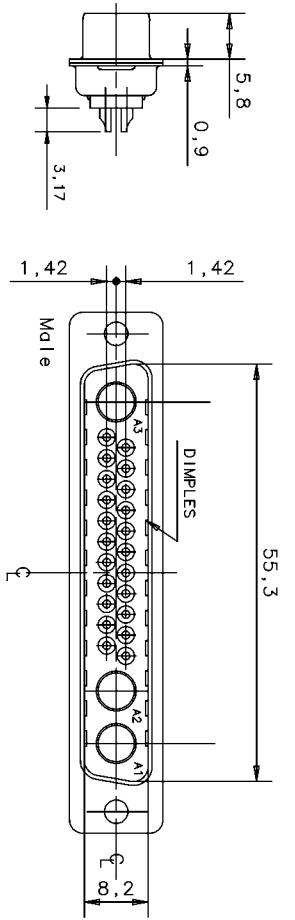

17TW
DATE DU TIRAGE

N ETUDE N OUTIL N CLIENT

SHELL : Steel
finish : tinned

BODY : Glass filled thermoplastic
Flame retardant to UL 94 V-0
(resist to short term temperature 260°C)
Colour : black .

CONTACTS : Material for sockets : bronze
Material for pins brass
Finish of contact mating area :
15 um Inch. (0,4 um) Gold over Nickel

ELECTRICAL : Voltage rating 300 V Rms to 50Hz .
Nominal current 7,5 A (size 20) 40 A (size 8)
Withstanding Voltage >1000 V Rms to 50 Hz
Contact resistance <5m Ohms .
Insulator resistance >5000 M Ohms.

CLIMATIC : Temperature range -55°C up to +155°C
Damp heat 56 days (40°C - 95 % HR)
Other climatic specifications in accordance
with NF C 93-425, sheet HE507

MECHANICAL : Insertion force per contact 1,2N < F <2,5 N (size 20)
Extraction force per contact 0,4 N mini (size 20)
Mating and unmating force size C 150 N maxi 11 N mini

MARKING : Amphenol -(serie number)
Commercial reference
Manufacturing date

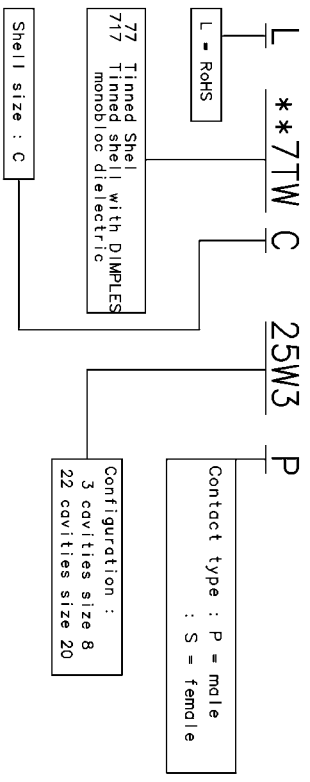

Amphenol Socapex		USINE DE DOLE	
Usine de Dole		PLAN NOTICE	
Creation plan	25/01/06	Version	1.5
IND. / MODIFICATION DATE	Emmanuel	DESIGNATION	** 7TW C 25W3 *
N SERIE	017F	DOSSIER	notice TW

COMMUNICATION ET UTILISATION INTERITES SAUF AUTORISATION